

4

3

2

1

NOTES:

(NI) 1. FIT / FORM / FUNCTION SHALL FOLLOW PS-E.008.

BILL OF MATERIAL (CURRENT LEVEL)

ITEM	PT/ASSY	DESCRIPTION	TYPE	QTY.
1	3-354	WIDESPREAD SPOUT ASSEMBLY	ASSEMBLY	1
2	10288	3/16" POP UP ROD	PART	1
3	10010	POP-UP KNOB	PART	1
4	325	POP UP ASSEMBLY	ASSEMBLY	1
5	3-156	TRIM KIT - STOP VALVE	ASSEMBLY	2
6	1-525-800	W/S VALVE ASM	ASSEMBLY	1

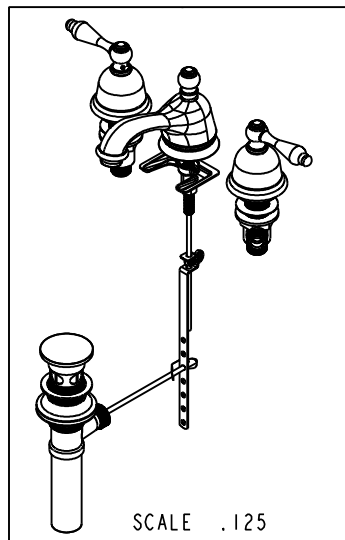
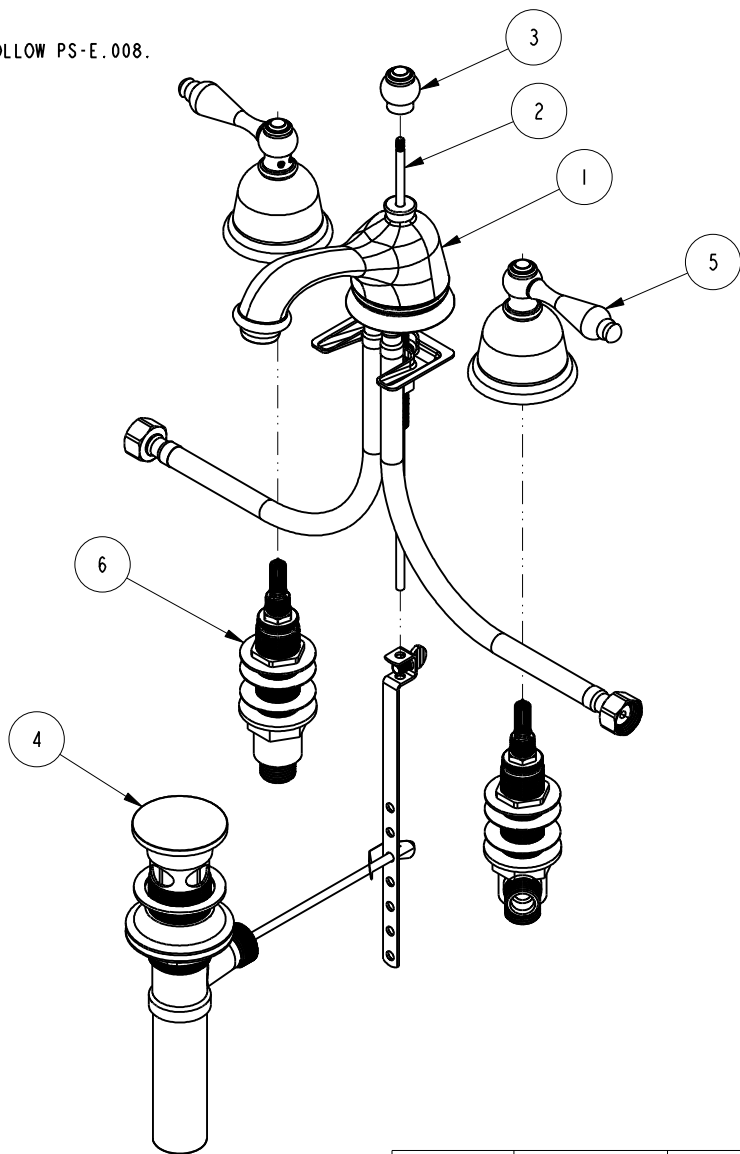

-	D	EN-3371	08/04/17	J.M
-	C	EN-2553	07/01/13	-
-	B	EN-1616	09/13/10	-
-	A	EO-1019	06/10/08	-
-	-	RELEASED	PRE '95	-
ZONE	REV	DESCRIPTION	DATE	APPROVED

COPYRIGHT 2005 BRASSTECH, INC. THESE DRAWINGS AND THE DESIGNS DEPICTED HEREIN ARE THE PROPRIETARY PROPERTY OF BRASSTECH. ANY USE OR REPRODUCTION IS SUBJECT TO THE EXPRESS APPROVAL OF BRASSTECH. UNAUTHORIZED USE IS STRICTLY PROHIBITED. ALL RIGHTS RESERVED.

TESTING	-	-	-
ASSEMBLY	-	-	-
PLATING	-	-	-
POLISHING	-	-	-
MACHINING	-	-	-
TOOLING FIXTURE #			
		REMOVE ALL BURRS AND SHARP EDGES	

UNITS ARE: INCHES [MM]	
TOLERANCES ARE:	
FRACTIONS DECIMALS	ANGLES
±1/16"	±1°
.X ±.1 [2,5]	
.XX ±.06 [1,3]	
(X.XXX) DENOTES CRITICAL DIMS. ALL THREADS ARE CRITICAL	
DRAWN	VINAY 08/04/17
CHECKED	RAVINDRA 08/04/17
APPROVED	J.M 08/04/17

BRASSTECH 2001 CARNEGIE AVE. SANTA ANA, CA 92705 (949) 417-5207
INCORPORATED

WIDESPREAD FAUCET

DWG NO.	800	REV	D
SCALE	.225	REF.	-
SHEET	1	OF	2

4

3

2

1

