

NOTES:

1. TO INSPECT ASSEMBLY, FOLLOW FIRST ARTICLE AND IN PROCESS INSPECTION SHEET.

BILL OF MATERIAL (CURRENT LEVEL)

ITEM	PT/ASSY	DESCRIPTION	TYPE	QTY.
1	1-525.1020	W/S VALVE ASM	ASSEMBLY	1
2	3-347	W/S SPOUT ASM	ASSEMBLY	1
3	3-188C	HANDLE ASM COLD	ASSEMBLY	1
4	3-188H	HANDLE ASM - HOT	ASSEMBLY	1
5	10021	POP-UP KNOB	PART	1
6	10288	3/16" POP UP ROD	PART	1
7	325	POP UP ASSEMBLY	ASSEMBLY	1
8	98037_375_NIPPLE	STICKER LABEL A112.18.1	PART	1

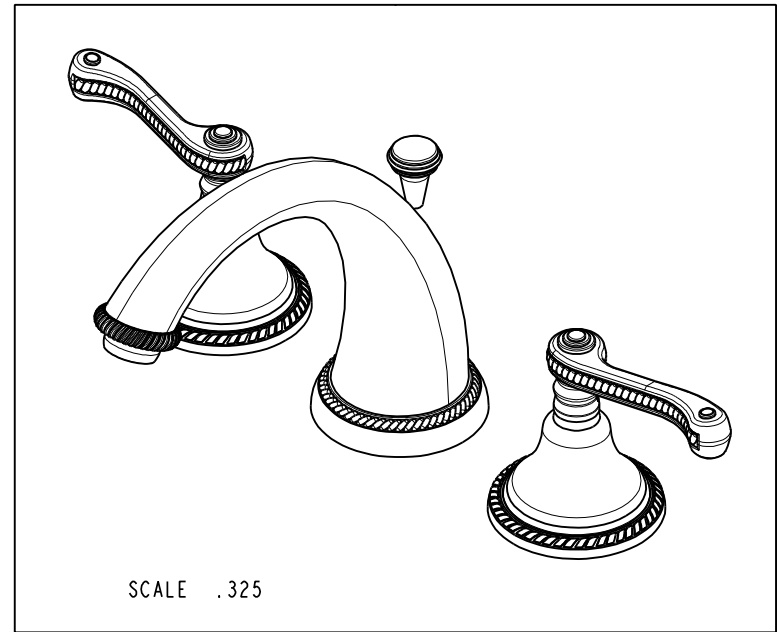
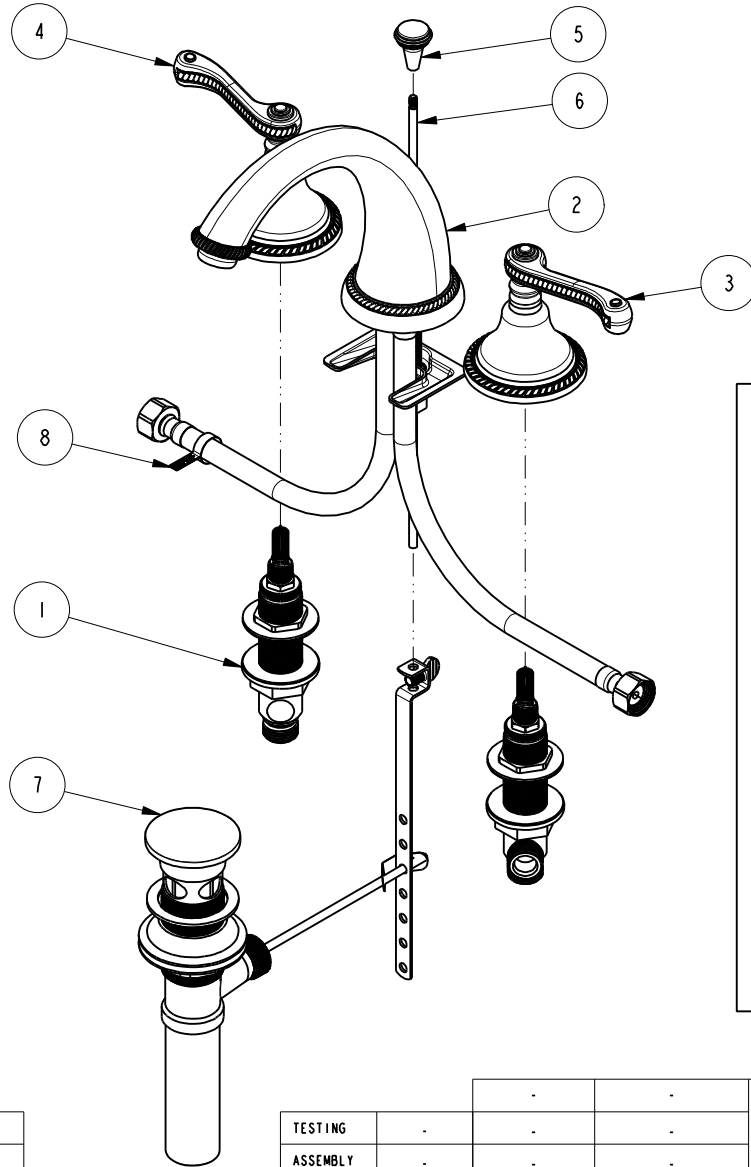

ZONE	REV	DESCRIPTION	DATE	APPROVED
-	D	EN-4300m	10/21/20	R.S.
-	C	EN-3371	08/04/17	J.M
-	B	EN-1616	09/13/10	-
-	A	EN-1018	06/10/08	-
-	-	RELEASE	2000	-

COPYRIGHT 2005 BRASSTECH, INC. THESE DRAWINGS AND THE DESIGNS DEPICTED HEREIN ARE THE PROPRIETARY PROPERTY OF BRASSTECH. ANY USE OR REPRODUCTION IS SUBJECT TO THE EXPRESS APPROVAL OF BRASSTECH. UNAUTHORIZED USE IS STRICTLY PROHIBITED. ALL RIGHTS RESERVED.

TESTING	ASSEMBLY	PLATING	POLISHING	MACHINING	TOOLING FIXTURE #	APPLICATION
-	-	-	-	-	-	REMOVE ALL BURRS AND SHARP EDGES

UNITS ARE: INCHES [MM]		
TOLERANCES ARE:		
FRACTIONS	DECIMALS	ANGLES
±1/16"	.X ±.1 [2.5]	±1°
	.XX ±.06 [1.5]	
(X.XXX) DENOTES CRITICAL DIMS.		
ALL THREADS ARE CRITICAL		
DRAWN	JINSON	10/21/20
CHECKED	R.S.	10/21/20
APPROVED	R.S.	10/21/20

BRASSTECH 2001 CARNEGIE AVE.
INCORPORATED SANTA ANA, CA 92705
(949) 417-5207

WIDESPREAD FAUCET

DWG NO.	1020	REV	D
SCALE	.225	REF.	-
SHEET	1	OF	2

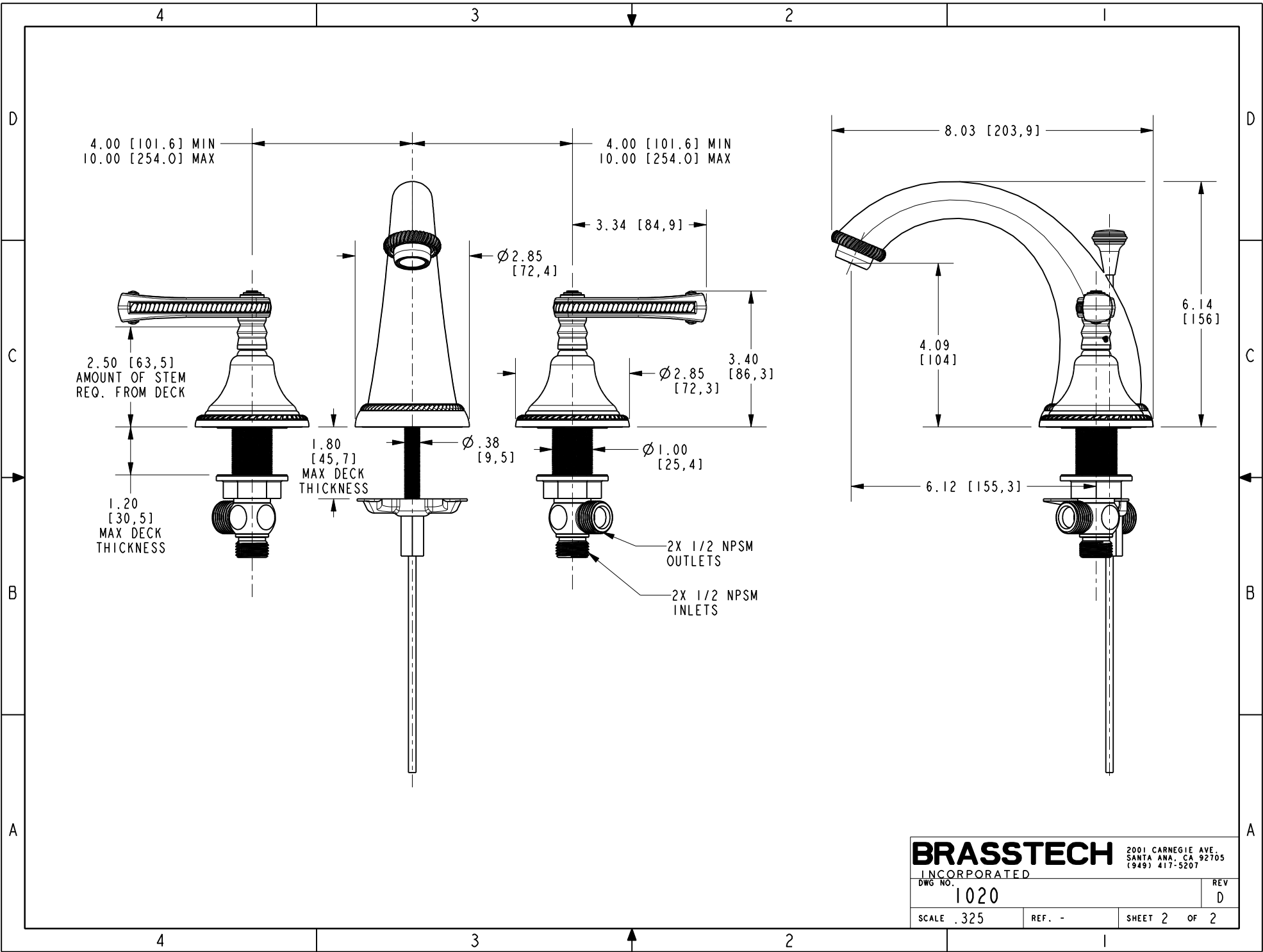

BRASSTECH
INCORPORATED
2001 CARNEGIE AVE.
SANTA ANA, CA 92705
(949) 417-5207

DWG NO. 1020	REV D
SCALE .325	REF. -
SHEET 2 OF 2	