

BILL OF MATERIAL (CURRENT LEVEL)

| ITEM | PT/ASSY | DESCRIPTION           | TYPE     | QTY. |
|------|---------|-----------------------|----------|------|
| 1    | 1-211   | ACCESSORY MTG KIT     | ASSEMBLY | 1    |
| 2    | 10016   | ESCUTCHEON BELL       | PART     | 1    |
| 3    | 10287   | TOWEL RING POST       | PART     | 1    |
| 4    | 10127   | TOWEL RING            | PART     | 1    |
| 5    | 92000   | SCREW 8 - 32 X 1/8 SS | PART     | 1    |
| 6    | 1-125   | HARDWARE KIT          | ASSEMBLY | 1    |

COPYRIGHT 2005 BRASSTECH, INC. THESE DRAWINGS AND THE DESIGNS DEPICTED HEREIN ARE THE PROPRIETARY PROPERTY OF BRASSTECH. ANY USE OR REPRODUCTION IS SUBJECT TO THE EXPRESS APPROVAL OF BRASSTECH. UNAUTHORIZED USE IS STRICTLY PROHIBITED. ALL RIGHTS RESERVED.

**BRASSTECH**  
INCORPORATED  
2001 E. CARNEGIE AVE.  
SANTA ANA, CA 92705  
(949) 417-5207

TOWEL RING

|            |        |              |          |               |
|------------|--------|--------------|----------|---------------|
| ASSY. NO.  | 12-09  | -            | EN-1241A | 09/15/09      |
| SCALE .375 | REF. - | SHEET 1 OF 2 | REV      | REV DESC DATE |

# SPECIFICATION DWG

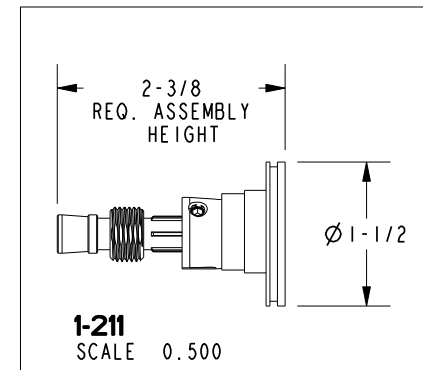
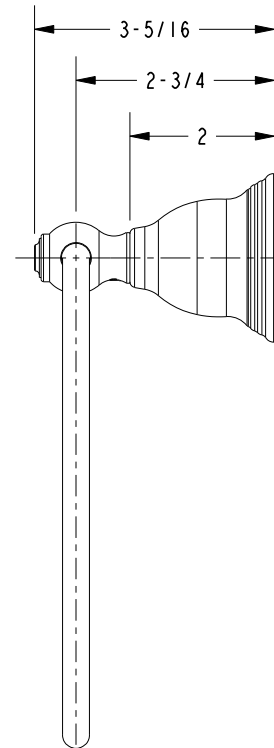
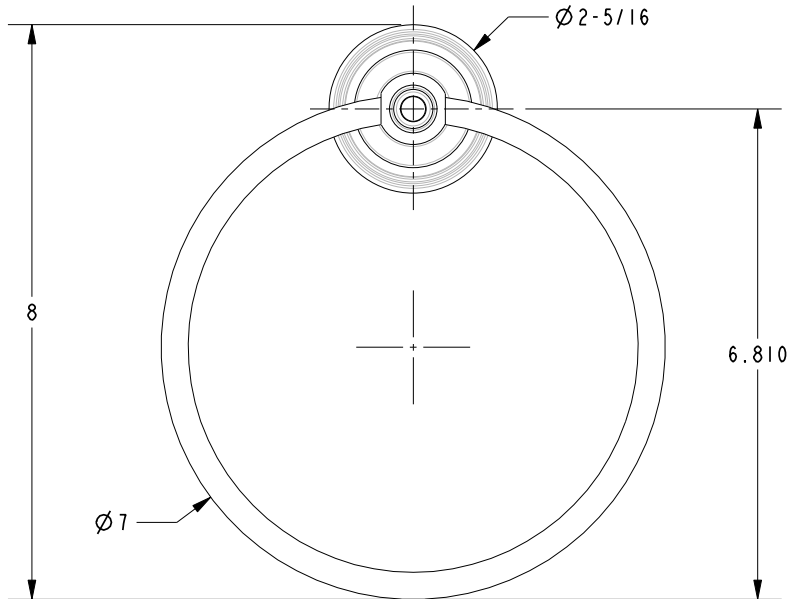
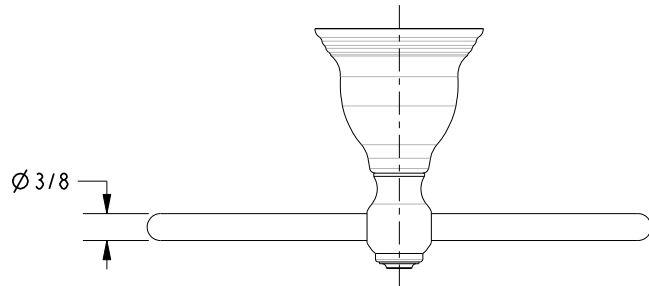

DIMENSIONS ARE IN INCHES AND AN APPROXIMATION OF A TYPICAL INSTALLATION

COPYRIGHT 2005 BRASSTECH, INC. THESE DRAWINGS AND THE DESIGNS DEPICTED HEREIN ARE THE PROPRIETARY PROPERTY OF BRASSTECH. ANY USE OR REPRODUCTION IS SUBJECT TO THE EXPRESS APPROVAL OF BRASSTECH. UNAUTHORIZED USE IS STRICTLY PROHIBITED. ALL RIGHTS RESERVED.

|                                  |        |  |
|----------------------------------|--------|--|
| <b>BRASSTECH</b><br>INCORPORATED |        | 2001 E. CARNEGIE AVE.<br>SANTA ANA, CA 92705<br>(949) 417-5207 |
| DWG NO.                          | 12-09  | REV<br>A   |
| SCALE .375                       | REF. - | SHEET 2 OF 2   |