

NOTES:

1. TO INSPECT ASSEMBLY, FOLLOW FIRST ARTICLE AND IN PROCESS INSPECTION SHEET.

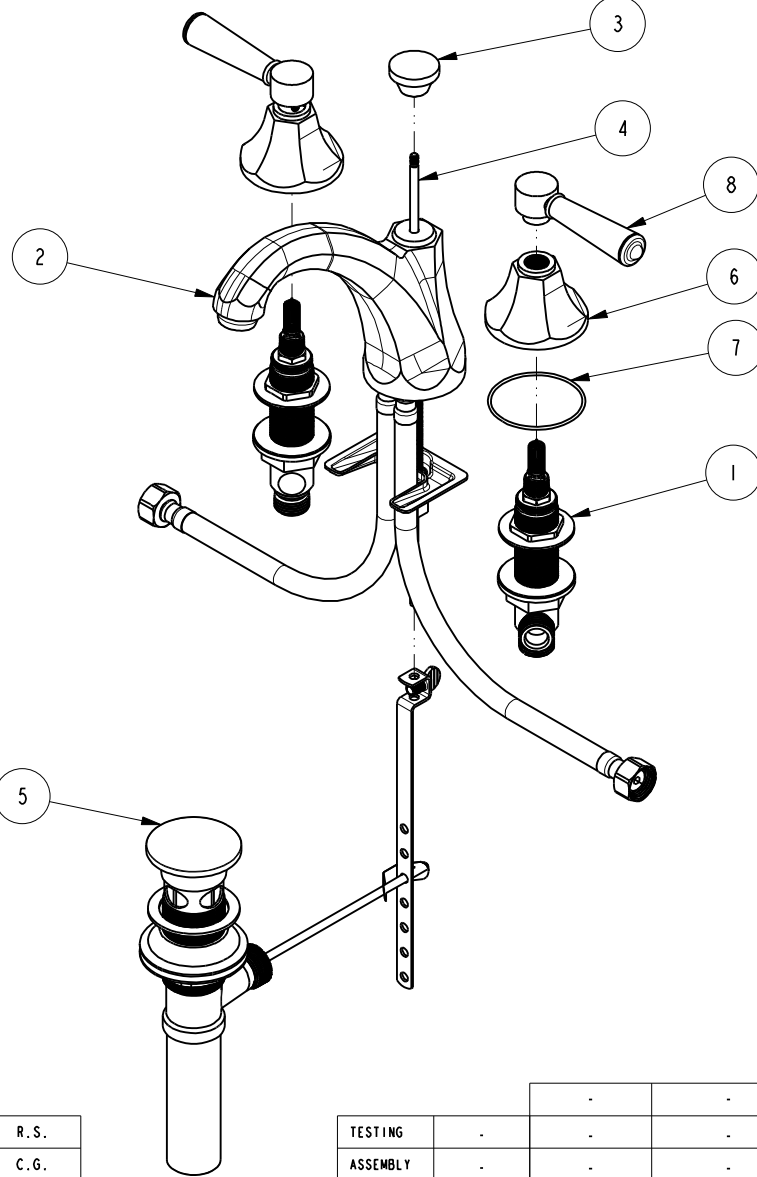

BILL OF MATERIAL (CURRENT LEVEL)

ITEM	PT/ASSY	DESCRIPTION	TYPE	QTY.
1	1-525	W/S VALVE ASM	ASSEMBLY	1
2	3-539	SPOUT ASM	ASSEMBLY	1
3	10961	SMOOTH POP - UP KNOB	PART	1
4	10288	3/16" POP UP ROD	PART	1
5	325	POP UP ASSEMBLY	ASSEMBLY	1
6	10960	HEX ESCUTCHEON	PART	2
7	91754	O-RING, #2-034, EPDM, 50 DURO - GREY	PART	2
8	2-279	TAPERED LEVER HNDL ASM	ASSEMBLY	2

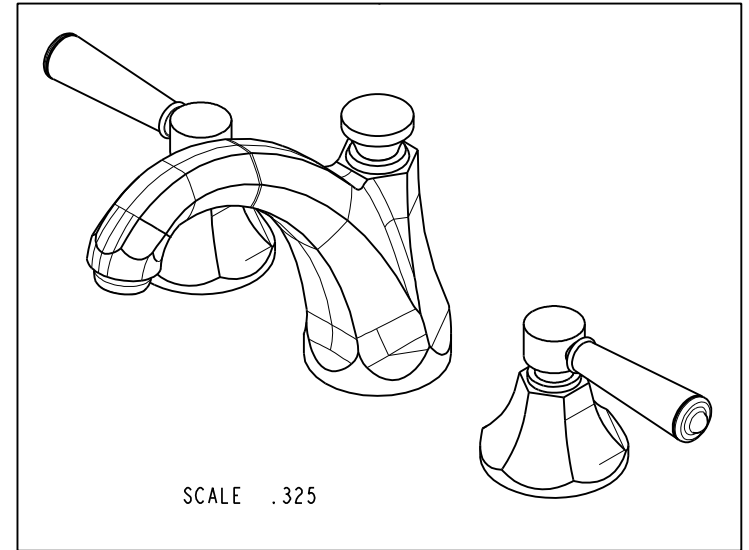

ZONE	REV	DESCRIPTION	DATE	APPROVED
-	D	EN-4300m	10/29/20	R.S.
-	C	EN-3722	02/08/19	C.G.
-	B	EN-3371	08/04/17	J.M.
-	A	EN-2832	11/06/14	-
-	-	EN-2781	08/18/14	-

COPYRIGHT 2005 BRASSTECH, INC. THESE DRAWINGS AND THE DESIGNS DEPICTED HEREIN ARE THE PROPRIETARY PROPERTY OF BRASSTECH. ANY USE OR REPRODUCTION IS SUBJECT TO THE EXPRESS APPROVAL OF BRASSTECH. UNAUTHORIZED USE IS STRICTLY PROHIBITED. ALL RIGHTS RESERVED.

TESTING	ASSEMBLY	PLATING	POLISHING	MACHINING	TOOLING FIXTURE #	APPLICATION
-	-	-	-	-		REMOVE ALL BURRS AND SHARP EDGES

UNITS ARE: INCHES [MM]		
TOLERANCES ARE:		
FRACTIONS	DECIMALS	ANGLES
±1/16"	.X ±.1 [2.5]	±1°
	.XX ±.06 [1.5]	
ⓧ.XXX DENOTES CRITICAL DIMS.		
ALL THREADS ARE CRITICAL		
DRAWN	JINSON	10/29/20
CHECKED	R.S.	10/29/20
APPROVED	R.S.	10/29/20

BRASSTECH 2001 CARNEGIE AVE.
INCORPORATED SANTA ANA, CA 92705
(949) 417-5207

WIDESPREAD FAUCET

DWG NO.	REV
1200C	D
SCALE .225	REF. -
SHEET 1	OF 2

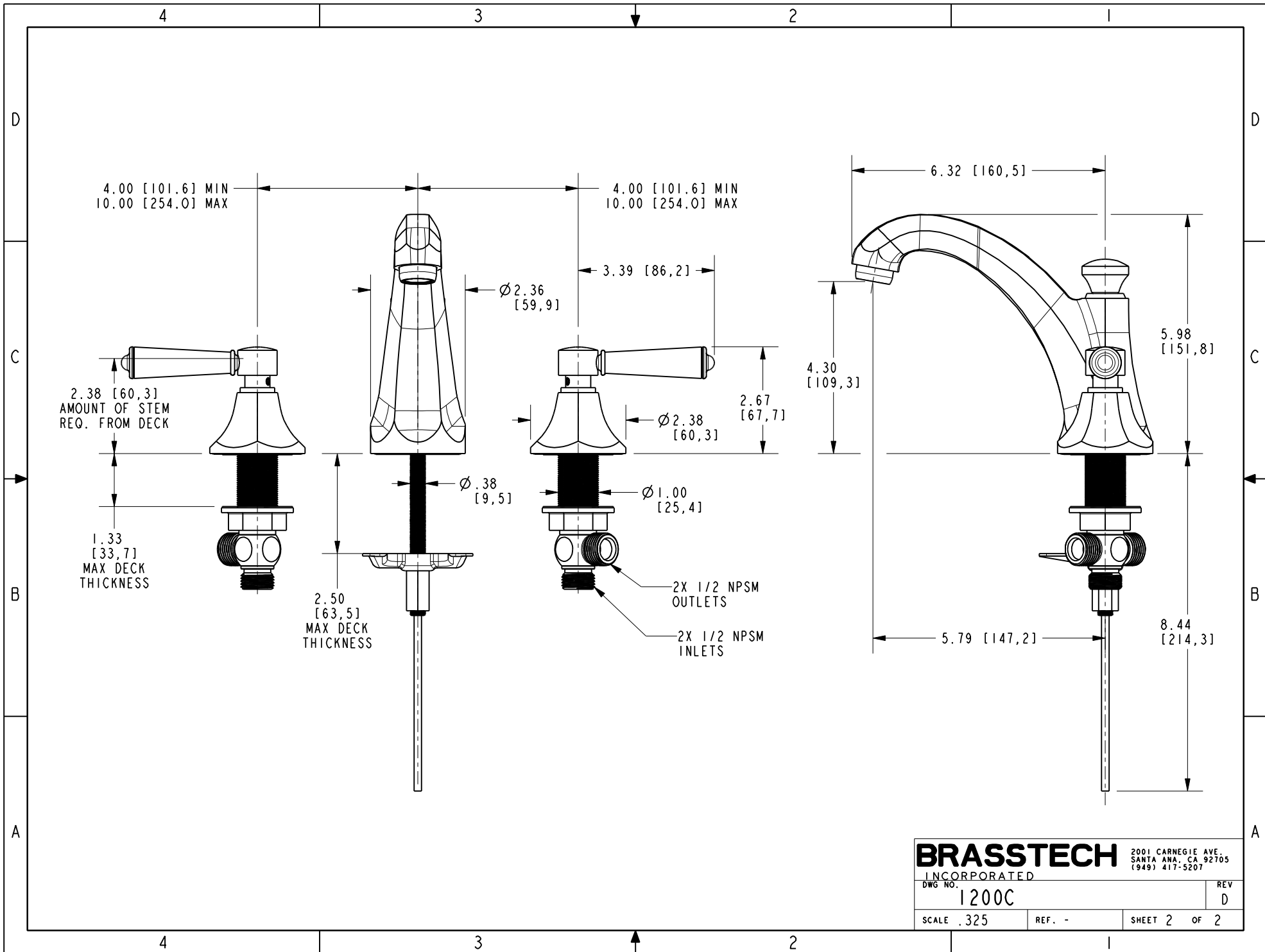

BRASSTECH
 INCORPORATED
 2001 CARNEGIE AVE.
 SANTA ANA, CA 92705
 (949) 417-5207

DWG NO. 1200C	REV D
SCALE .325	REF. -
SHEET 2 OF 2	