

**BILL OF MATERIAL (CURRENT LEVEL)**

| ITEM | PT/ASSY          | DESCRIPTION                      | TYPE     | QTY. |
|------|------------------|----------------------------------|----------|------|
| 1    | 1-542            | VALVE KIT - BIDET                | ASSEMBLY | 1    |
| 2    | 2-159            | POP-UP ROD GUIDE ASSEMBLY        | ASSEMBLY | 1    |
| 3    | 2-235            | BIDET DIVERTER / V. BRE          | ASSEMBLY | 1    |
| 4    | 2-236            | DOUCHE SPRAY ASSEMBLY            | ASSEMBLY | 1    |
| 5    | 2-470            | LEVER HANDLE ASM W/8 FLATS       | ASSEMBLY | 2    |
| 6    | 325              | POP UP ASSEMBLY                  | ASSEMBLY | 1    |
| 7    | 10048            | ESCUTCHEON W/S VALVE             | PART     | 2    |
| 8    | 10095            | ESCUTCHEON, 900 SERIES           | PART     | 2    |
| 9    | 10288            | 3/16" POP UP ROD                 | PART     | 1    |
| 10   | 11181            | POP-UP KNOB                      | PART     | 1    |
| 11   | <del>91231</del> | O-RING, #2-136, EPDM, 65-75 DURO | PART     | 2    |

91753

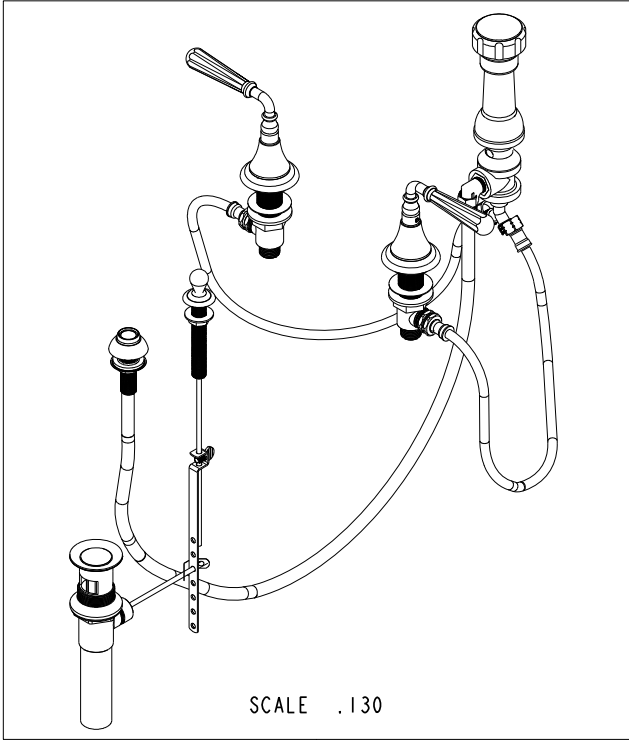

REV B EN-3722 02/08/2019 CG

COPYRIGHT 2005 BRASSTECH, INC. THESE DRAWINGS AND THE DESIGNS DEPICTED HEREIN ARE THE PROPRIETARY PROPERTY OF BRASSTECH. ANY USE OR REPRODUCTION IS SUBJECT TO THE EXPRESS APPROVAL OF BRASSTECH. UNAUTHORIZED USE IS STRICTLY PROHIBITED. ALL RIGHTS RESERVED.

**BRASSTECH**  
INCORPORATED  
2001 E. CARNEGIE AVE.  
SANTA ANA, CA 92705  
(949) 417-5207

**BOTTOM SPRAY BIDET**

|              |        |     |          |          |
|--------------|--------|-----|----------|----------|
| ASSY. NO.    | 1749   | A   | EN-2334  | 12/20/12 |
| SCALE .200   | REF. - | -   | EO-0390A | 03/07/06 |
| SHEET 1 OF 3 | REV    | REV | REV DESC | DATE     |

**SPECIFICATION DWG**

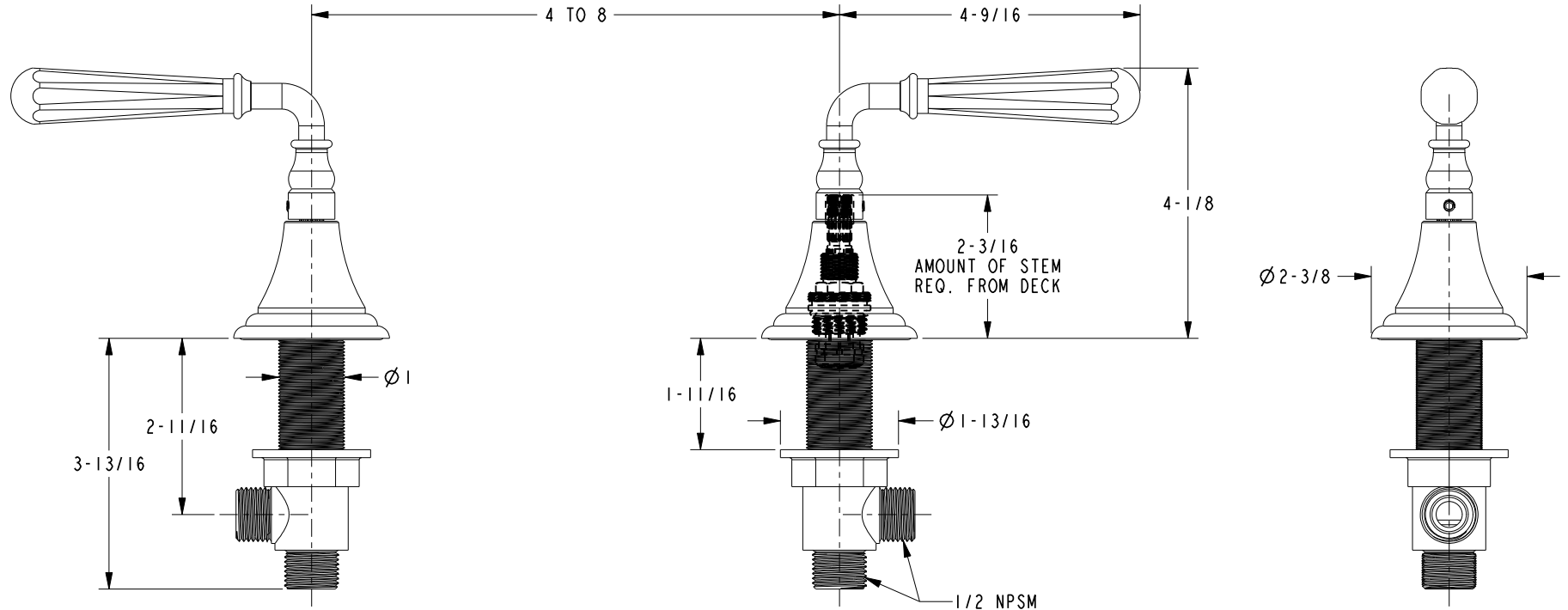

DIMENSIONS ARE IN INCHES AND AN APPROXIMATION OF A TYPICAL INSTALLATION

COPYRIGHT 2005 BRASSTECH, INC. THESE DRAWINGS AND THE DESIGNS DEPICTED HEREIN ARE THE PROPRIETARY PROPERTY OF BRASSTECH. ANY USE OR REPRODUCTION IS SUBJECT TO THE EXPRESS APPROVAL OF BRASSTECH. UNAUTHORIZED USE IS STRICTLY PROHIBITED. ALL RIGHTS RESERVED.

|                  |        |   |
|------------------|--------|---|
| <b>BRASSTECH</b> |        | 2001 CARNEGIE AVE.<br>SANTA ANA, CA 92705<br>(949) 417-5207 |
| DWG NO.          | 1749   | REV<br>A  |
| SCALE .400       | REF. - | SHEET 2 OF 3  |

SPECIFICATION DWG

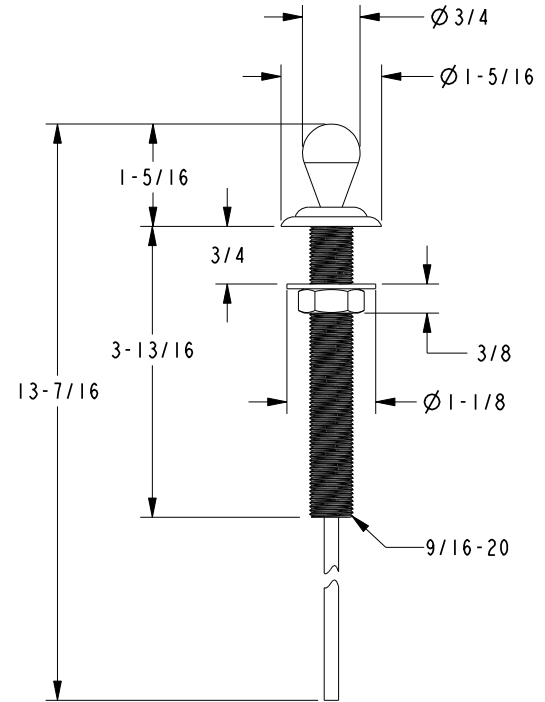
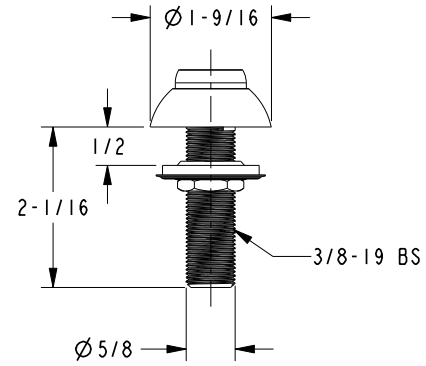
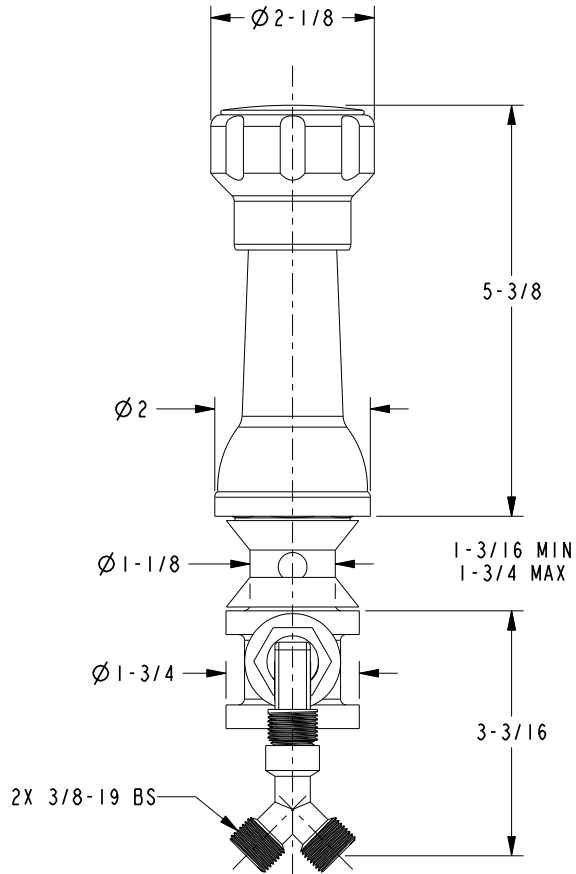
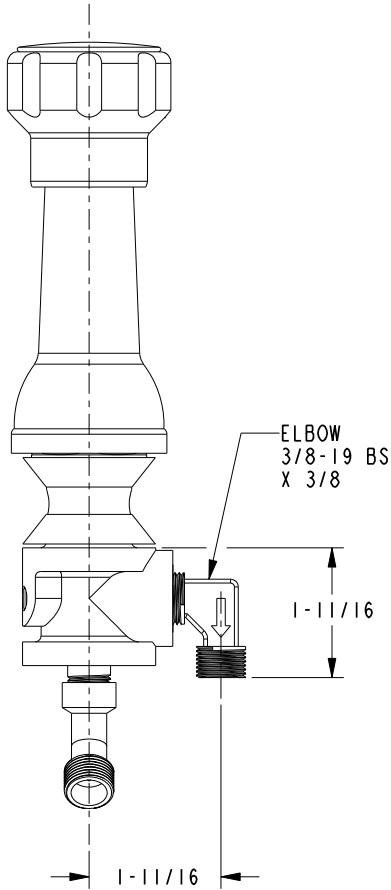

DIMENSIONS ARE IN INCHES AND AN APPROXIMATION OF A TYPICAL INSTALLATION

COPYRIGHT 2005 BRASSTECH, INC. THESE DRAWINGS AND THE DESIGNS DEPICTED HEREIN ARE THE PROPRIETARY PROPERTY OF BRASSTECH. ANY USE OR REPRODUCTION IS SUBJECT TO THE EXPRESS APPROVAL OF BRASSTECH. UNAUTHORIZED USE IS STRICTLY PROHIBITED. ALL RIGHTS RESERVED.

|                  |      |   |   |
|------------------|------|---|---|
| <b>BRASSTECH</b> |      | 2001 CARNEGIE AVE.<br>SANTA ANA, CA 92705<br>(949) 417-5207 |   |
| DWG NO.          | 1749 | REV   | A |
| SCALE            | .400 | REF.  | - |
| SHEET 3          |      | OF 3  |   |