

- △ 2 APPLY LOCTITE 680.
- △ 3 TORQUE TO 15-20 FT-LB.
- △ 4 APPLY LOCTITE 242 IF SCREW DOES NOT HAVE NYLON PATCH.
- △ 5 TORQUE TO 11-14 FT-LB.

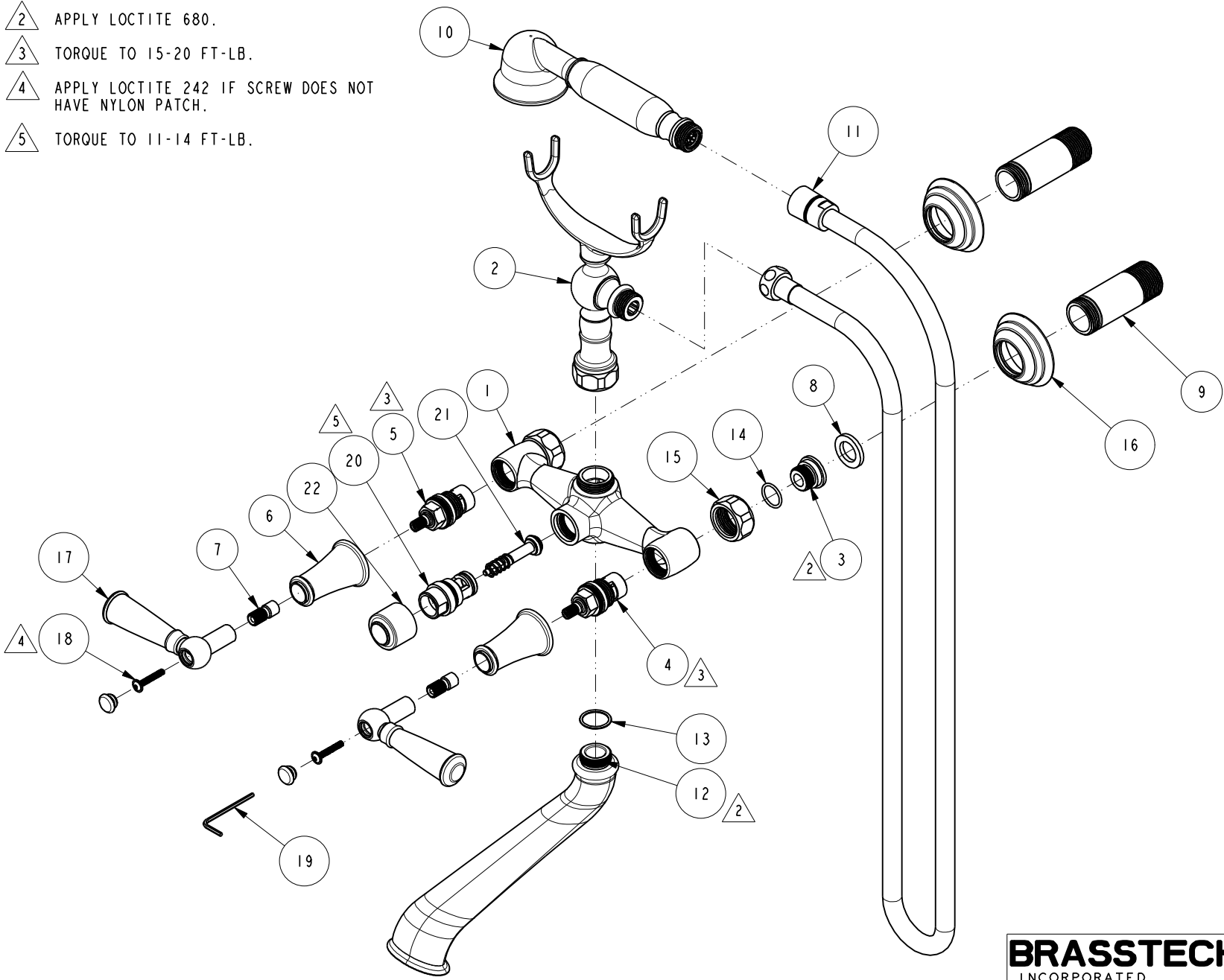

BRASSTECH 2001 CARNEGIE AVE.
 INCORPORATED SANTA ANA, CA 92705
 (949) 417-5207

DWG NO.	2400-4283	REV	E
SCALE	.250	REF.	-
SHEET 2		OF 3	

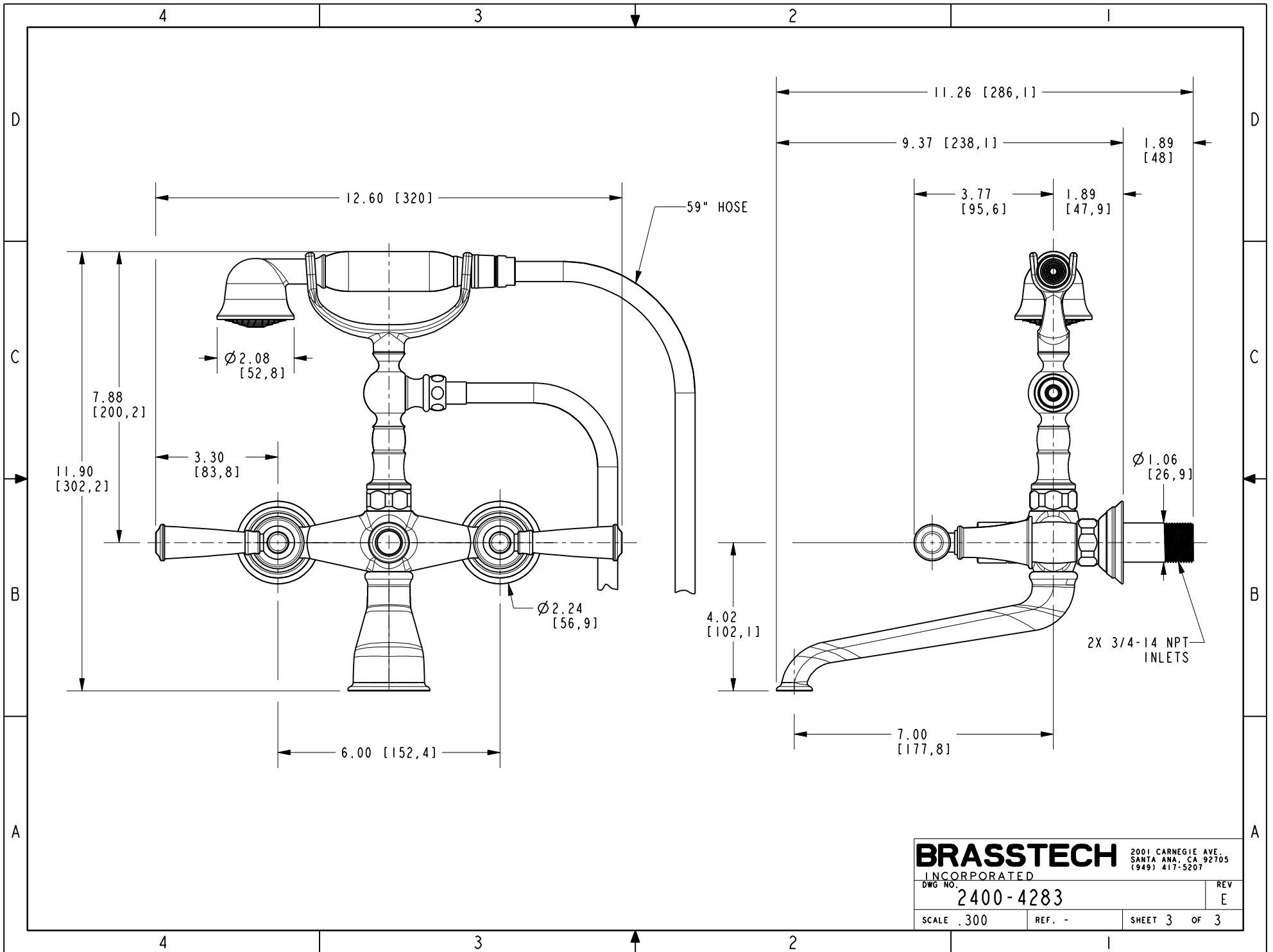

BRASSTECH
 INCORPORATED
 2001 CARNEGIE AVE.
 SANTA ANA, CA 92705
 (949) 417-5207

DWG NO. 2400-4283	REV E
SCALE .300	REF. -
SHEET 3 OF 3	