

NOTES:

1. TO INSPECT ASSEMBLY, FOLLOW FIRST ARTICLE AND IN PROCESS INSPECTION SHEET.

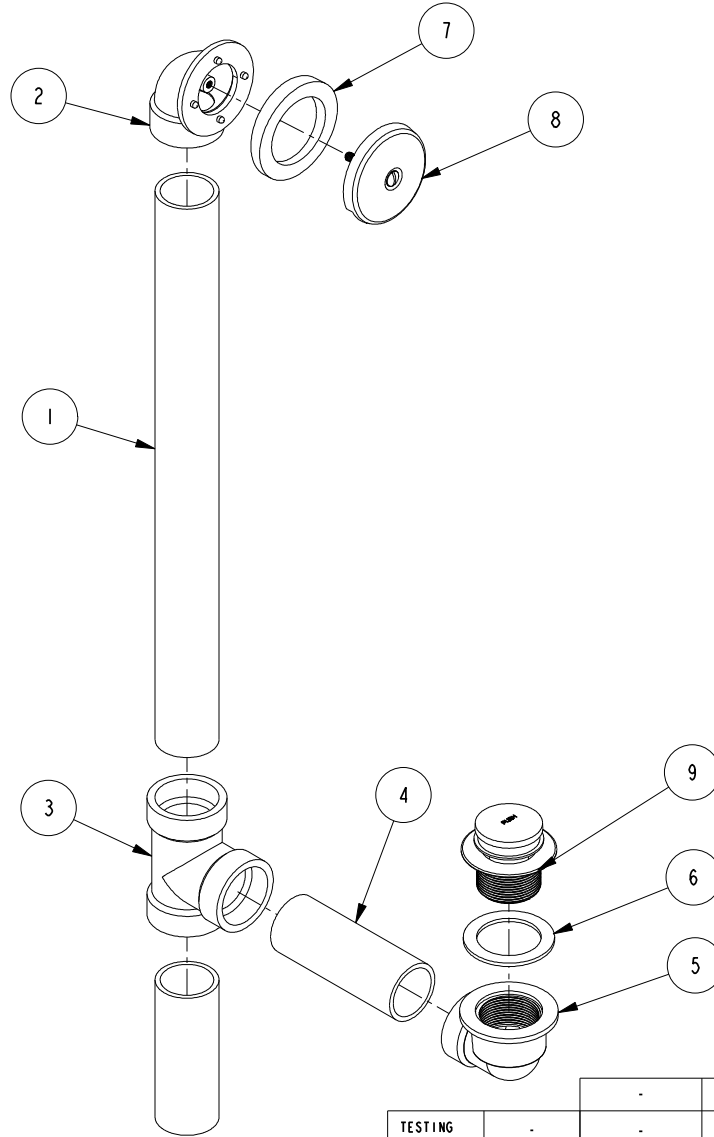

**BILL OF MATERIAL (CURRENT LEVEL)**

ITEM	PT/ASSY	DESCRIPTION	TYPE	QTY.
1	50253	20" ABS PIPE	PART	1
2	50255	ELBOW OVERFLOW 1-1/2 IN.	PART	1
3	50257A	TEE 1-1/2" ABS (4C-B)	PART	1
4	50254	5" ABS PIPE	PART	2
5	50256	ELBOW WASTE 1-1/2 IN.	PART	1
6	91170	WASHER	PART	1
7	91171	GASKET	PART	1
8	265	FACEPLATE FOR W/O	ASSEMBLY	1
9	272	TOE ACTIVATED TUB DR	ASSEMBLY	1

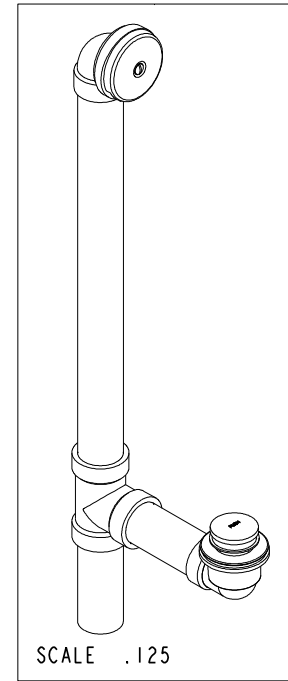

TESTING	-	-	-
ASSEMBLY	-	-	-
PLATING	-		
POLISHING	-	NEXT ASSY	USED ON
MACHINING	-	APPLICATION	
TOOLING FIXTURE #		REMOVE ALL BURRS AND SHARP EDGES	

UNITS ARE: INCHES [MM]  
 TOLERANCES ARE:  
 FRACTIONS DECIMALS ANGLES  
 $\pm 1/16"$  .X  $\pm .1$  [2.5]  $\pm 1^\circ$   
 .XX  $\pm .06$  [1.5]

(X.XXX) DENOTES CRITICAL DIMS.  
 ALL THREADS ARE CRITICAL

DRAWN C.GAYOSSO 12/20/17  
 CHECKED V.VU 12/20/17  
 APPROVED V.VU 12/20/17

**BRASSTECH**  
 INCORPORATED

2001 CARNEGIE AVE.  
 SANTA ANA, CA 92705  
 (949) 417-5207

TOE ACTIVATED W/O

DWG NO.	255	REV	A
SCALE	.175	REF.	-
SHEET	1	OF	2

COPYRIGHT 2005 BRASSTECH, INC.  
 THESE DRAWINGS AND THE DESIGNS  
 DEPICTED HEREIN ARE THE PROPRIETARY  
 PROPERTY OF BRASSTECH. ANY USE  
 OR REPRODUCTION IS SUBJECT TO  
 THE EXPRESS APPROVAL OF BRASSTECH.  
 UNAUTHORIZED USE IS STRICTLY  
 PROHIBITED. ALL RIGHTS RESERVED.

ZONE	REV	DESCRIPTION	DATE	APPROVED
-	A	EN-430011	10/11/21	R.S.
-	-	EN-3504	12/20/17	V.V.

