

NOTES:

1. TO INSPECT ASSEMBLY, FOLLOW FIRST ARTICLE AND IN PROCESS INSPECTION SHEET.

BILL OF MATERIAL (CURRENT LEVEL)

ITEM	PT/ASSY	DESCRIPTION	TYPE	QTY.
1	50241	WASHER TEE	PART	1
2	50242	TUBE, 1-1/2" X 3" X .040"	PART	1
3	50239	TUBING, 1-1/2" X 4.5"L	PART	1
4	50238	WASTE CAST'G 1-1/2	PART	1
5	91170	WASHER	PART	1
6	270	LIFT & TURN BATH PLUG	ASSEMBLY	1
7	5-018	TRIP LEVER ELBOW	ASSEMBLY	1
8	91169	WSHR, 1.50 ID X 1.73 OD X .25 THK.	PART	2
9	50243	NUT SLIP JOINT 1-1/2	PART	2
10	91171	GASKET	PART	1
11	266	W/O FACEPLATE W/2 SCRWS	ASSEMBLY	1
12	50839	HIGH BOX FLANGE (313)	PART	1

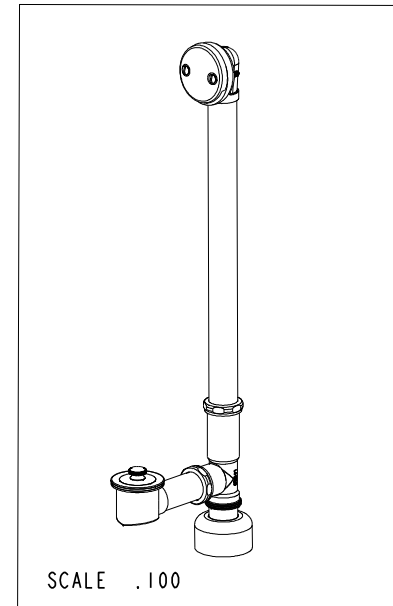
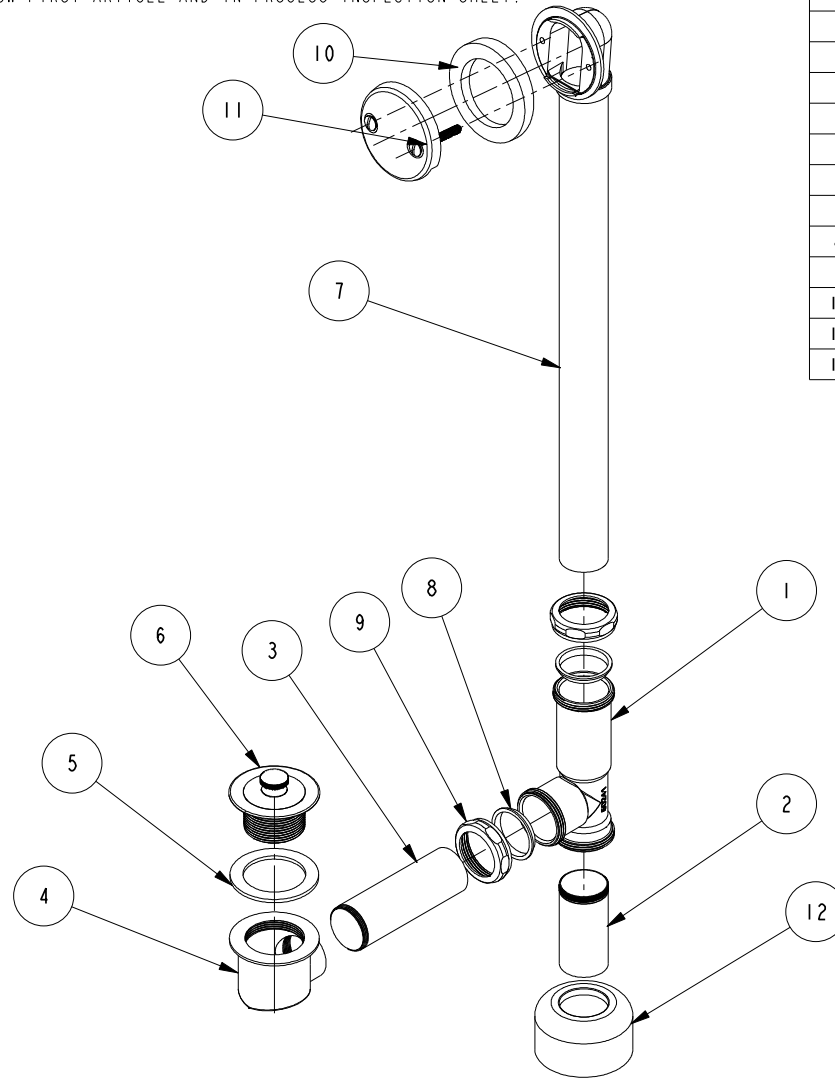

ZONE	REV	DESCRIPTION	DATE	APPROVED
-	B	EN-430011	10/11/21	R. S.
-	A	EN-3734	11/09/18	V. VU
-	-	EN-3523	10/12/18	NS

COPYRIGHT 2005 BRASSTECH, INC. THESE DRAWINGS AND THE DESIGNS DEPICTED HEREIN ARE THE PROPRIETARY PROPERTY OF BRASSTECH. ANY USE OR REPRODUCTION IS SUBJECT TO THE EXPRESS APPROVAL OF BRASSTECH. UNAUTHORIZED USE IS STRICTLY PROHIBITED. ALL RIGHTS RESERVED.

TESTING	-	-	-
ASSEMBLY	-	-	-
PLATING	-		
POLISHING	-	NEXT ASSY	USED ON
MACHINING	-	APPLICATION	
TOOLING FIXTURE #		REMOVE ALL BURRS AND SHARP EDGES	

UNITS ARE: INCHES [MM]
 TOLERANCES ARE:
 FRACTIONS DECIMALS ANGLES
 $\pm 1/16"$.X $\pm .1$ [2.5]
 .XX $\pm .06$ [1.5]
 ° $\pm 1"$
 (X.XXX) DENOTES CRITICAL DIMS.
 ALL THREADS ARE CRITICAL
 DRAWN J. MIRANDA 11/09/18
 CHECKED V. VU 11/09/18
 APPROVED V. VU 11/09/18

BRASSTECH 2001 CARNEGIE AVE.
 INCORPORATED SANTA ANA, CA 92705
 (949) 417-5207

WASTE & OVERFLOW, LIFT & TURN STYLE DRAIN

DWG NO. **257** REV **B**

SCALE .170 REF. - SHEET 1 OF 2

