

NOTES:

(N1) 1. FIT / FORM / FUNCTION SHALL FOLLOW PS-E.008.

BILL OF MATERIAL (CURRENT LEVEL)

ITEM	PT/ASSY	DESCRIPTION	TYPE	QTY.
1	2-144	WALL TUB SPOUT - HEX	ASSEMBLY	1
2	2-217	DIVERTER TRIM KIT	ASSEMBLY	1
3	2-224	COVERPLATE BP W/DIVERTER	ASSEMBLY	1
4	2-876	CRYSTAL HANDLE LEVER ASM	ASSEMBLY	1
5	200	SHOWER ARM 6" BRASS	PART	1
6	206	SHOWER ARM FLANGE	PART	1
7	2156	SHOWER HEAD, TRAD	ASSEMBLY	1
8	10960	HEX ESCUTCHEON	PART	1
9	91386	O-RING, #2-034, EPDM, 65-75 DURO	PART	1

91754

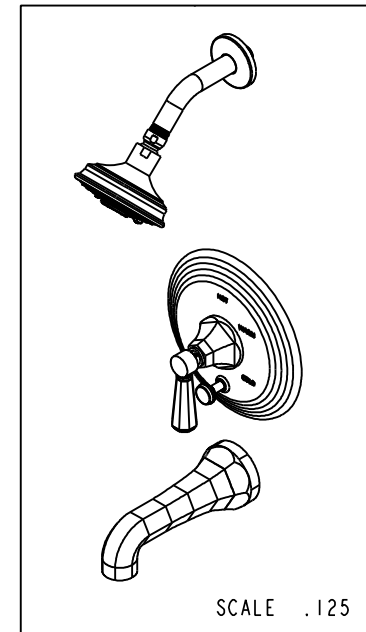
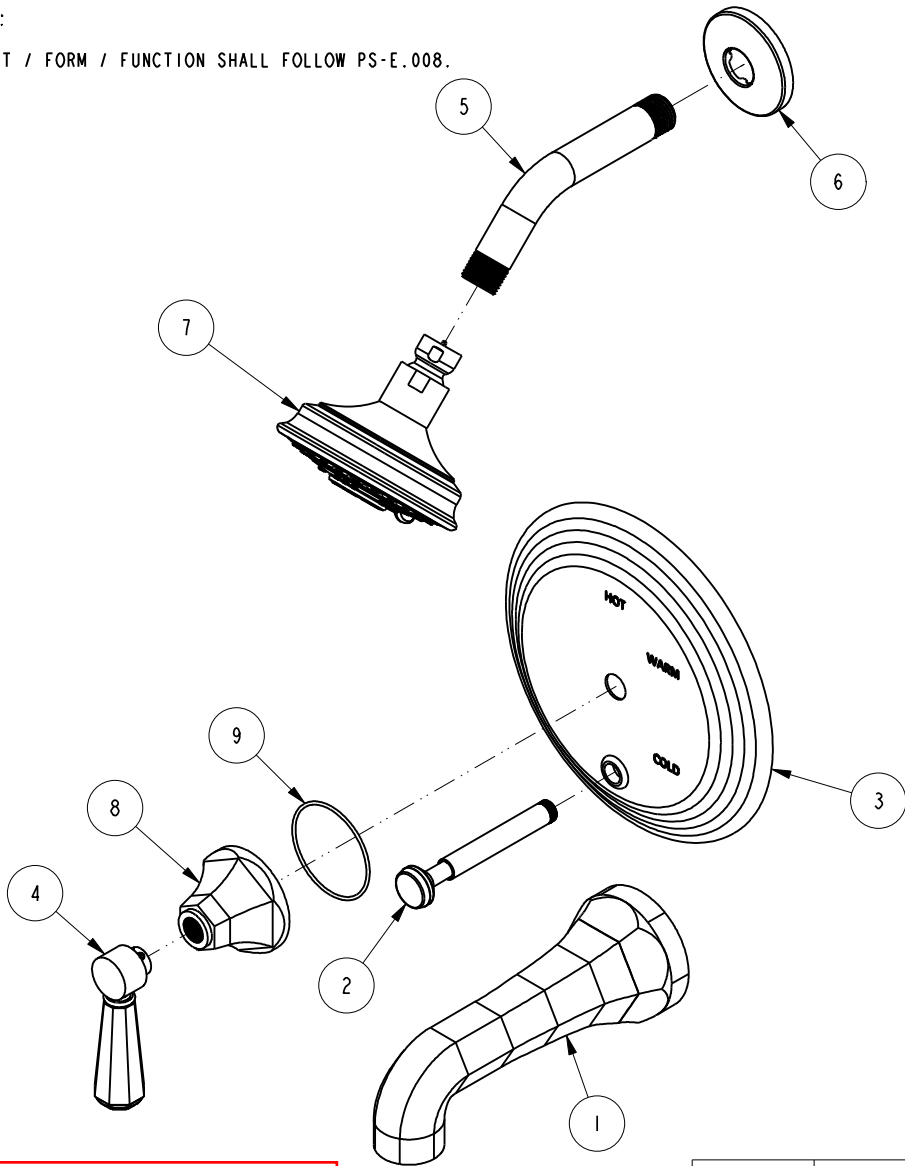

REV D EN-3722 02/08/2019 CG

ZONE	REV	DESCRIPTION	DATE	APPROVED
-	C	EN-2997	08/25/16	J.A
-	B	EN-2802	09/09/14	J.M
-	A	EN-2677	01/16/14	-
-	-	EN-2415	06/11/13	-

COPYRIGHT 2005 BRASSTECH, INC. THESE DRAWINGS AND THE DESIGNS DEPICTED HEREIN ARE THE PROPRIETARY PROPERTY OF BRASSTECH. ANY USE OR REPRODUCTION IS SUBJECT TO THE EXPRESS APPROVAL OF BRASSTECH. UNAUTHORIZED USE IS STRICTLY PROHIBITED. ALL RIGHTS RESERVED.

TESTING	-	-	-
ASSEMBLY	-	-	-
PLATING	-	-	-
POLISHING	-	NEXT ASSY	USED ON
MACHINING	-	APPLICATION	
TOOLING FIXTURE #	REMOVE ALL BURRS AND SHARP EDGES		

UNITS ARE: INCHES [MM]	
TOLERANCES ARE:	
FRACTIONS DECIMALS	ANGLES
$\pm 1/16"$.X \pm .1 [2.5]
	.XX \pm .06 [1.5]
(X.XXX) DENOTES CRITICAL DIMS. ALL THREADS ARE CRITICAL	
DRAWN	RAVINDRA 01/19/16
CHECKED	JINSON 01/19/16
APPROVED	J.M 01/19/16

BRASSTECH 2001 CARNEGIE AVE. SANTA ANA, CA 92705 (949) 417-5207
INCORPORATED

BP TUB & SHOWER TRIM SET

DWG NO.	3-1232BP	REV	D
SCALE	.200	REF.	-
SHEET	1	OF	5

4

3

2

D

D

C

C

B

B

A

A

4

3

2

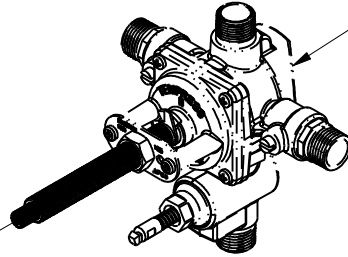
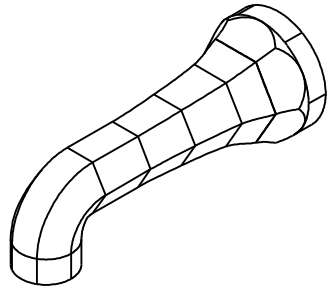
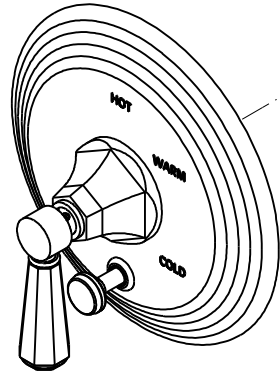

PN: 1-595
SOLD SEPARATELY

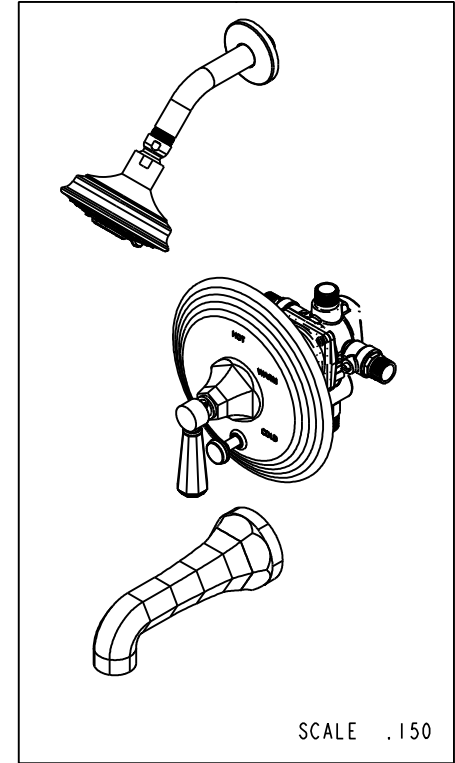

SCALE .150

BRASSTECH 2001 E. CARNEGIE AVE.
INCORPORATED SANTA ANA, CA 92705
(949) 417-5207

DWG NO.	3-1232BP	REV	C
SCALE	.250	REF.	-
SHEET 2		OF 3	

NOTES:

1 CUT ALL-THREAD .63" SHORTER THAN STEM.

D
C
B
A

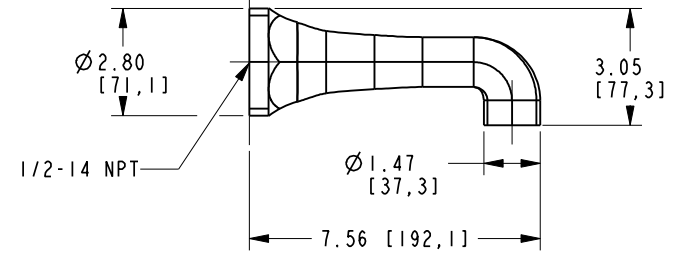
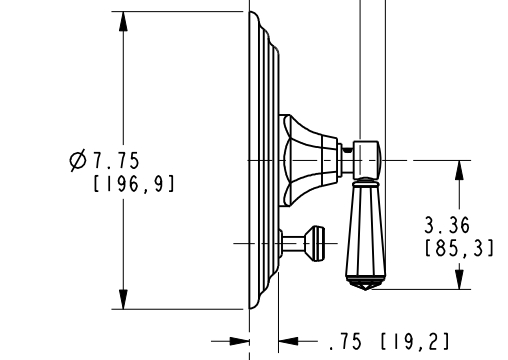
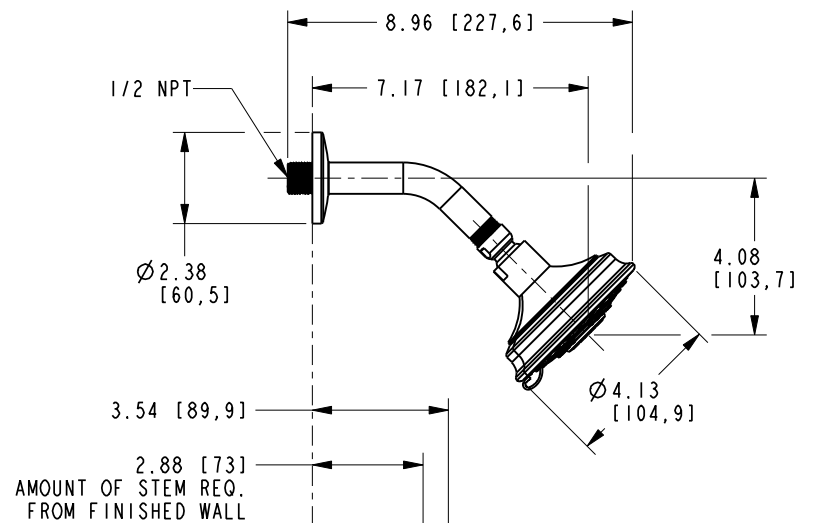
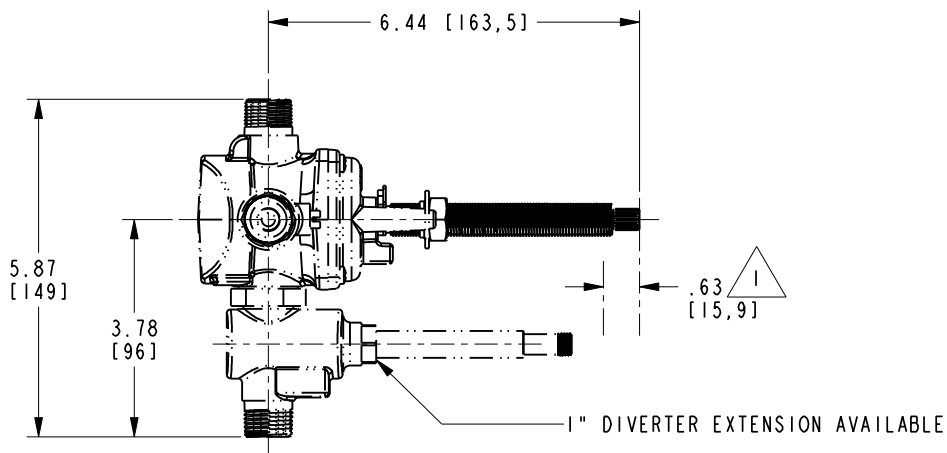
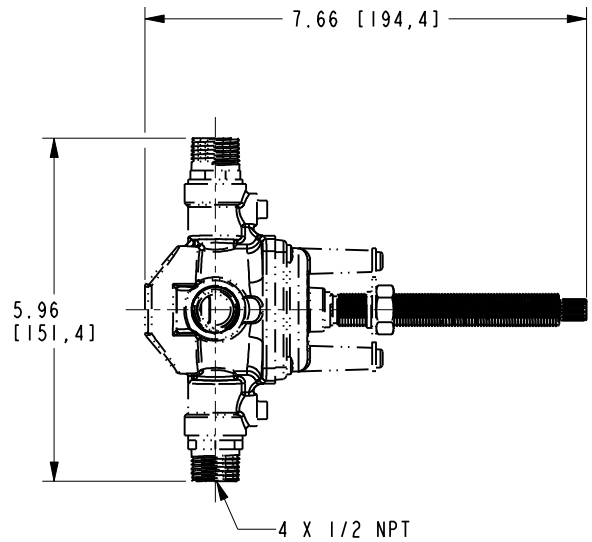

D
C
B
A

BRASSTECH		2001 E. CARNEGIE AVE. SANTA ANA, CA 92705 (949) 417-5207	
DWG NO.	3-1232BP		REV C
SCALE .200	REF. -	SHEET 3 OF 3	

4 3 2 1