

# REPLACEMENT PARTS

ITEM	PT/ASSY	SPECIFY FINISH	DESCRIPTION
1	20-742	YES	ESCUTCHEON ASM
2	91753		O-RING, # 2-136, EP, 50 DURO - GREY
3	10523	YES	HEX ESCUTCHEON BONNET
4	2-143	YES	HANDLE ONLY, DIV.
5	2-173		CROSS HANDLE ASSEMBLY W/O BUTTON
6	92000		SCREW 8 - 32 X 1/8 SS
7	10192		HEX KEY TOOL, #8 5/64
8	1-109	YES	DIVERTER BUTTON W/ ADHESIVE

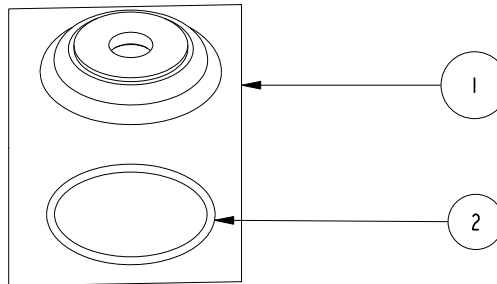
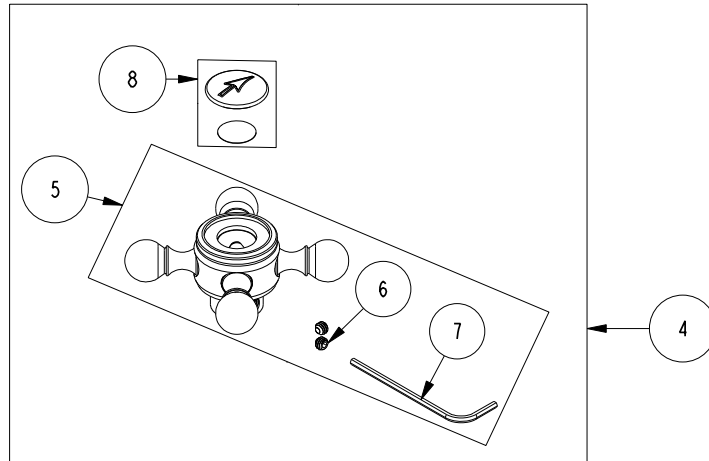

Cross handle Trim  
3-163

REV D EN-4989 05/07/25

**NEWPORT BRASS.**

t: 949.417.5207 | www.newportbrass.com