

NOTES:

1. TO INSPECT ASSEMBLY, FOLLOW FIRST ARTICLE AND IN PROCESS INSPECTION SHEET.

**BILL OF MATERIAL (CURRENT LEVEL)**

ITEM	PT/ASSY	DESCRIPTION	TYPE	QTY.
1	3-214	SQUARE R/T SPOUT	ASSEMBLY	1
2	3-220C	ASSY, HANDLE TRIM, COLD	ASSEMBLY	2
3	3-220H	ASSY, HANDLE TRIM, HOT	ASSEMBLY	1
4	6-289-1	DECK FLANGE TRIM	ASSEMBLY	1
5	283-102	SQUARE WAND HANDSHOWER	ASSEMBLY	1
6	284	59 IN. SPIRAL SHOWER HOSE	ASSEMBLY	1

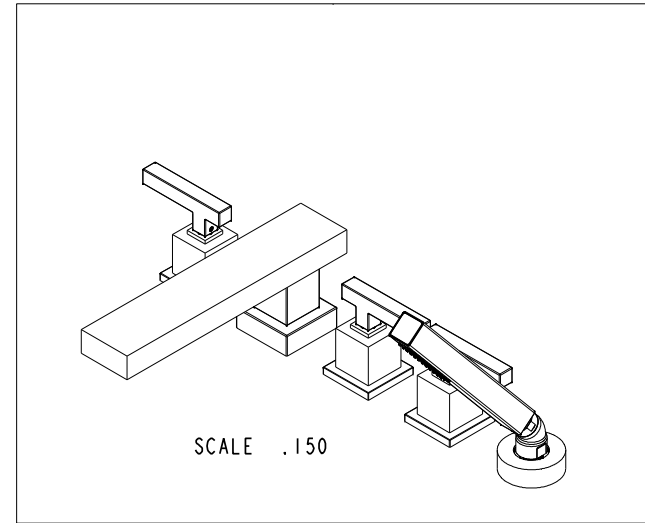
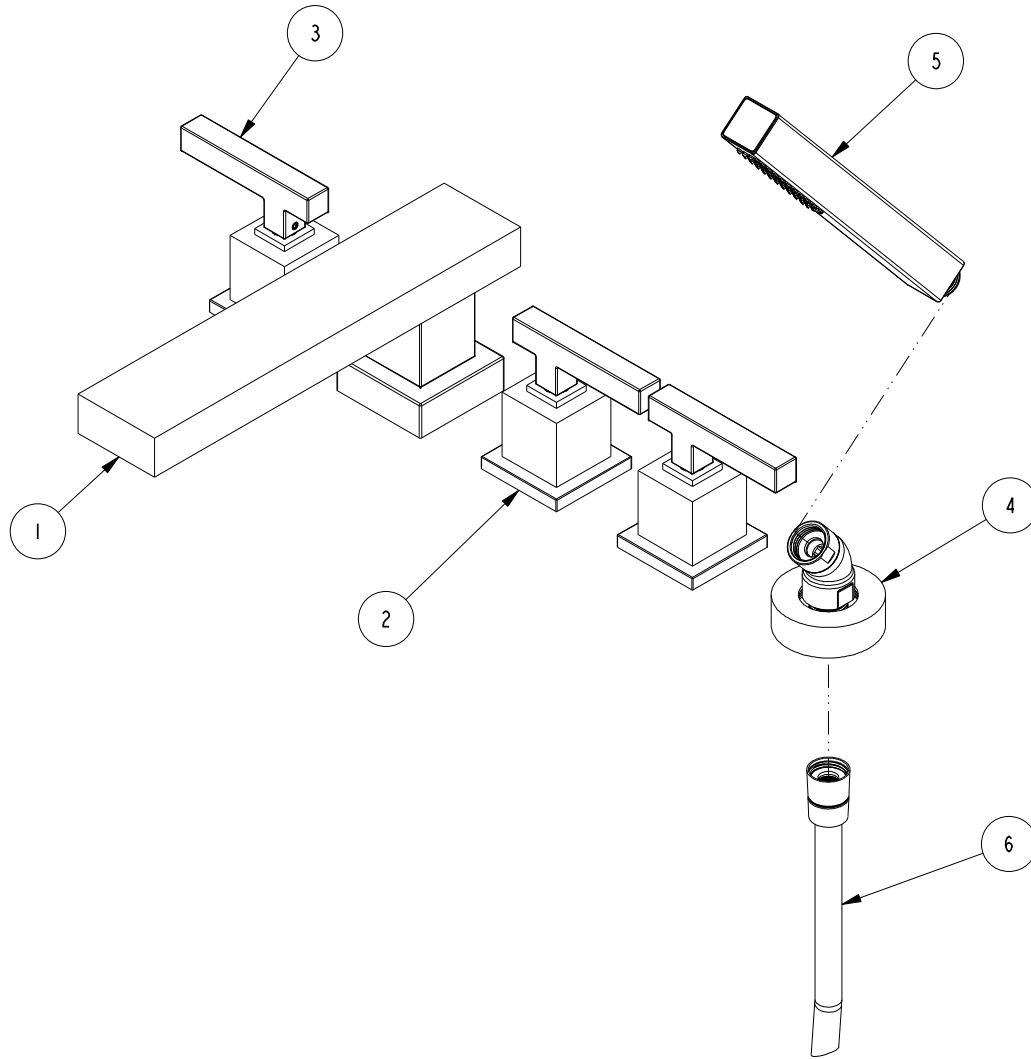

-	F	EN-4300u	02/02/21	R.S.
-	E	EN-3397	06/05/18	J.A.
-	D	EN-2032	01/07/14	-
-	A	EO-0259	03/22/04	-
-	-	RELEASED	09/27/99	-
ZONE	REV	DESCRIPTION	DATE	APPROVED

COPYRIGHT 2005 BRASSTECH, INC. THESE DRAWINGS AND THE DESIGNS DEPICTED HEREIN ARE THE PROPRIETARY PROPERTY OF BRASSTECH. ANY USE OR REPRODUCTION IS SUBJECT TO THE EXPRESS APPROVAL OF BRASSTECH. UNAUTHORIZED USE IS STRICTLY PROHIBITED. ALL RIGHTS RESERVED.

TESTING	-	-	-
ASSEMBLY	-	-	-
PLATING	-	-	-
POLISHING	-	NEXT ASSY	USED ON
MACHINING	-	APPLICATION	
TOOLING FIXTURE #	REMOVE ALL BURRS AND SHARP EDGES		

UNITS ARE: INCHES [MM]			
TOLERANCES ARE:			
FRACTIONS	DECIMALS	ANGLES	
±1/16"	.X ±.1 [2.5]	±1°	
	.XX ±.06 [1.5]		
(X.XXX) DENOTES CRITICAL DIMS.			
ALL THREADS ARE CRITICAL			
DRAWN	JIMSON	02/02/21	
CHECKED	R.S.	02/02/21	
APPROVED	R.S.	02/02/21	

**BRASSTECH** 2001 CARNEGIE AVE.  
INCORPORATED SANTA ANA, CA 92705  
(949) 417-5207

**R/T TRIM KIT WITH H / SHOWER**

DWG NO. **3-2027** REV **F**

SCALE .250 REF. - SHEET 1 OF 3

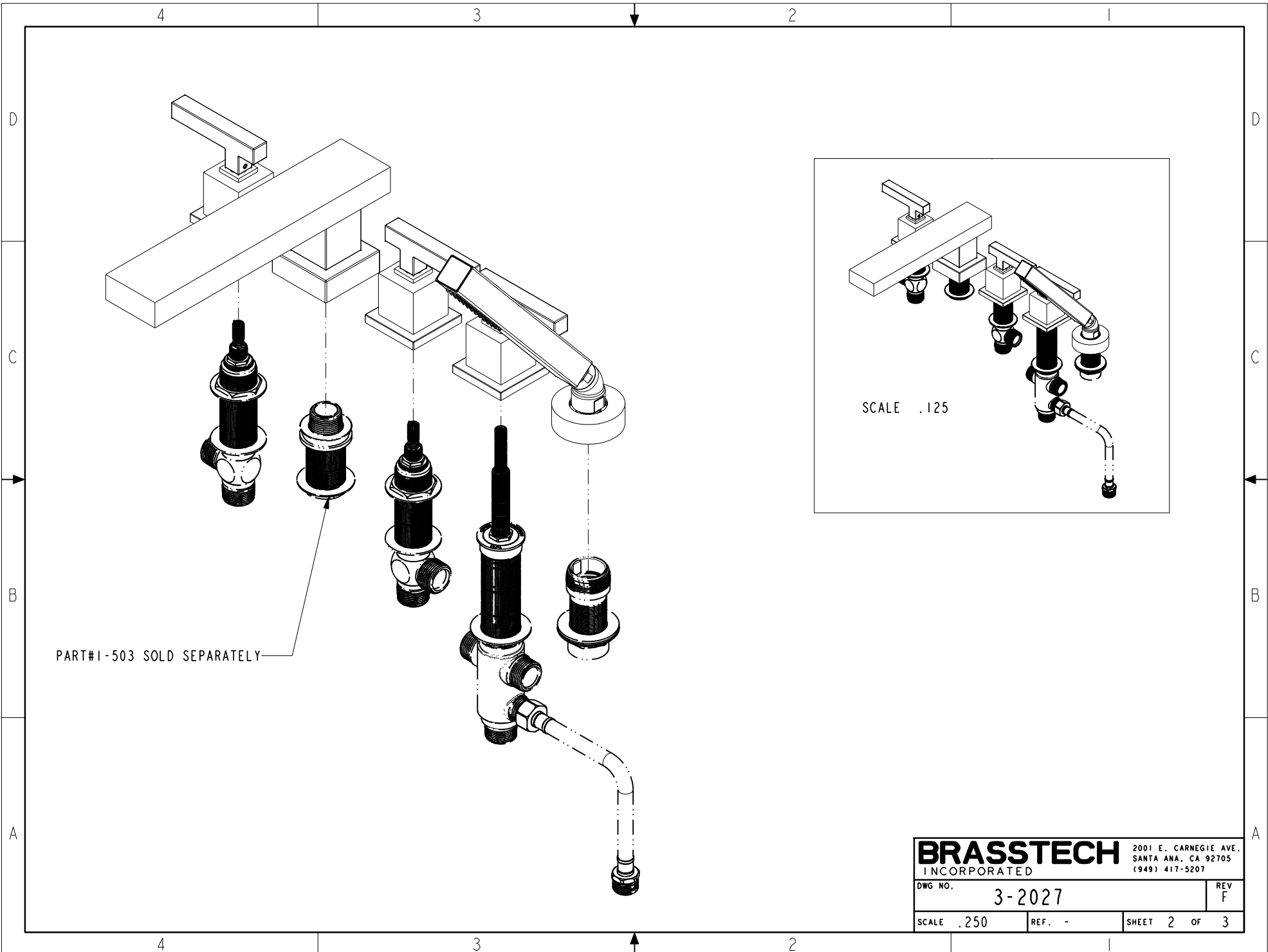

<b>BRASSTECH</b>		2001 E. CARNEGIE AVE. SANTA ANA, CA 92705 (949) 417-5207	
DWG NO.	3-2027	REV	F
SCALE	.250	REF.	-
SHEET		2	OF 3

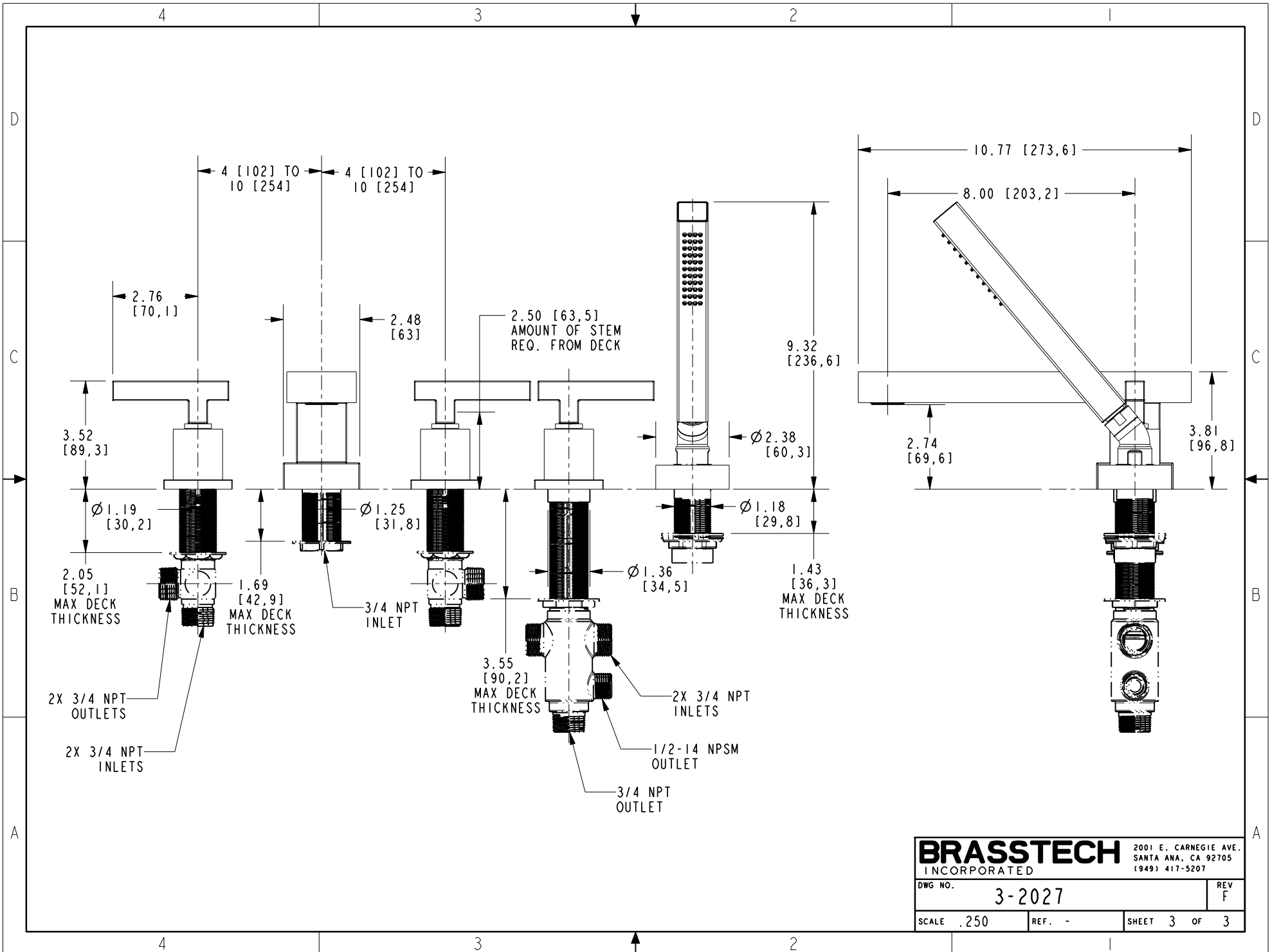

<b>BRASSTECH</b>		2001 E. CARNEGIE AVE. SANTA ANA, CA 92705 (949) 417-5207
DWG NO.	3-2027	REV F
SCALE .250	REF. -	SHEET 3 OF 3