

NOTES:

1. TO INSPECT ASSEMBLY, FOLLOW FIRST ARTICLE AND IN PROCESS INSPECTION SHEET.

BILL OF MATERIAL (CURRENT LEVEL)				
ITEM	PT/ASSY	DESCRIPTION	TYPE	QTY.
1	20-742	ESCUTCHEON ASM	ASSEMBLY	1
2	10523	HEX ESCUTCHEON BONNET	PART	1
3	2-135	HANDLE ASSEMBLY - DIVERTER	ASSEMBLY	1

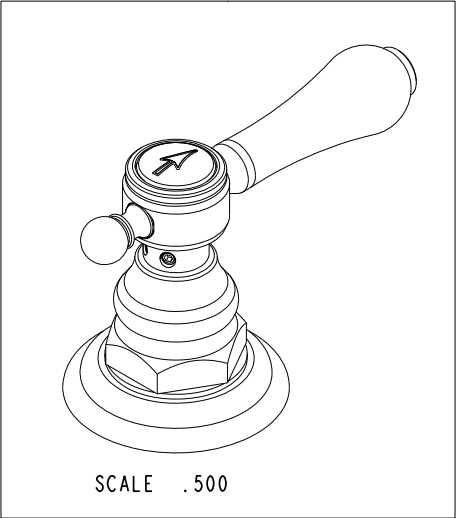
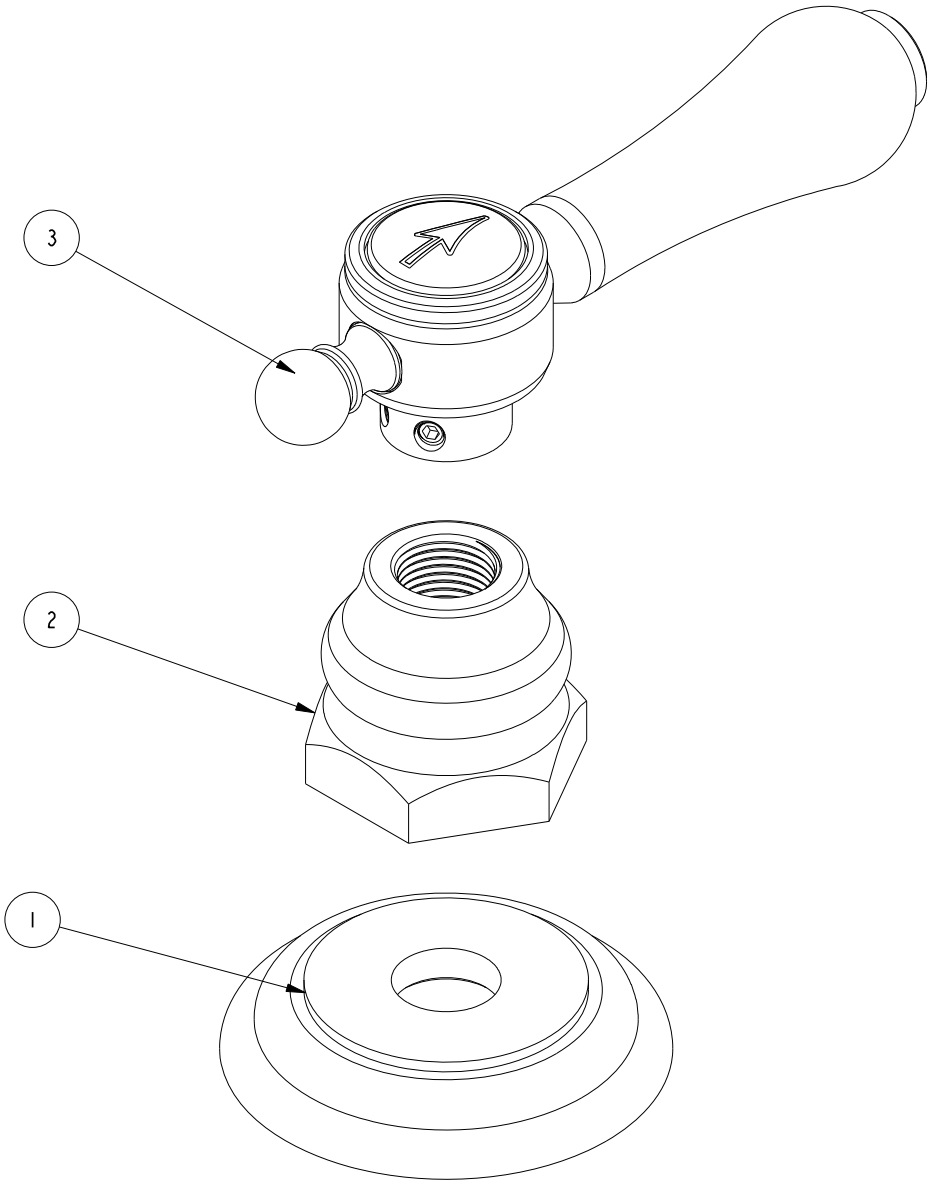

D	EN-4843	07/09/24	K.N.
C	EN-4300j	12/16/20	R.S.
B	EN-3722	02/08/19	C.G.
A	EN-2398A	04/11/13	-
-	RELEASED	06/02/03	-
REV	DESCRIPTION	DATE	APPROVED

COPYRIGHT 2005 BRASSTECH, INC.  
THESE DRAWINGS AND THE DESIGNS  
DEPICTED HEREIN ARE THE PROPRIETARY  
PROPERTY OF BRASSTECH. ANY USE  
OR REPRODUCTION IS SUBJECT TO  
THE EXPRESS APPROVAL OF BRASSTECH.  
UNAUTHORIZED USE IS STRICTLY  
PROHIBITED. ALL RIGHTS RESERVED.

-	-	UNITS ARE: INCHES [MM]		<b>BRASSTECH</b> 2001 CARNEGIE AVE. INCORPORATED SANTA ANA, CA 92705 (949) 417-5207		
-	-	TOLERANCES ARE:				
-	-	FRACTIONS	DECIMALS			ANGLES
-	-	±1/16"	.X ±.1 [2.5] .XX ±.06 [1.5]			±1°
3-1032BP	3-1032BP	X.XXX DENOTES CRITICAL DIMS. ALL THREADS ARE CRITICAL			TRIM KIT - HANDLE ESCUTCHEON	
NEXT ASSY	USED ON	DRAWN	JINSON	12/16/20	DWG NO.	REV
APPLICATION		CHECKED	R.S.	12/16/20	3-241	D
REMOVE ALL BURRS AND SHARP EDGES		APPROVED	R.S.	12/16/20	SCALE 1.000	REF. - SHEET 1 OF 2