

NOTES:

1. TO INSPECT ASSEMBLY, FOLLOW FIRST ARTICLE AND IN PROCESS INSPECTION SHEET.

BILL OF MATERIAL (CURRENT LEVEL)

ITEM	PT/ASSY	DESCRIPTION	TYPE	QTY.
1	20-807	ESCUTCHEON ASM	ASSEMBLY	1
2	2-285	HANDLE ASM	ASSEMBLY	1

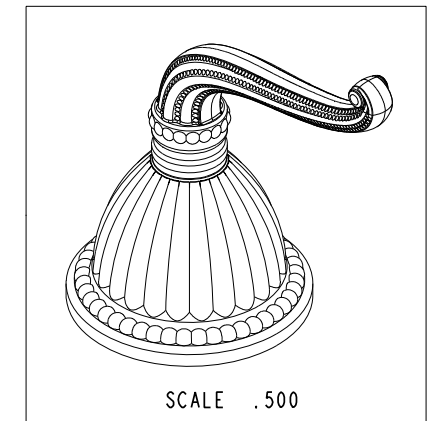
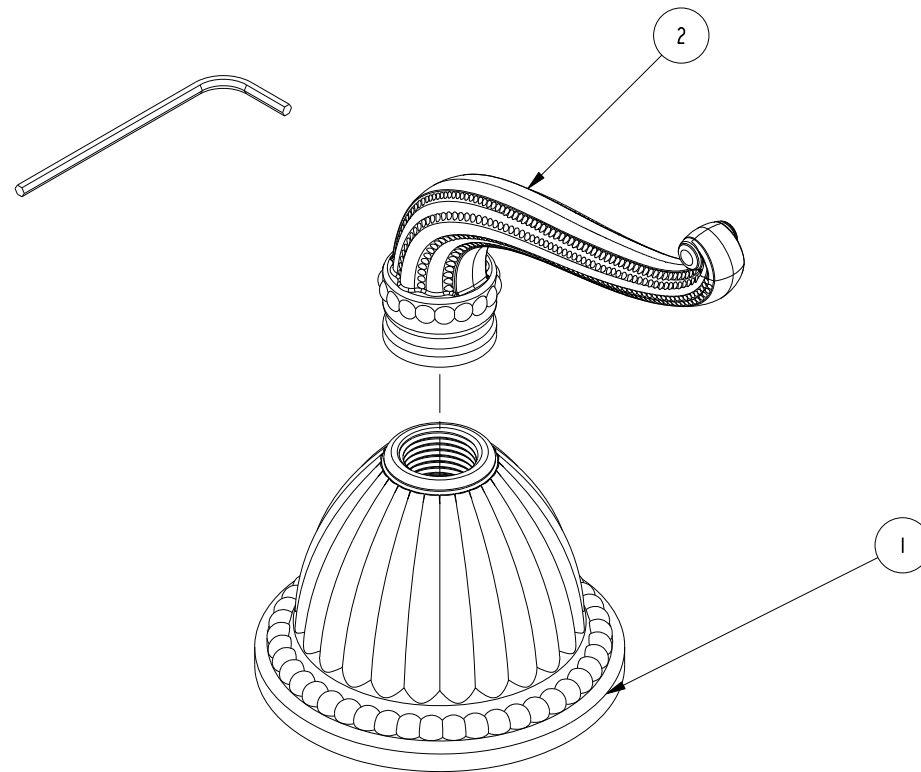

REV	DESCRIPTION	DATE	APPROVED
F	EN-4843	07/08/24	K.N.
E	EN-4585	02/02/23	R.S.
D	EN-4300j	12/16/20	R.S.
C	EN-3722	02/08/19	C.G.
B	EN-2509c	02/21/14	-
A	EN-2032	01/08/14	-
-	RELEASED	-	-

COPYRIGHT 2005 BRASSTECH, INC.
THESE DRAWINGS AND THE DESIGNS
DEPICTED HEREIN ARE THE PROPRIETARY
PROPERTY OF BRASSTECH. ANY USE
OR REPRODUCTION IS SUBJECT TO
THE EXPRESS APPROVAL OF BRASSTECH.
UNAUTHORIZED USE IS STRICTLY
PROHIBITED. ALL RIGHTS RESERVED.

NEXT ASSY	USED ON	DRAWN	CHECKED	APPROVED
1090	1090	JINSON	R.S.	R.S.
APPLICATION		REMOVE ALL BURRS AND SHARP EDGES		

UNITS ARE: INCHES [MM]
TOLERANCES ARE:
FRACTIONS DECIMALS ANGLES
±1/16" .x ±.1 [2.5] ±1°
.xx ±.06 [1.5]

X.XXX DENOTES CRITICAL DIMS.
ALL THREADS ARE CRITICAL

BRASSTECH 2001 CARNEGIE AVE.
INCORPORATED SANTA ANA, CA 92705
(949) 417-5207

TRIM KIT - HANDLE / ESC

DWG NO. 3-248 REV F

SCALE .750 REF. - SHEET 1 OF 2