

NOTES:

(N1) 1. FIT / FORM / FUNCTION SHALL FOLLOW PS-E.008.

2 APPLY DOW CORNING 111

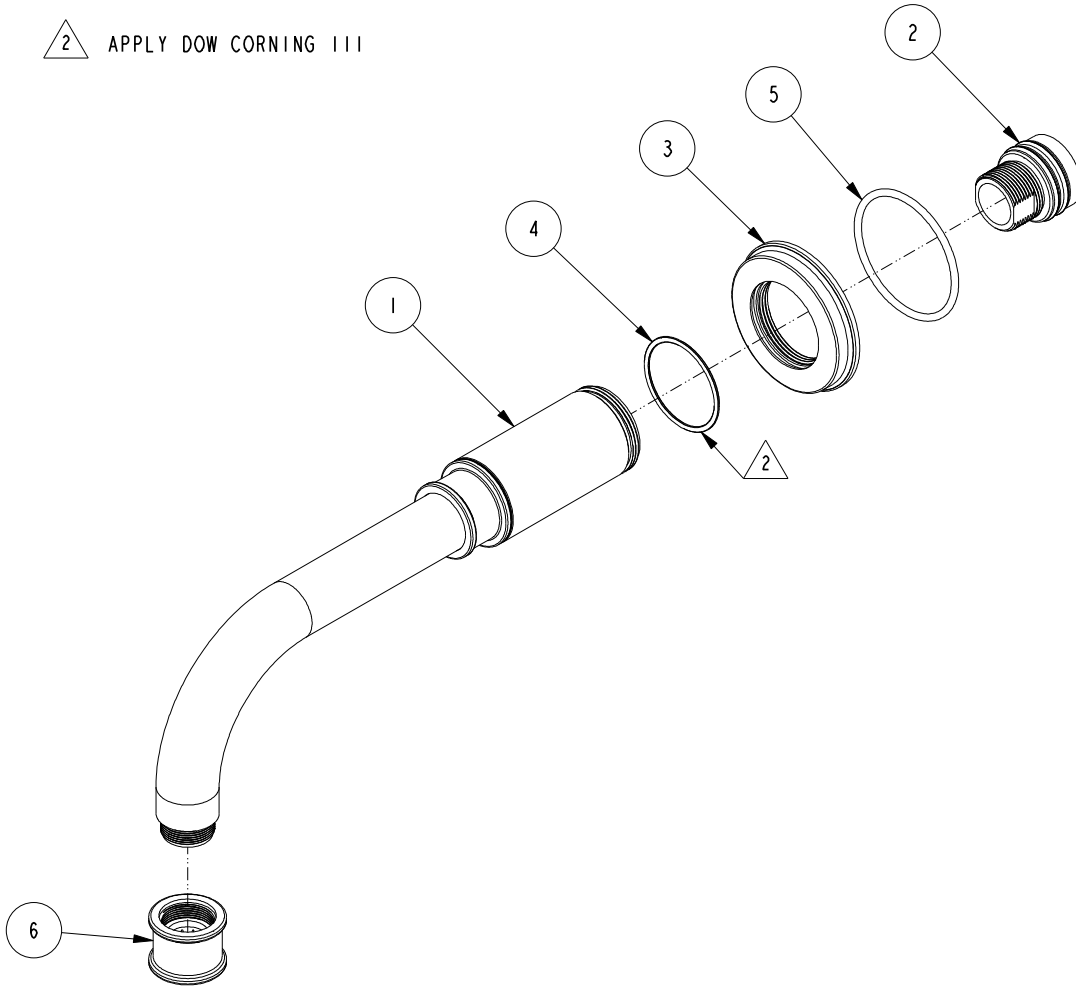

**BILL OF MATERIAL (CURRENT LEVEL)**

ITEM	PT/ASSY	DESCRIPTION	TYPE	QTY.
1	20-424	W/M LAVATORY SPOUT	ASSEMBLY	1
2	1-368	WALL MOUNT SPOUT ADAPTOR ASM	ASSEMBLY	1
3	13148	W/M SPOUT BASE	PART	1
4	91764	O-RING, #2-027, EP, 50 DURO - GREY	PART	1
5	91773	O-RING, #2-133, 50 DURO	PART	1
6	20-439	STREAM STRAIGHTENER ASM	ASSEMBLY	1

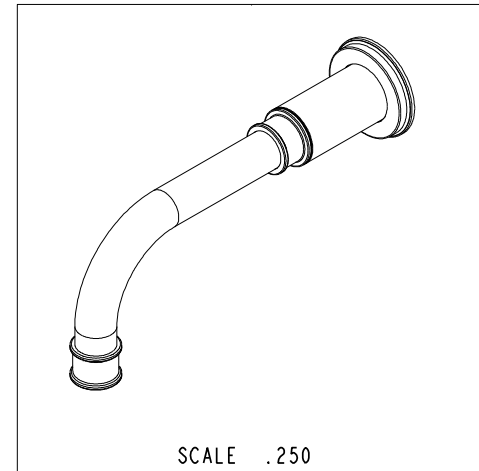

TESTING	-	-	-
ASSEMBLY	-	-	-
PLATING	-	3-3275, 3-3285	3-3275, 3-3285
POLISHING	-	NEXT ASSY	USED ON
MACHINING	-	APPLICATION	
TOOLING FIXTURE #	REMOVE ALL BURRS AND SHARP EDGES		

UNITS ARE: INCHES [MM]	
TOLERANCES ARE:	
FRACTIONS	DECIMALS
±1/16"	.X ±.1 [2.5]
	.XX ±.06 [1.5]
ANGLES ±1°	
(X.XXX) DENOTES CRITICAL DIMS.	
ALL THREADS ARE CRITICAL	
DRAWN	MANJUNATH 05/25/19
CHECKED	JINSON 05/25/19
APPROVED	J.M. 05/25/19

**BRASSTECH** 2001 CARNEGIE AVE.  
INCORPORATED SANTA ANA, CA 92705  
(949) 417-5207

**WALL TUB SPOUT ASM**

DWG NO.	3-643	REV	B
SCALE	.375	REF.	-
SHEET	1	OF	1

COPYRIGHT 2005 BRASSTECH, INC. THESE DRAWINGS AND THE DESIGNS DEPICTED HEREIN ARE THE PROPRIETARY PROPERTY OF BRASSTECH. ANY USE OR REPRODUCTION IS SUBJECT TO THE EXPRESS APPROVAL OF BRASSTECH. UNAUTHORIZED USE IS STRICTLY PROHIBITED. ALL RIGHTS RESERVED.

ZONE	REV	DESCRIPTION	DATE	APPROVED
-	B	EN-4205	07/09/20	J.M.
-	A	EN-3876	05/25/19	J.M.
-	-	EN-3478	03/13/19	J.M.