

4

3

2

1

**NOTES:**

1. TO INSPECT ASSEMBLY, FOLLOW FIRST ARTICLE AND IN PROCESS INSPECTION SHEET.

- 2. PUT THESE ITEMS IN SEPARATE PLASTIC BAGS.
- 3. TORQUE TO 8 +/-0.5 LB-FT.
- 4. APPLY THIN COAT OF SILICON GREASE FOR ALL O-RINGS BEFORE INSTALLATION.
- 5. APPLY LOCTITE 242, IF SCREW DOES NOT HAVE NYLON PATCH.
- 6. APPLY LOCTITE 680.
- 7. PULL OUT HOSE AND APPLY SILICON GREASE, BETWEEN HOUSE AND SPOUT, 10" FROM OUTLET TO HOSE.
- 8. TORQUE SWIVEL NUT TO 10 +/-2 LB-IN.
- 9. TORQUE TO 10 +/-2 LB-FT.
- 10. TORQUE TO 7 +/-2 LB-IN.
- 11. PARTIALLY THREAD MOUNTING KIT ONTO SHANK.
- 12. DO NOT DOCK SPRAY HEAD TO SPOUT WHEN PACKAGING.

**BILL OF MATERIAL (CURRENT LEVEL)**

ITEM	PT/ASSY	DESCRIPTION	TYPE	QTY.
1	3-743	PREP FAUCET BASE ASM	ASSEMBLY	1
2	13667	COLLAR	PART	1
3	12844	HANDLE HUB	PART	1
4	11874	HANDLE ADAPTER SCREW	PART	1
5	20-321	HANDLE LEVER ASM	ASSEMBLY	1
6	20-208	BASE RING ASM	ASSEMBLY	1
7	3-588	SPRAY HEAD, TAFT	ASSEMBLY	1

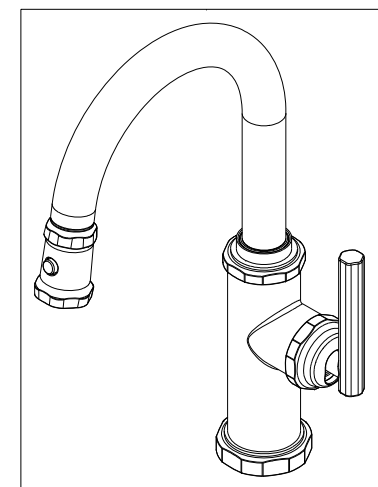
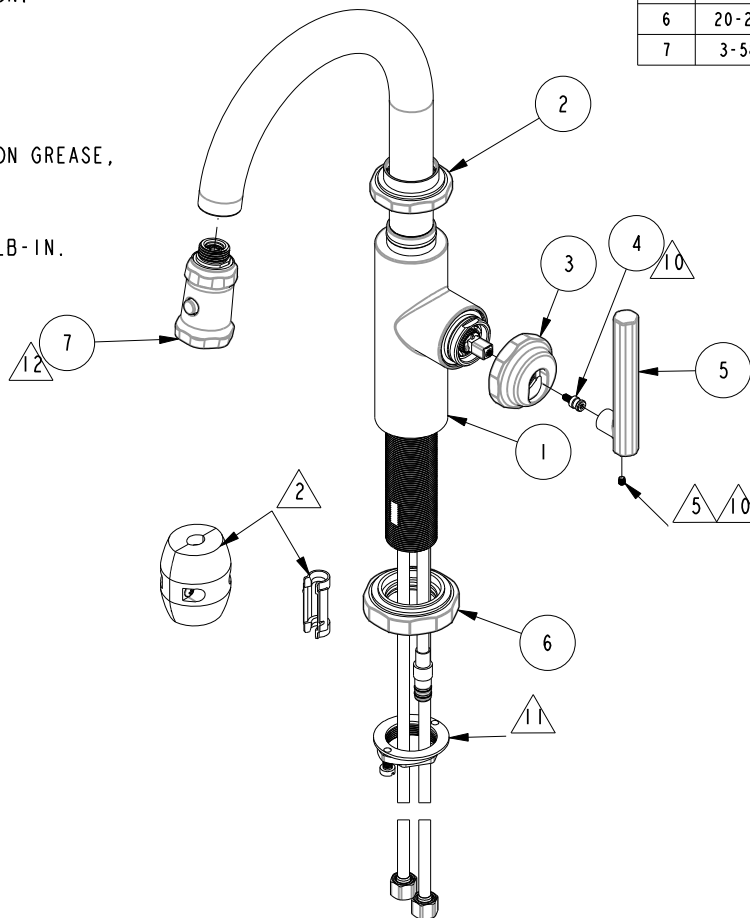

-	E	EN-4213D	08/09/21	C.G.
-	D	EN-4300s	03/29/21	R.S.
-	C	EN-4167	06/10/20	JMR
-	B	EN-3931b	09/23/19	J.M.
-	A	EN-3413b	11/14/17	JM
-	-	EN-3229	06/19/17	JM
ZONE	REV	DESCRIPTION	DATE	APPROVED

COPYRIGHT 2005 BRASSTECH, INC. THESE DRAWINGS AND THE DESIGNS DEPICTED HEREIN ARE THE PROPRIETARY PROPERTY OF BRASSTECH. ANY USE OR REPRODUCTION IS SUBJECT TO THE EXPRESS APPROVAL OF BRASSTECH. UNAUTHORIZED USE IS STRICTLY PROHIBITED. ALL RIGHTS RESERVED.

TESTING	-	-	-
ASSEMBLY	-	-	-
PLATING	-	-	-
POLISHING	-	NEXT ASSY	USED ON
MACHINING	-		
TOOLING FIXTURE #		REMOVE ALL BURRS AND SHARP EDGES	

UNITS ARE: INCHES [MM]  
TOLERANCES ARE:  
FRACTIONS DECIMALS ANGLES  
±1/16" .X ±.1 [2.5] ±1°  
.xx ±.06 [1.5]  
(X.xxx) DENOTES CRITICAL DIMS.  
ALL THREADS ARE CRITICAL  
DRAWN JINSON 03/29/21  
CHECKED R.S. 03/29/21  
APPROVED R.S. 03/29/21

**BRASSTECH** 2001 CARNEGIE AVE. SANTA ANA, CA 92705 (949) 417-5207  
 INCORPORATED

**PREP/BAR PULL DOWN**  
 DWG NO. 3190-5223 REV E  
 SCALE .200 REF. - SHEET 1 OF 2

