

NOTES:

1. TO INSPECT ASSEMBLY, FOLLOW FIRST ARTICLE AND IN PROCESS INSPECTION SHEET.

2 APPLY LIGHT FILM OF DOW CORNING 111 SILICONE COMPOUND.

3 APPLY LOCTITE 242.

4 INSTALLATION TORQUE: 8-14 LB-FT

5 APPLY LOCTITE 680.

6 APPLY 15-18 IN-LBS TORQUE.

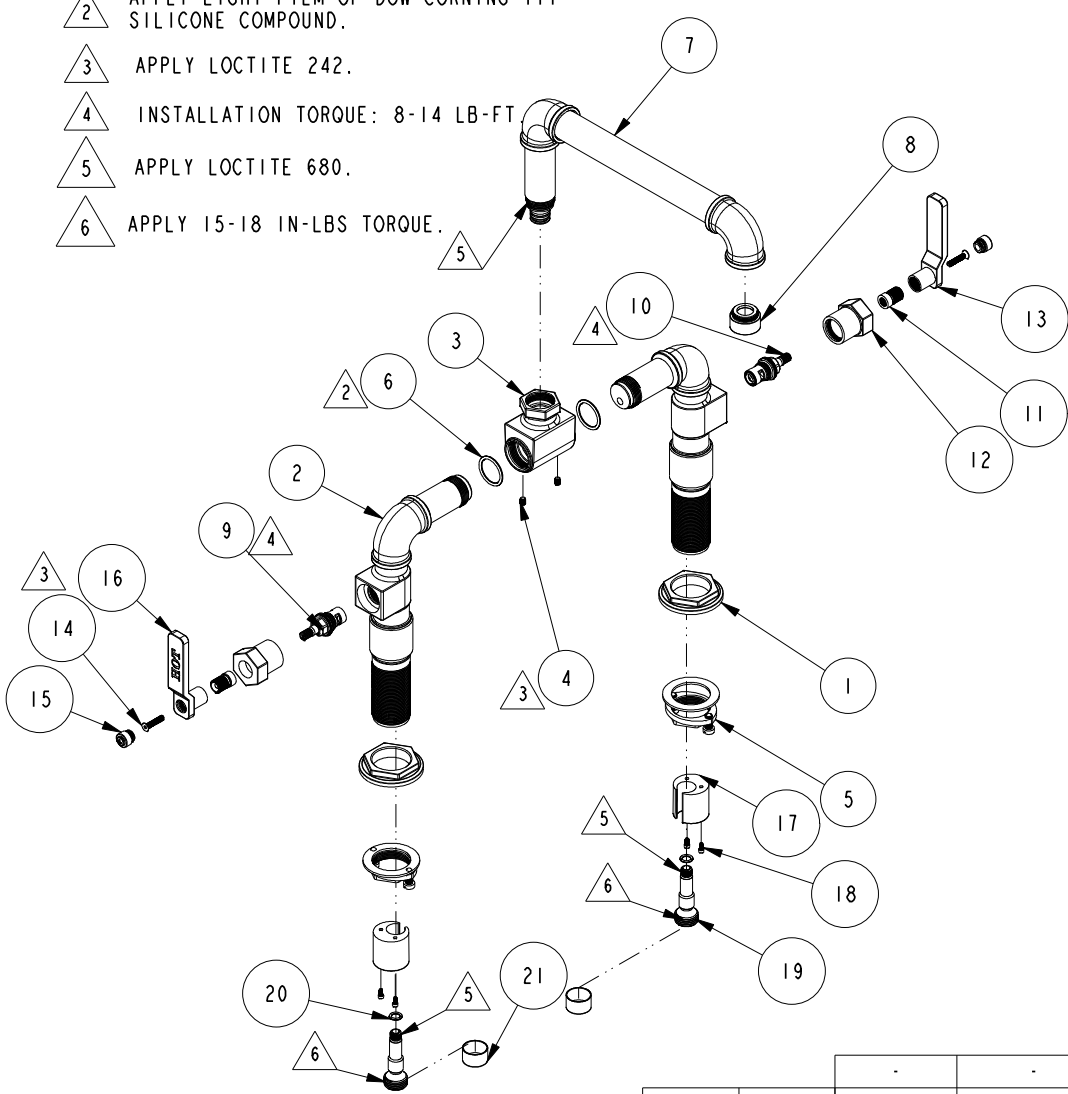

BILL OF MATERIAL (CURRENT LEVEL)

| ITEM | PT/ASSY | DESCRIPTION | TYPE | QTY. |
|------|---------|---|----------|------|
| 1 | 20-344 | ESCUTCHEON ASM | ASSEMBLY | 2 |
| 2 | 20-343 | BODY ASM | ASSEMBLY | 2 |
| 3 | 12947 | TEE JOINT BODY | PART | 1 |
| 4 | 92013 | SCRW, 10-24 X 1/4 SKT HD FLT PT SS | PART | 2 |
| 5 | 1-256 | MOUNTING KIT | ASSEMBLY | 2 |
| 6 | 91288 | O-RING, #2-119, EPDM, 65-75 DURO | PART | 2 |
| 7 | 20-342 | SPOUT ASM | ASSEMBLY | 1 |
| 8 | 20-332 | AERATOR ASM | ASSEMBLY | 1 |
| 9 | 1-436 | CARTR 3/8 COLD 1/4 TR | PART | 1 |
| 10 | 1-437 | CARTR 3/8 HOT 1/4 TR | PART | 1 |
| 11 | 12750 | ADAPTER | PART | 2 |
| 12 | 12910 | BONNET | PART | 2 |
| 13 | 12908 | HANDLE LEVER - COLD | PART | 1 |
| 14 | 92539 | SCRW, M4X22 FLAT HD SOCKET HD CAP | PART | 2 |
| 15 | 20-333 | DECO NUT ASM | ASSEMBLY | 2 |
| 16 | 12909 | HANDLE LEVER - HOT | PART | 1 |
| 17 | 13207 | SINGLE HOSE SLEEVE | PART | 2 |
| 18 | 92431 | SCRW, 4-40 X 1/4 SKT HD CAP SS | PART | 4 |
| 19 | 13355 | M10 CONNECTOR (SHORT) | PART | 2 |
| 20 | 91255 | O-RING, #2- 011, EPDM, 65-75 DURO, NSF-61 | PART | 2 |
| 21 | 13361 | 3/8" THREAD CAP | PART | 2 |

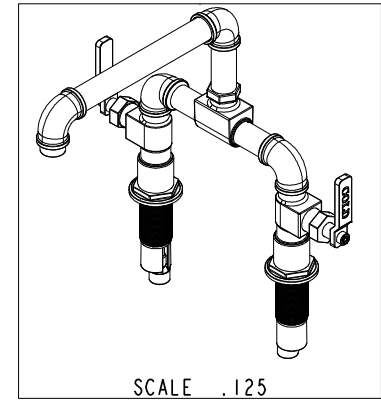

| | | | |
|-------------------|----------------------------------|-------------|---------|
| TESTING | - | - | - |
| ASSEMBLY | - | - | - |
| PLATING | - | - | - |
| POLISHING | - | NEXT ASSY | USED ON |
| MACHINING | - | APPLICATION | |
| TOOLING FIXTURE # | REMOVE ALL BURRS AND SHARP EDGES | | |

UNITS ARE: INCHES [MM]
 TOLERANCES ARE:
 FRACTIONS DECIMALS ANGLES
 ±1/16" .X ±.1 [2.5] ±1°
 .XX ±.06 [1.5]
 (X.XXX) DENOTES CRITICAL DIMS.
 ALL THREADS ARE CRITICAL
 DRAWN JIMSON 09/18/18
 CHECKED J.M. 09/18/18
 APPROVED J.M. 09/18/18

BRASSTECH 2001 CARNEGIE AVE.
 INCORPORATED SANTA ANA, CA 92705
 (949) 417-5207

KITCHEN BRIDGE FAUCET

| | | | | | |
|------|-----|-------------|----------|----------|--|
| - | E | EN-4300f | 02/24/21 | R. S. | COPYRIGHT 2005 BRASSTECH, INC. THESE DRAWINGS AND THE DESIGNS DEPICTED HEREIN ARE THE PROPRIETARY PROPERTY OF BRASSTECH. ANY USE OR REPRODUCTION IS SUBJECT TO THE EXPRESS APPROVAL OF BRASSTECH. UNAUTHORIZED USE IS STRICTLY PROHIBITED. ALL RIGHTS RESERVED. |
| - | D | EN-4062 | 01/06/20 | J. M. | |
| - | C | EN-4019 | 11/18/19 | J. M. | |
| ZONE | REV | DESCRIPTION | DATE | APPROVED | |

| | | | |
|---------|-----------|------|---|
| DWG NO. | 3220-5403 | REV | E |
| SCALE | .150 | REF. | - |
| SHEET | 1 | OF | 2 |

