

NOTES:

1. TO INSPECT ASSEMBLY, FOLLOW FIRST ARTICLE AND IN PROCESS INSPECTION SHEET.

2. APPLY LOCTITE 680 AT 30 IN-LB TORQUE.

BILL OF MATERIAL (CURRENT LEVEL)

ITEM	PT/ASSY	DESCRIPTION	TYPE	QTY.
1	1-206	HARDWARE PACK	ASSEMBLY	1
2	10615	HEX KEY, 3MM ALLOY STEEL	PART	1
3	40506	POST, TOWEL BAR	PART	1
4	40512	ARM - SINGLE POST TOILET TISSUE HOLDER	PART	1
5	92031	SCRW, M6 X 1 X 6 SKT HD CUP PT SS	PART	1
6	92527	SCRW, 8-32 X 3/8 SKT CAP HD SS	PART	1
7	92914	MOUNTING BRACKET	PART	1

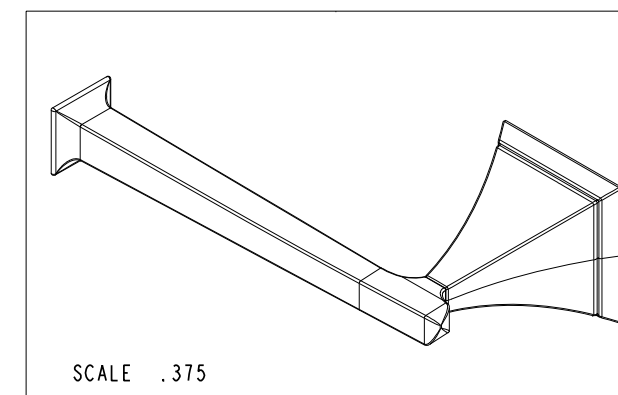
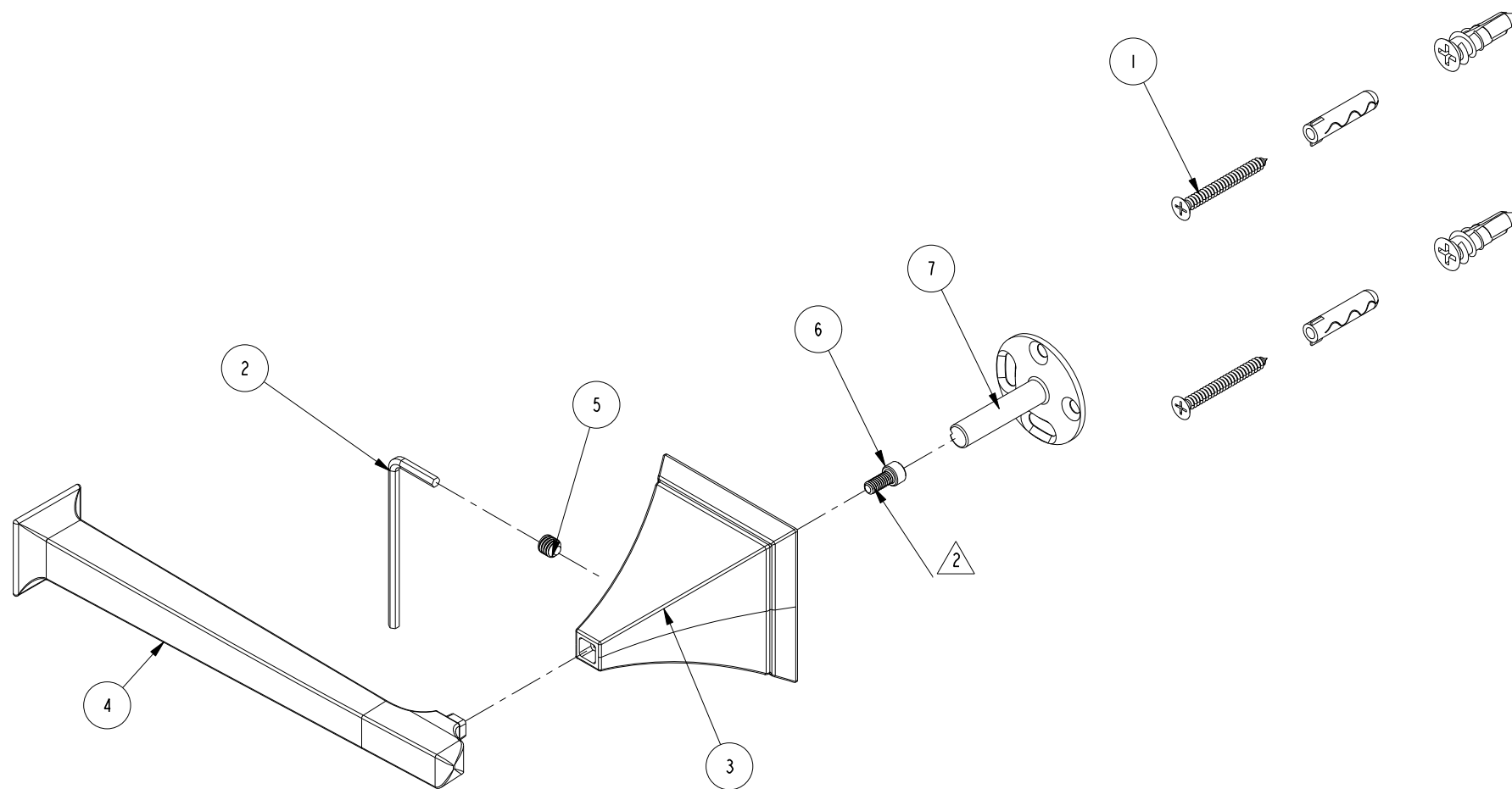

REV	DESCRIPTION	DATE	APPROVED
C	EN-4263-1	01/30/23	J.M.
B	EN-4032	12/04/19	R.S.
A	EN-3162	10/11/16	J.M.
-	EN-2087	09/20/13	J.M.

COPYRIGHT 2005 BRASSTECH, INC. THESE DRAWINGS AND THE DESIGNS DEPICTED HEREIN ARE THE PROPRIETARY PROPERTY OF BRASSTECH. ANY USE OR REPRODUCTION IS SUBJECT TO THE EXPRESS APPROVAL OF BRASSTECH. UNAUTHORIZED USE IS STRICTLY PROHIBITED. ALL RIGHTS RESERVED.

-	-	UNITS ARE: INCHES [MM]	BRASSTECH 2001 CARNEGIE AVE. INCORPORATED SANTA ANA, CA 92705 (949) 417-5207
-	-	TOLERANCES ARE:	
-	-	FRACTIONS DECIMALS ANGLES $\pm 1/16"$.x $\pm .1$ [2.5] .xx $\pm .06$ [1.5] $\pm 1"$	
-	-	X.XXX DENOTES CRITICAL DIMS. ALL THREADS ARE CRITICAL	
NEXT ASSY	USED ON	DRAWN	DWG NO. 41-27
APPLICATION	CHECKED	APPROVED	REV C
REMOVE ALL BURRS AND SHARP EDGES	APPROVED	SCALE .500	REF. - SHEET 1 OF 2

