

NOTES:

(N1) 1. TO INSPECT ASSEMBLY, FOLLOW FIRST ARTICLE AND IN PROCESS INSPECTION SHEET.

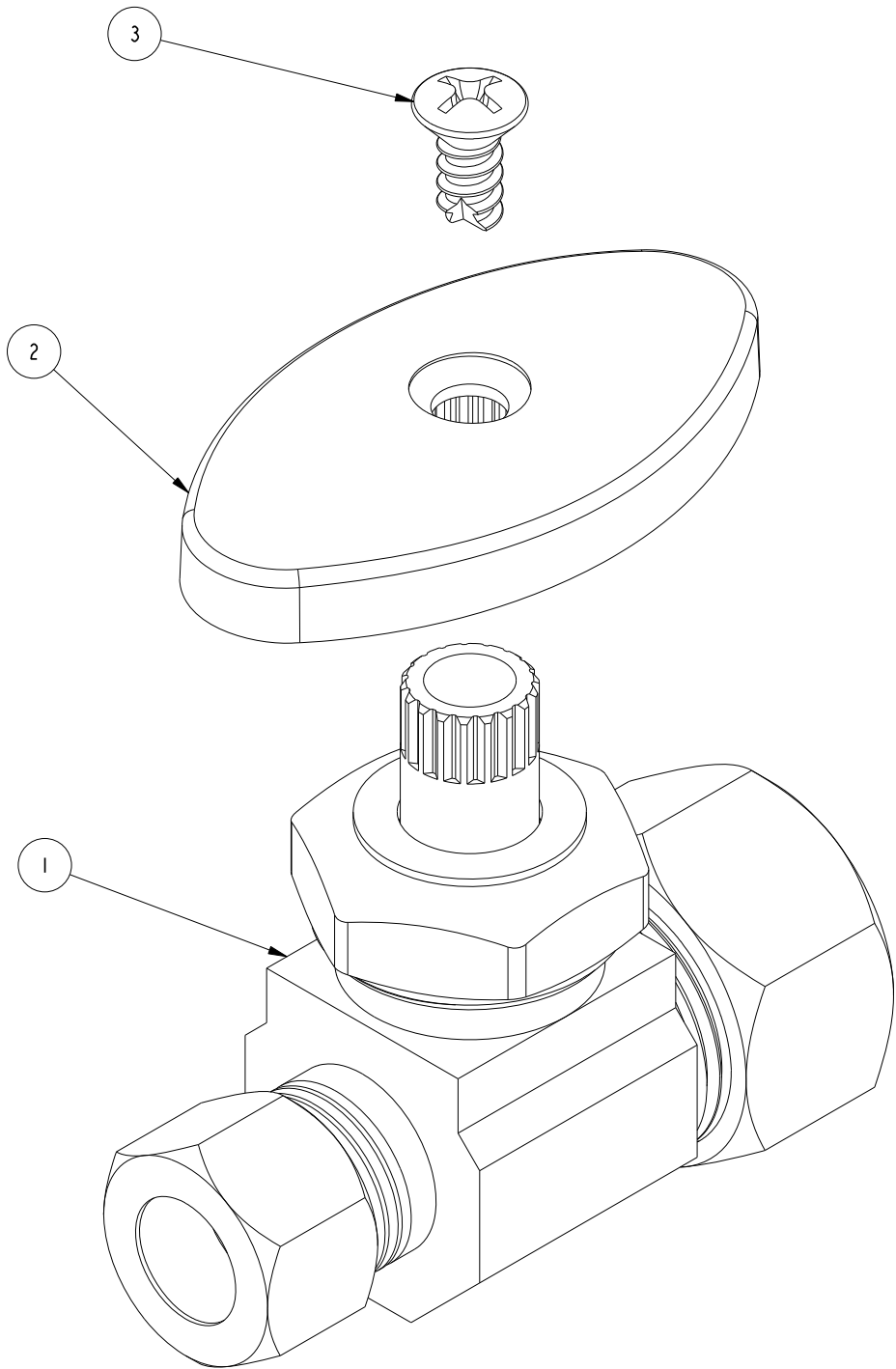

BILL OF MATERIAL (CURRENT LEVEL)				
ITEM	PT/ASSY	DESCRIPTION	TYPE	QTY.
1	6-412	S.V. 1/2" CU X 3/8" CMP	ASSEMBLY	1
2	50355	HANDLE	PART	1
3	92073	SCREW #0 X 3/8" PHIL OVAL HD BRASS	PART	1

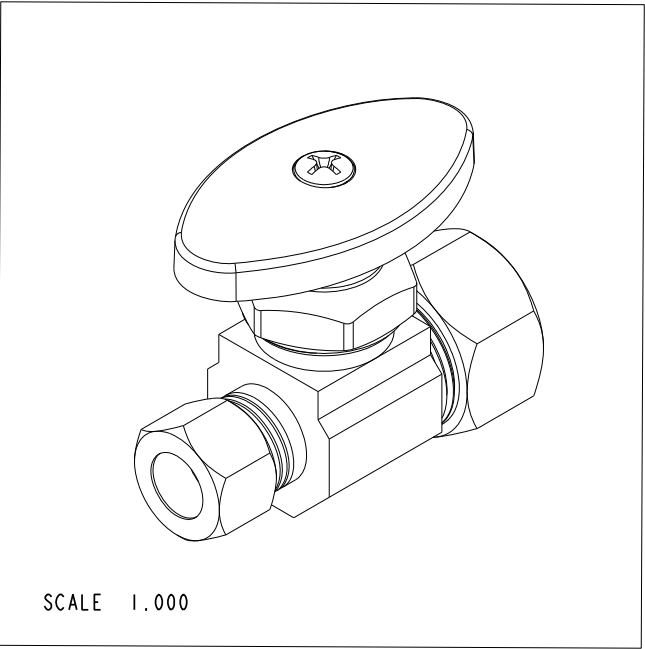

B	EN-4946	02/07/25	R.S.
A	EN-4407	10/11/21	N.S.
-	EN-2537	05/17/13	J.M.
REV	DESCRIPTION	DATE	APPROVED

COPYRIGHT 2005 BRASSTECH, INC.  
THESE DRAWINGS AND THE DESIGNS  
DEPICTED HEREIN ARE THE PROPRIETARY  
PROPERTY OF BRASSTECH. ANY USE  
OR REPRODUCTION IS SUBJECT TO  
THE EXPRESS APPROVAL OF BRASSTECH.  
UNAUTHORIZED USE IS STRICTLY  
PROHIBITED. ALL RIGHTS RESERVED.

-	-	UNITS ARE: INCHES [MM]		<b>BRASSTECH</b> 2001 CARNEGIE AVE. SANTA ANA, CA 92705 (949) 417-5207	
-	-	TOLERANCES ARE:			
-	-	FRACTIONS	DECIMALS		
-	-	±1/16"	±.001		
-	-	ANGLES		±1°	
-	-	±.001			
-	-	±.001		±.001	
-	-	±.001			
NEXT ASSY		USED ON		DWG NO.	
APPLICATION		CHECKED		REV	
REMOVE ALL BURRS AND SHARP EDGES		APPROVED		B	
		N. SANTOS		412	
		N. SANTOS		SCALE 2.000	
		10/11/21		REF. -	
				SHEET 1 OF 3	