

NOTES:

1. TO INSPECT ASSEMBLY, FOLLOW FIRST ARTICLE AND IN PROCESS INSPECTION SHEET.

BILL OF MATERIAL (CURRENT LEVEL)

ITEM	PT/ASSY	DESCRIPTION	TYPE	QTY.
1	1-525	W/S VALVE ASM	ASSEMBLY	1
2	3-358	WIDE SPREAD SPOUT	ASSEMBLY	1
3	10016	ESCUTCHEON BELL	PART	2
4	30070	POP-UP ROD	PART	1
5	10289	POP-UP KNOB	PART	1
6	91753	O-RING, # 2-136, EP, 50 DURO - GREY	PART	2
7	325	POP UP ASSEMBLY	ASSEMBLY	1

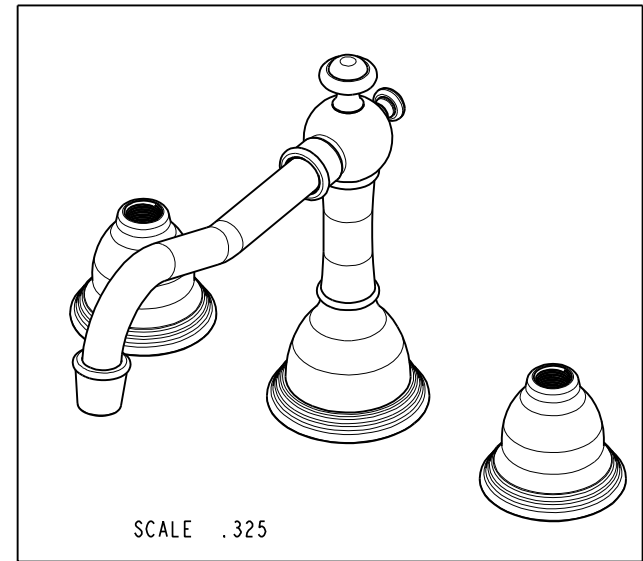
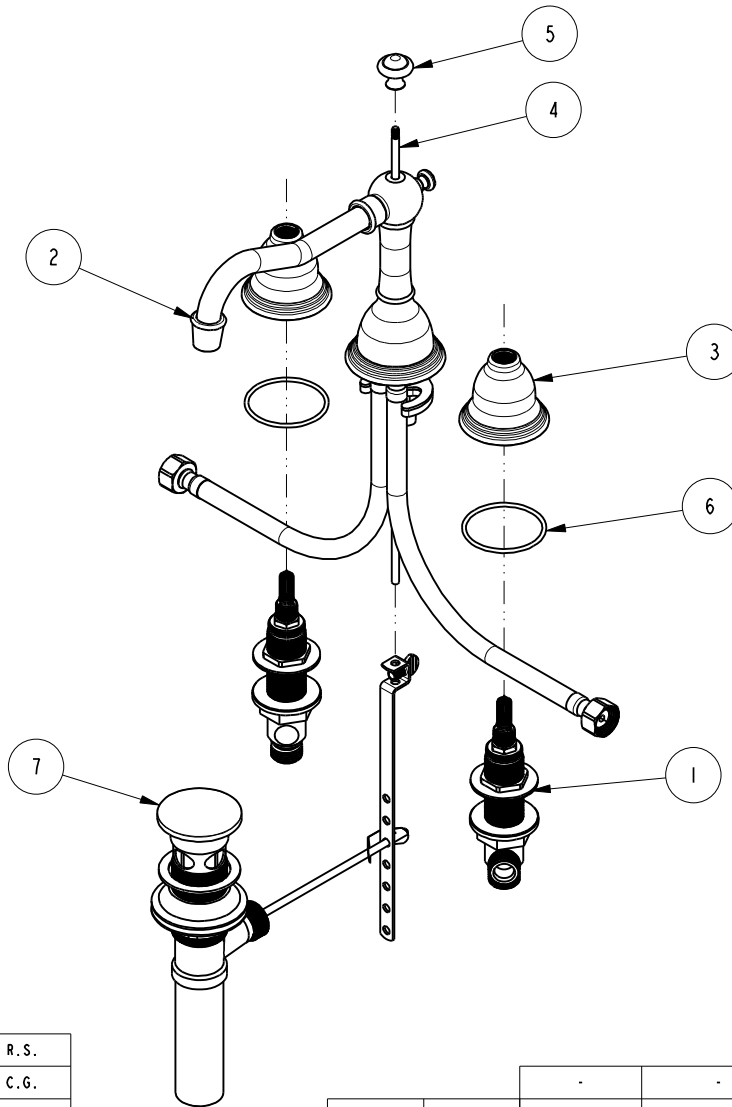

ZONE	REV	DESCRIPTION	DATE	APPROVED
-	F	EN-4300m	11/10/20	R.S.
-	E	EN-3722	02/08/19	C.G.
-	D	EN-2348b	12/20/13	-
-	C	EN-2553	07/02/13	-
-	B	EN-1616	09/13/10	-
-	A	EO-1047	08/07/08	-
-	-	EO-0554	08/15/05	-

COPYRIGHT 2005 BRASSTECH, INC. THESE DRAWINGS AND THE DESIGNS DEPICTED HEREIN ARE THE PROPRIETARY PROPERTY OF BRASSTECH. ANY USE OR REPRODUCTION IS SUBJECT TO THE EXPRESS APPROVAL OF BRASSTECH. UNAUTHORIZED USE IS STRICTLY PROHIBITED. ALL RIGHTS RESERVED.

TESTING	ASSEMBLY	PLATING	POLISHING	MACHINING	TOOLING FIXTURE #
-	-	-	-	-	-
-	-	-	-	-	-
-	-	-	-	-	-
-	-	-	-	-	-
-	-	-	-	-	-
-	-	-	-	-	-
-	-	-	-	-	-
-	-	-	-	-	-
-	-	-	-	-	-
-	-	-	-	-	-
-	-	-	-	-	-

UNITS ARE: INCHES [MM]	
TOLERANCES ARE:	
FRACTIONS DECIMALS	ANGLES
±1/16"	±°
.X ±.1 [2.5]	
.XX ±.06 [1.5]	
(X.XXX) DENOTES CRITICAL DIMS.	
ALL THREADS ARE CRITICAL	
DRAWN	JINSON
	11/10/20
CHECKED	R.S.
	11/10/20
APPROVED	R.S.
	11/10/20

**BRASSTECH** INCORPORATED  
 2001 CARNEGIE AVE.  
 SANTA ANA, CA 92705  
 (949) 417-5207

**WIDESPREAD**

DWG NO. **7300** REV **F**

SCALE **.200** REF. - SHEET **1** OF **2**

