

NOTES:

1. TO INSPECT ASSEMBLY, FOLLOW FIRST ARTICLE AND IN PROCESS INSPECTION SHEET.

BILL OF MATERIAL (CURRENT LEVEL)

ITEM	PT/ASSY	DESCRIPTION	TYPE	QTY.
1	1-525	W/S VALVE ASM	ASSEMBLY	1
2	3-344	WIDESPREAD SPOUT	ASSEMBLY	1
3	325	POP UP ASSEMBLY	ASSEMBLY	1
4	10010	POP-UP KNOB	PART	1
5	10288	3/16" POP UP ROD	PART	1
6	3-202	TRIM KIT - STOP VALVE	ASSEMBLY	2

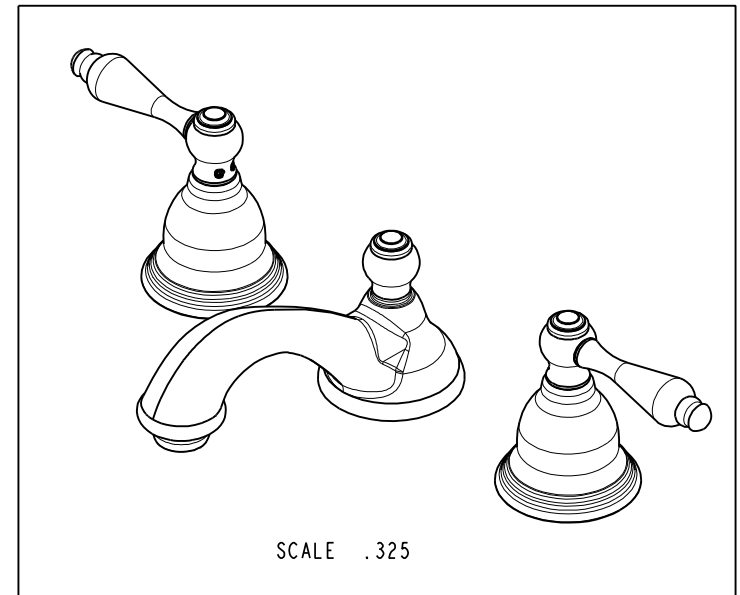
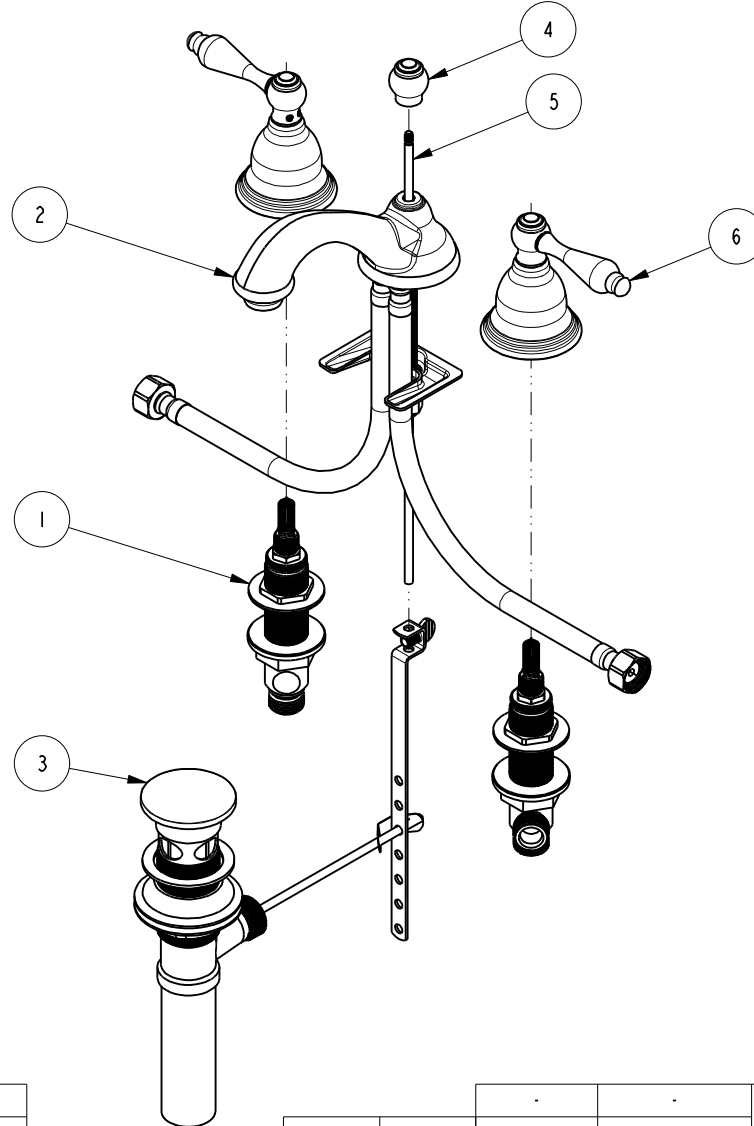

ZONE	REV	DESCRIPTION	DATE	APPROVED
-	F	EN-4300m	11/10/20	R.S.
-	E	EN-3371	08/04/17	J.M
-	D	EN-2553	07/02/13	-
-	C	EN-1616	09/13/10	-
-	B	EO-1005	06/09/08	-
-	A	MOD INLET	04/00	-

COPYRIGHT 2005 BRASSTECH, INC. THESE DRAWINGS AND THE DESIGNS DEPICTED HEREIN ARE THE PROPRIETARY PROPERTY OF BRASSTECH. ANY USE OR REPRODUCTION IS SUBJECT TO THE EXPRESS APPROVAL OF BRASSTECH. UNAUTHORIZED USE IS STRICTLY PROHIBITED. ALL RIGHTS RESERVED.

TESTING	ASSEMBLY	PLATING	POLISHING	MACHINING	TOOLING FIXTURE #	APPLICATION
-	-	-	-	-	-	REMOVE ALL BURRS AND SHARP EDGES
-	-	-	-	-	-	USED ON
-	-	-	-	-	-	APPLICATION

UNITS ARE: INCHES [MM]		
TOLERANCES ARE:		
FRACTIONS DECIMALS	ANGLES	
±1/16"	.X ±.1 [2.5]	±1°
	.XX ±.06 [1.5]	
X.XXX DENOTES CRITICAL DIMS.		
ALL THREADS ARE CRITICAL		
DRAWN	JINSON	11/09/20
CHECKED	R.S.	11/09/20
APPROVED	R.S.	11/09/20

BRASSTECH 2001 CARNEGIE AVE. SANTA ANA, CA 92705 (949) 417-5207
INCORPORATED

WIDESPREAD FAUCET

DWG NO. **850** REV **F**

SCALE .225 REF. - SHEET 1 OF 2

