

NOTES:

1. TO INSPECT ASSEMBLY, FOLLOW FIRST ARTICLE AND IN PROCESS INSPECTION SHEET.

BILL OF MATERIAL (CURRENT LEVEL)

| ITEM | PT/ASSY | DESCRIPTION | TYPE | QTY. |
|------|---------|-------------------|----------|------|
| 1 | 3-910 | WIDESPREAD FAUCET | ASSEMBLY | 1 |
| 2 | 1-525 | W/S VALVE ASM | ASSEMBLY | 1 |

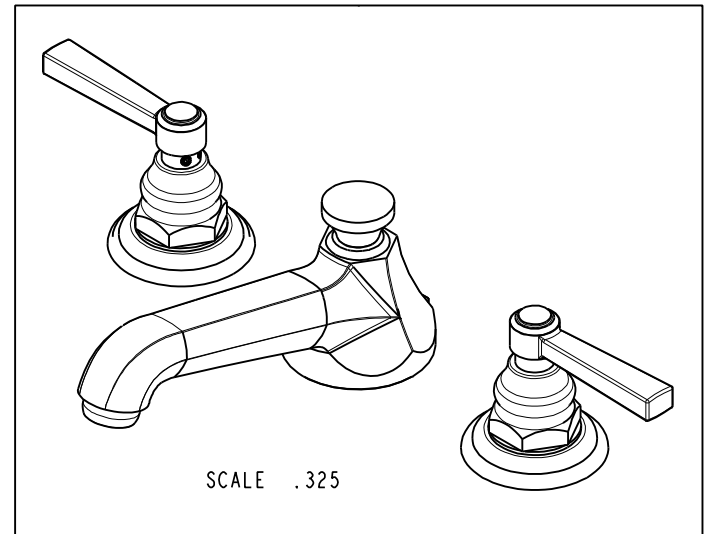
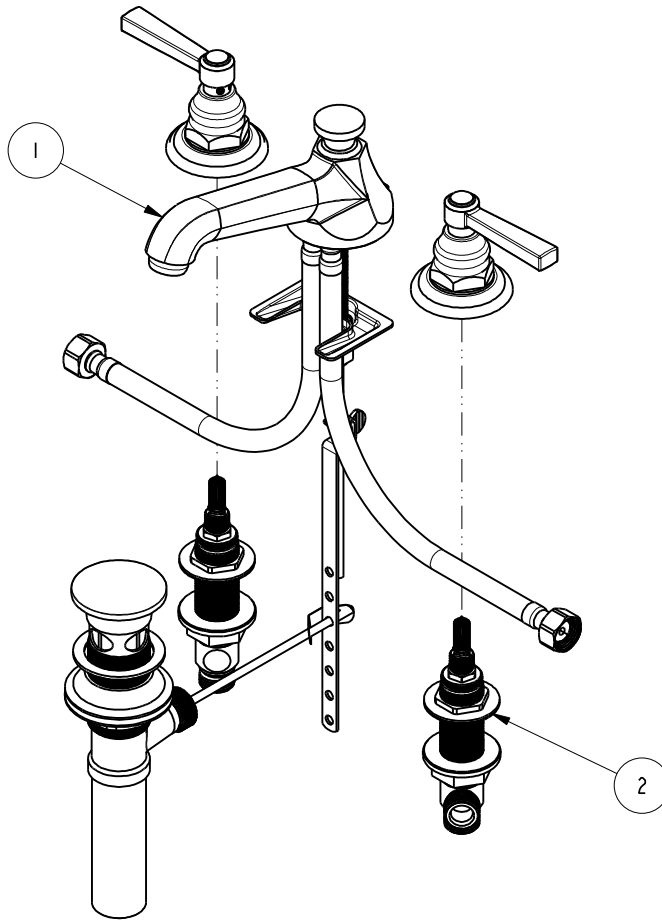

| ZONE | REV | DESCRIPTION | DATE | APPROVED |
|------|-----|-------------|----------|----------|
| - | E | EN-4300m | 11/12/20 | R.S. |
| - | D | EN-4286 | 11/04/20 | C.G. |
| - | C | EN-3722 | 02/08/19 | C.G. |
| - | B | EN-3371 | 08/04/17 | J.M. |
| - | A | EN-2621b | 02/28/14 | - |
| - | - | EN-2621 | 11/21/13 | - |

COPYRIGHT 2005 BRASSTECH, INC. THESE DRAWINGS AND THE DESIGNS DEPICTED HEREIN ARE THE PROPRIETARY PROPERTY OF BRASSTECH. ANY USE OR REPRODUCTION IS SUBJECT TO THE EXPRESS APPROVAL OF BRASSTECH. UNAUTHORIZED USE IS STRICTLY PROHIBITED. ALL RIGHTS RESERVED.

| TESTING | ASSEMBLY | PLATING | POLISHING | MACHINING | TOOLING FIXTURE # | APPLICATION |
|---------|----------|---------|-----------|-----------|-------------------|----------------------------------|
| - | - | - | - | - | - | REMOVE ALL BURRS AND SHARP EDGES |
| - | - | - | - | - | - | USED ON |
| - | - | - | - | - | - | APPLICATION |

| | | |
|---|----------------|----------|
| UNITS ARE: INCHES [MM] | | |
| TOLERANCES ARE: | | |
| FRACTIONS | DECIMALS | ANGLES |
| ±1/16" | .X ±.1 [2,5] | ±1° |
| | .XX ±.06 [1,5] | |
| ⓧ.XXX DENOTES CRITICAL DIMS. ALL THREADS ARE CRITICAL | | |
| DRAWN | JINSON | 11/12/20 |
| CHECKED | R.S. | 11/12/20 |
| APPROVED | R.S. | 11/12/20 |

| | | | |
|-------------------|------|---|---|
| BRASSTECH | | 2001 CARNEGIE AVE. SANTA ANA, CA 92705 (949) 417-5207 | |
| INCORPORATED | | | |
| WIDESPREAD FAUCET | | | |
| DWG NO. | 910 | REV | E |
| SCALE | .225 | REF. | - |
| SHEET | 1 | OF | 2 |

