

NOTES:

1. TO INSPECT ASSEMBLY, FOLLOW FIRST ARTICLE AND IN PROCESS INSPECTION SHEET.

2. APPLY LOCTITE 680.

3. TIGHTEN TO 14-16 FT-LBS OF TORQUE.

4. APPLY LABEL #98044

5. APPLY LABEL #98109 TO BACKSIDE OF BASE

6. APPLY LIGHT FILM OF SUPPER LUBE GREASE OR EQUIVALENT BETWEEN ITEMS 5 AND 6.

7. APPLY GORILLA SUPPER GLUE IMPACT-TOUGH FORMULA.

8. APPLY LOCTITE 680 AND SNUG FIT WHEN ASSEMBLED (INSTALLATION TORQUE MUST BE 17 TO 20 IN-LB).

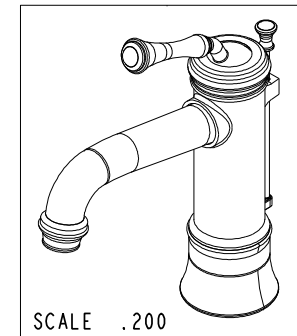
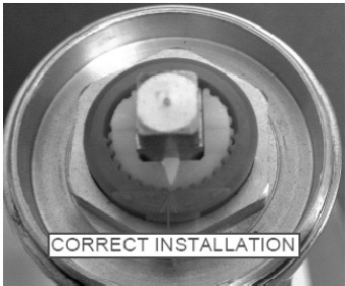
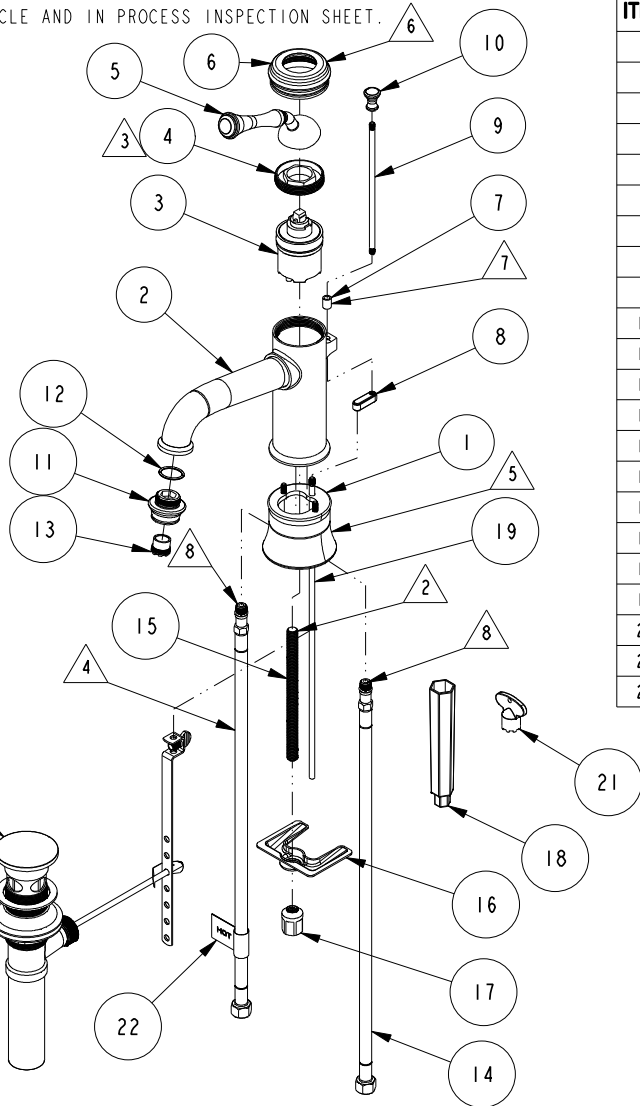

BILL OF MATERIAL (CURRENT LEVEL)

ITEM	PT/ASSY	DESCRIPTION	TYPE	QTY.
1	2-621	SPOUT BASE ESC ASM	ASSEMBLY	1
2	8-065	LAVATORY FAUCET SPOUT ASM	ASSEMBLY	1
3	1-588	CARTRIDGE, SLEEVE ASM	ASSEMBLY	1
4	11340	CARTRIDGE PACKING NUT	PART	1
5	2-623	SINGLE LEVER HANDLE ASM	ASSEMBLY	1
6	2-624	CAP NUT ASSEMBLY	ASSEMBLY	1
7	11339	POP UP ROD BUSHING	PART	1
8	80166	POP UP ROD LINK	PART	1
9	11341	3/16" POP UP ROD	PART	1
10	11579	POP UP ROD KNOB	PART	1
11	11576	AERATOR SHELL	PART	1
12	91022	O-RING, #2- 018, EPDM, 65-75 DURO, NSF 61	PART	1
13	12405	CACHE AERATOR INSERT, TT SIZE, 1.2 GPM	PART	1
14	11892	SUPPLY LINE CONNECTOR ASM	PART	2
15	11281	MOUNTING STUD	PART	1
16	11280	MOUNTING BRACKET	PART	1
17	11285	MOUNTING NUT	PART	1
18	92297	INSTALLATION TOOL, WRENCH	PART	1
19	10288	3/16" POP UP ROD	PART	1
20	325	POP UP ASSEMBLY	ASSEMBLY	1
21	91379	AERATOR KEY	PART	1
22	98044	LABEL - HOT	PART	1

-	H	EN-4300m	02/05/21	R.S.
-	G	EN-3404	09/20/17	V.VU
-	F	EN-2896c	05/24/16	J.A
-	E	EN-2643	01/15/16	J.M
-	D	EN-2639	11/14/13	-
-	C	EN-2503	04/17/13	-
-	B	EN-2119	07/24/12	-
-	A	EN-1489	02/22/10	-
-	-	EN-1291	11/12/09	-
ZONE	REV	DESCRIPTION	DATE	APPROVED

COPYRIGHT 2005 BRASSTECH, INC. THESE DRAWINGS AND THE DESIGNS DEPICTED HEREIN ARE THE PROPRIETARY PROPERTY OF BRASSTECH. ANY USE OR REPRODUCTION IS SUBJECT TO THE EXPRESS APPROVAL OF BRASSTECH. UNAUTHORIZED USE IS STRICTLY PROHIBITED. ALL RIGHTS RESERVED.

TESTING	-	-	-
ASSEMBLY	-	-	-
PLATING	-	-	-
POLISHING	-	NEXT ASSY	USED ON
MACHINING	-	APPLICATION	
TOOLING FIXTURE #	REMOVE ALL BURRS AND SHARP EDGES		

UNITS ARE: INCHES [MM]			
TOLERANCES ARE:			
FRACTIONS	DECIMALS	ANGLES	
±1/16"	.X ±.1 [2.5]	±1°	
	.XX ±.06 [1.5]		
(X.XXX) DENOTES CRITICAL DIMS. ALL THREADS ARE CRITICAL			
DRAWN	JINSON	09/20/17	
CHECKED	RAVINDRA	09/20/17	
APPROVED	V.VU	09/20/17	

BRASSTECH		2001 CARNEGIE AVE. SANTA ANA, CA 92705 (949) 417-5207	
INCORPORATED			
SINGLE HOLE NEWPORT COLUMNAR			
DWG NO.	9203	REV	H
SCALE	.150	REF.	-
SHEET	1	OF	2

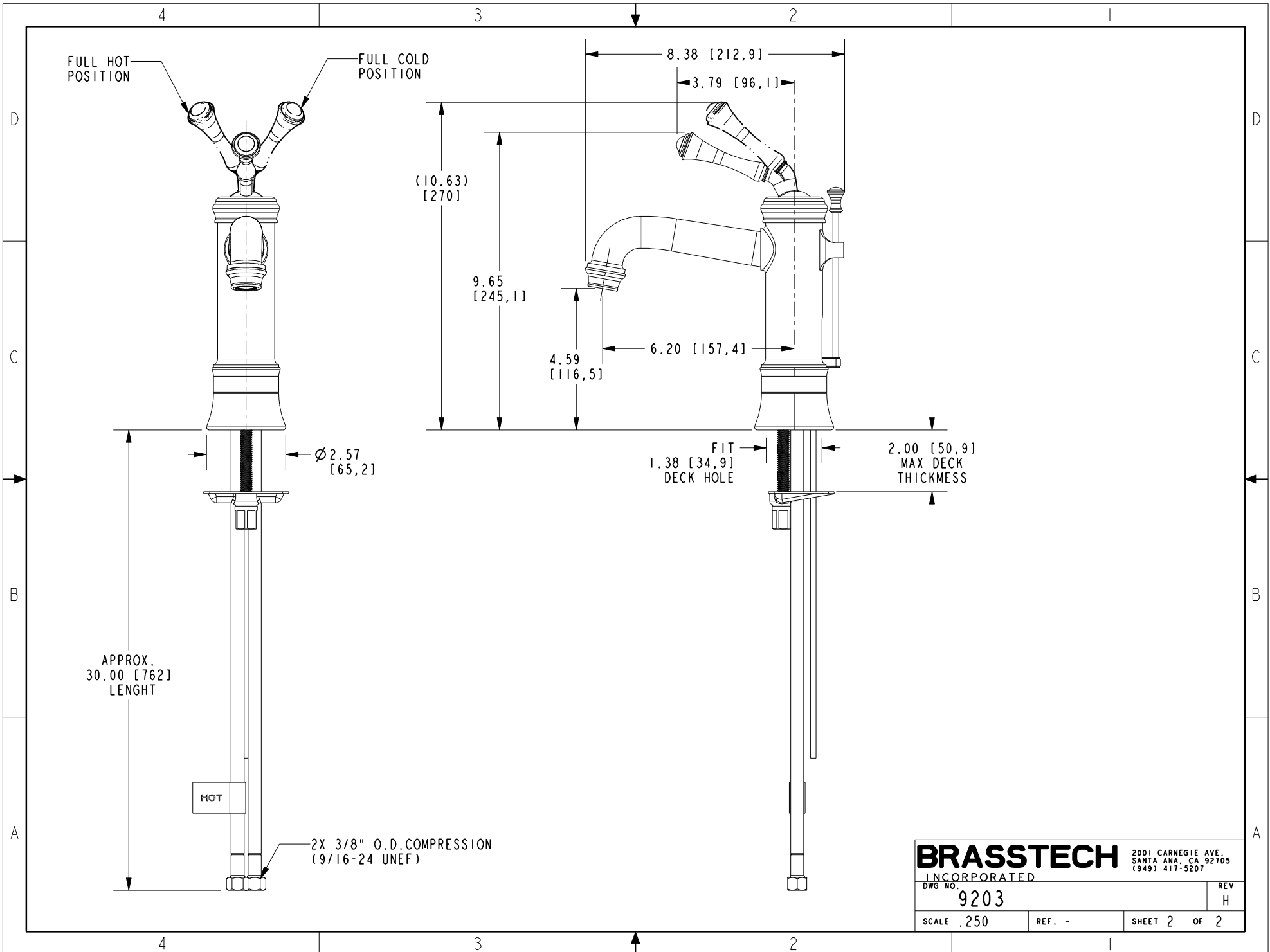

BRASSTECH
 INCORPORATED
 2001 CARNEGIE AVE.
 SANTA ANA, CA 92705
 (949) 417-5207

DWG NO.	9203	REV	H
SCALE	.250	REF.	-
SHEET 2		OF 2	