

NEWPORT BRASS®

Flawless Beauty. From Faucet to Finish.™

Installation Instructions

Rough-In Kit for Exposed Tub Sets

Valve Body No. 1-378

Trim Kit for Model No's when use Floor Mount Kit 3-196 with: 1014, 1020-4283, 1200-4283, 1600-4282, 1620-4283, 1760-4282, 1770-4283, 2400-4282, 2400-4283, 2590-4283, 8500-4283, 910-4283, 920-4282, 934

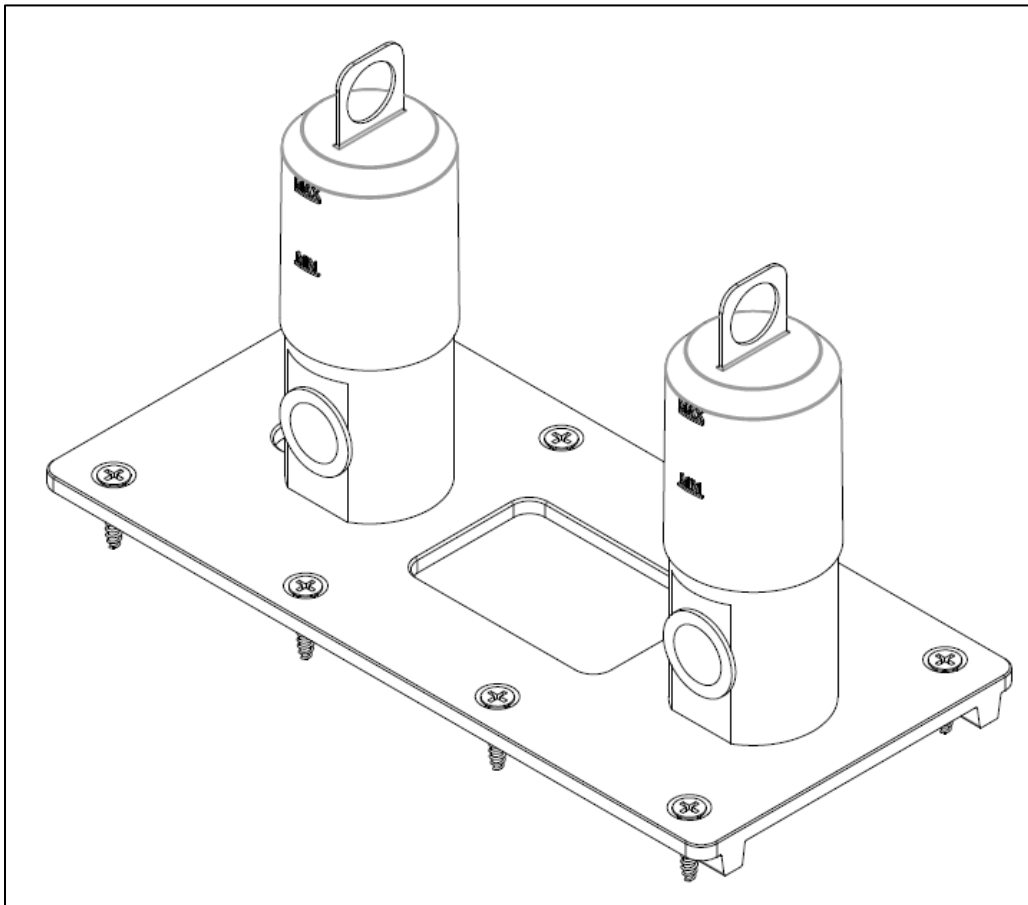

Congratulations on the purchase of this Newport Brass product, an excellent choice, that will give you years of quality service and enhance the look and style of your home.

Recommended Installation by a Professional Plumbing Contractor

Important Notes (please read before installing)

- Recommended water pressure: 45 to 80 psi
- Product is designed to allow for installation in accordance with all national and local plumbing and building codes.
- During floor mounting of this product, extra care should be taken while drilling into the floor to avoid damaging any water supply lines that may exist beneath the floor.
- **NOTE:** Use plumbers tape or equivalent to seal all threaded joints.
- **WARNING:** To prevent severe damage to valve body, any solder/braze process must be performed a min. of 4" from ports.

Rough for Floor Mount Kit Exposed Tub Sets

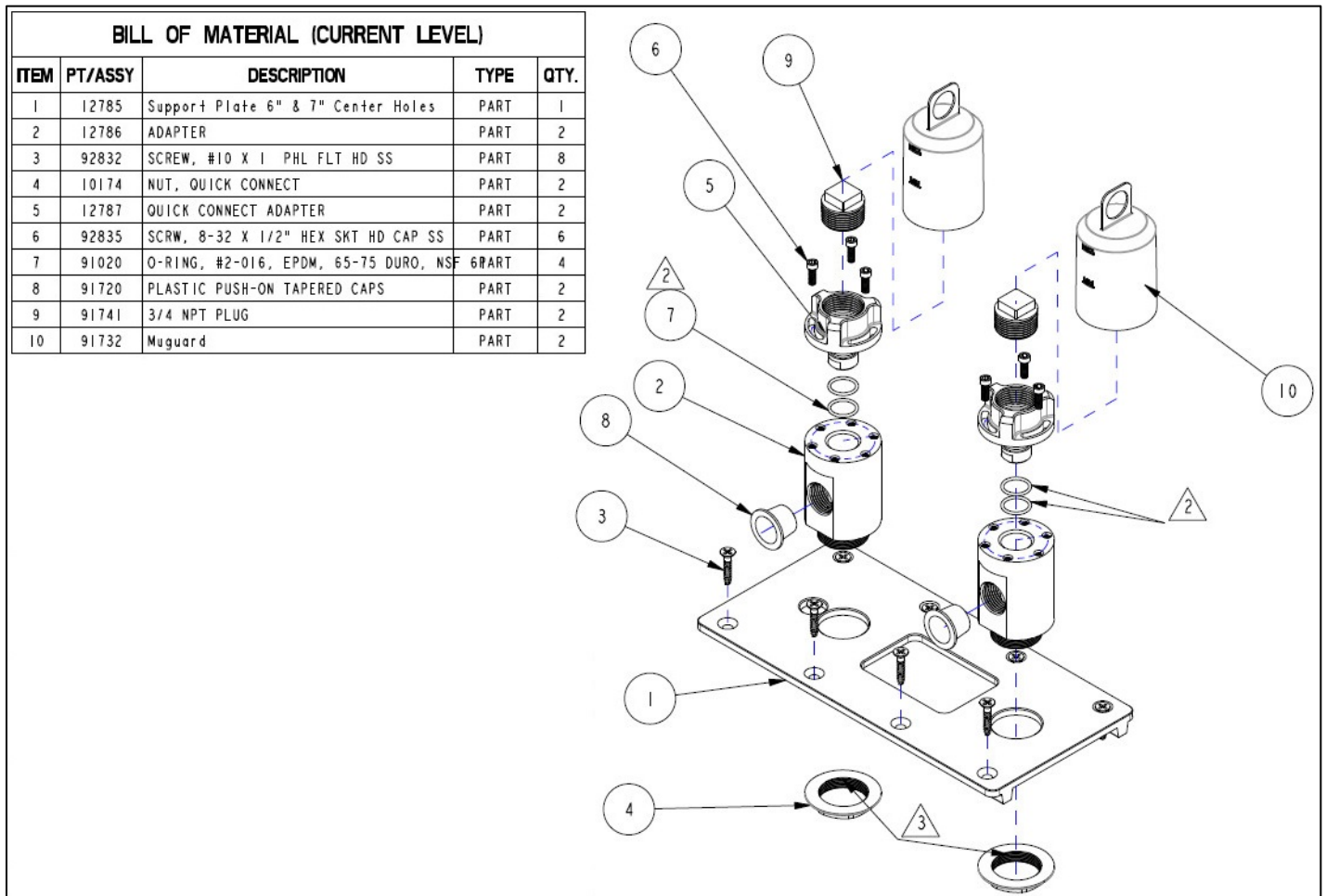

Figure 1: Product Exploded View

Installation Instruction for Wood Joist Support Floor

1. Use a 2" X 8" wood beam to construct a CROSS SUPPORT BRACE as shown in **Figure 2**. Position the CROSS SUPPORT BRACE so its top surface is approximately 4-1/4" from the FINISHED FLOOR. Check the horizontal level by placing a level across the top surface of the CROSS SUPPORT BRACE.
2. Orient the Inlet Fittings of the Rough-In to the water supply source. Use the provided WOOD SCREWS (8X) to attach the Rough-In to the CROSS SUPPORT BRASS.
3. Remove PLUGS from inlets of the Rough-In. Utilize appropriate supply line and 1/2" male thread adapter to connect supply line to the 1/2" NPT inlets of the Rough.
4. Turn on water supply and check for leaks.
5. Installation for the Rough-In Kit is now completed. To install Exposed Tub Sets and Floor Mount Kit, follow installation instructions provided with the Floor Mount Kit 3-196.

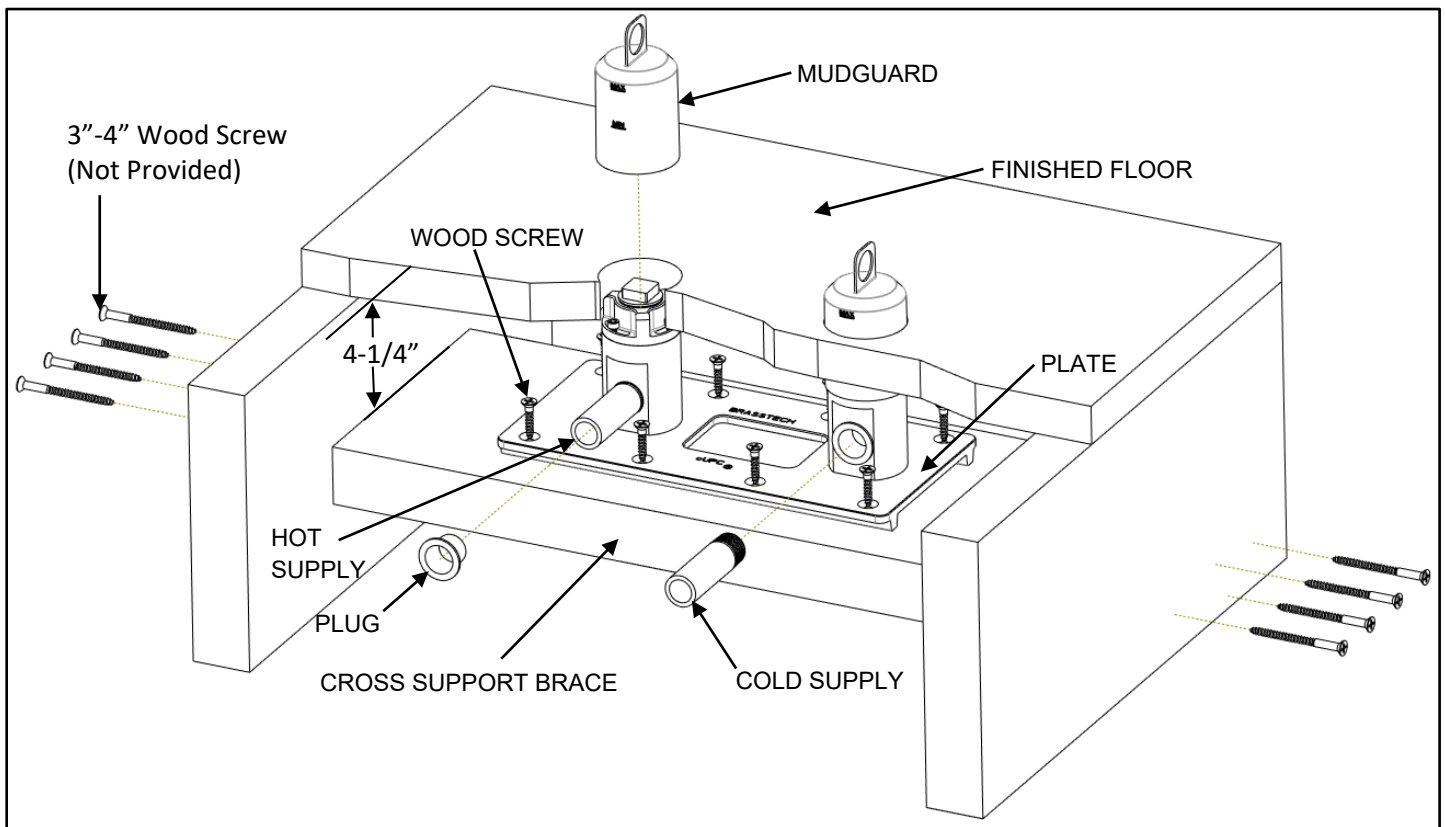

Figure 2: Wood Joist Support Floor Installation

Installation Instruction for Concrete Floor

1. As shown in **Figure 3**, position the rough so that the top surface of PLATE is approximately 3-3/4" from the FINISHED FLOOR
2. Check the horizontal level of the rough by placing a level across the PLATE. Orient the Inlet Fittings of the Rough to the water supply source.
3. Remove PLUGS from Inlets of the Rough. Utilize appropriate supply line and 1/2" male thread adapters to connect supply line to the 1/2" NPT inlets of the Rough.
4. Turn on water supply and check for leaks.
5. Pour concrete and complete the FINISHED FLOOR. Note: Use MUDGUARD to prevent floor material from covering the OUTLET of Rough.
6. Installation for the Rough-In Kit is now completed. To install Exposed Tub Sets and Floor Mount Kit, follow installation instructions provided with the Floor Mount Kit 3-196.

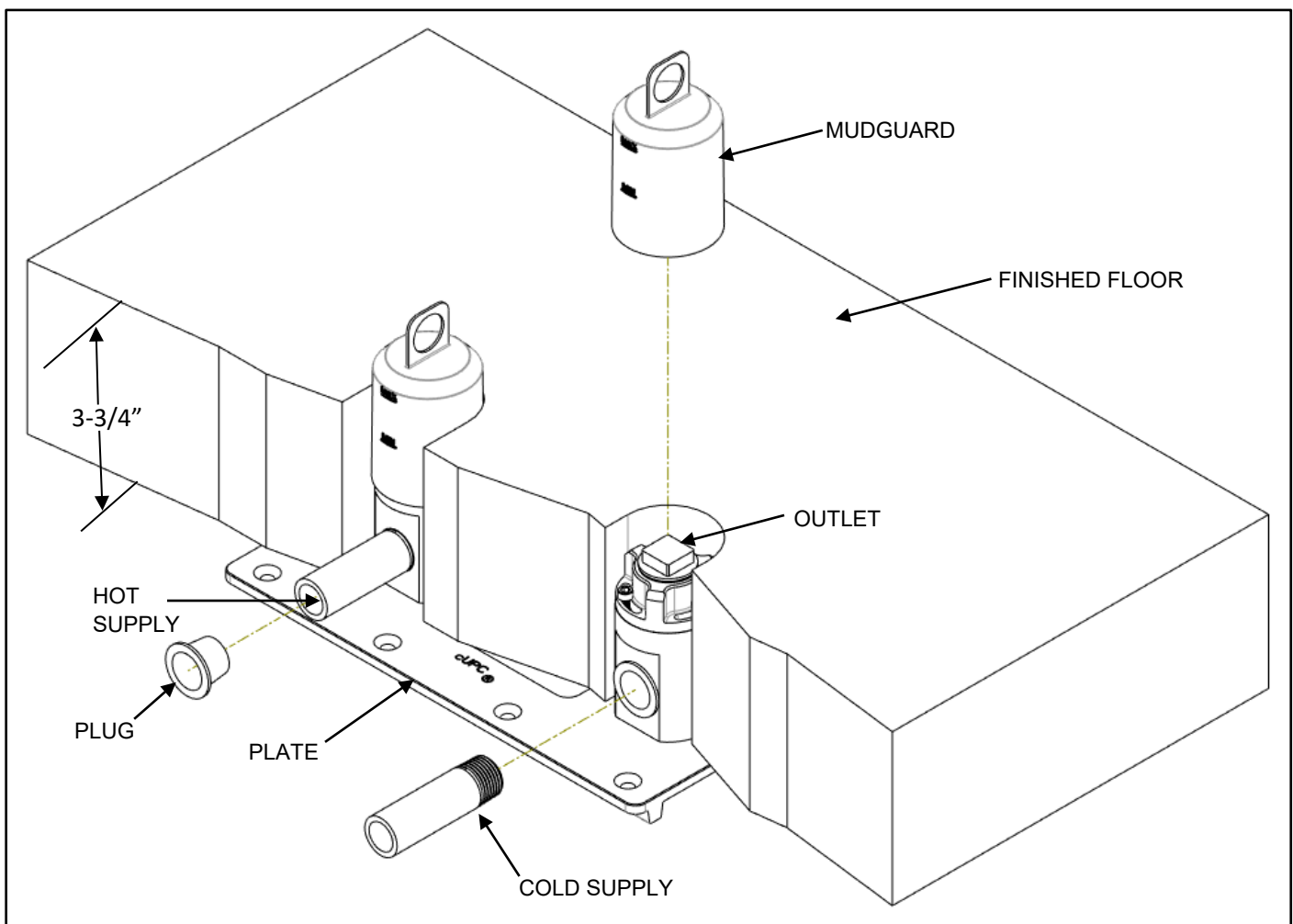

Figure 3: Concrete Floor Installation

LIMITED WARRANTY

Brasstech, Inc. warrants to the original consumer residential purchaser ("Original Purchaser") that if a product in its; Newport Brass®, Brasstech®, motiv®, Newport 365 or GINGER® lines of products ("Product") is confirmed upon inspection to be defective in materials or workmanship during the warranty periods described below, Brasstech, Inc. will, at its option, either repair or replace the Product with a similar current model of the Product. If repair or replacement is not commercially practical or cannot be made in a timely manner, then Brasstech, Inc. will provide a refund for the Product.

WARRANTY PERIODS AND COVERAGE PRODUCT FINISHES

- PVD and Polished Chrome (26) finishes on Products other than Drains and Shower rods are warranted as long as the Original Purchaser owns their home.
- "Living" finishes have no warranty*. These include 03N & 08W.
- Shower rods, porcelain parts and glass parts have no finish warranty.
- Mirror products will be warranted from desilvering for two (2) years from the date of purchase by the original purchaser as long as desilvering is not due to chemical contact. See maintenance section for proper cleaning instructions.
- All other finishes are warranted for ten (10) years from date of purchase by the Original Purchaser.

DRAIN FINISHES

- Polished Chrome (26) and PVD finishes on kitchen, bath or lavatory drains including drain baskets and components are warranted for one (1) year from date of purchase by the Original Purchaser.
- All other Drain finishes have no warranty.

FUNCTIONALITY

- All Product parts except valves are warranted for ten (10) years from date of purchase by the Original Purchaser.
- Ceramic disc valves for the lavatory faucet, tub/ shower and roman tub are warranted for as long as the Original Purchaser owns the home.
- All other valves (balance pressure, thermostatic, etc.) are warranted for one (1) year from date of purchase by the Original Purchaser.
- Lights have no functional warranty. Soap / Lotion pump mechanisms are warranted for one (1) year from date of purchase by the Original Purchaser. Shower rods, porcelain parts and glass parts have no functional warranty.
- Hot water tanks are warranted for one (1) year from the date of purchase by the original purchaser.

EXCLUSIONS FROM COVERAGE

- This Warranty does not cover labor charges or associated costs for, or damages occurring during the removal, transportation, return or installation of Products or replacement Products.
- This Warranty does not cover damage or defects due to normal wear and tear, misuse, abuse, hard water, improper storage, improper handling, improper maintenance**, improper installation*** or uses other than normal household usage****.
- This warranty is non-transferable.
- Products sold to customers for use as display items are not meant for resale and are not covered under any functional or finish warranty.

LIMITATIONS ON REMEDIES

In no event will Brasstech, Inc. be liable for incidental or consequential damages (such as labor charges), whether based on breach of express or implied warranty, breach of contract, negligence, strict liability or any other legal theory. Some states do not allow the exclusion or limitation of incidental or consequential damages, so, the above limitation or exclusion

may not apply to you. Any implied warranties, including the implied warranties of merchantability and fitness for a particular purpose, are limited to the duration of this written warranty. Some states do not allow limitations on how long an implied warranty may last, so the above limitation may not apply to you.

WARRANTY SERVICE

To obtain service under this Warranty, please contact your Product dealer. If you are unable to locate your dealer, please call 949-417-5207 or access the Brasstech, Inc. website at www.brasstech.com. Proof of purchase, such as the original receipt, is required for the dealer to issue credit to the consumer. The dealer must be an authorized dealer and the product must be purchased in the original manufacturer's packaging (display items excluded).

STATE REMEDIES

This Warranty gives you specific legal rights, and you may have other rights which vary from state to state.

PRODUCT CARE

Simple care is all that is needed in maintaining this product. Abrasive cleansers, detergents and silver or brass polish may result in damage to the finish and therefore should not be used. To clean, simply wipe with a soft, water dampened cloth. GINGER® hand, deck and wall shower sprays feature easy-cleaning jets. The jets should be cleaned periodically by rubbing your thumb or a damp cloth across the jets to loosen mineral deposits. Run the shower spray briefly to purge the loosened deposits.

* UNCOATED AND LIVING FINISHES

Uncoated and Living finishes such as Polished Brass Uncoated (03N) and living finishes such as Weathered Copper (08W), do naturally weather and change color over time. Living and uncoated finishes are not warranted.

** MAINTENANCE

Proper maintenance is required to preserve all finishes. Do not use any abrasive cleaners, alcohol, ammonia, detergents, or brass or silver polish on the Products. For complete care requirements and recommendations, please visit our website at www.brasstech.com.

*** PROPER INSTALLATION

Products must be installed in accordance with the manufacturer's installation instructions supplied with the Products. For example, pipes must be flushed before faucet installations, because solder and other debris may damage ceramic discs. You may also call 949-417-5207 for copies of the installation instructions. Many of our installation instructions are also available on our website, www.brasstech.com.

**** COMMERCIAL PURCHASERS

Brasstech, Inc. extends the above limited warranty to purchasers of Products for industrial, commercial and business use upon the same terms and conditions and exclusions applicable to residential purchasers, except that the finish and functionality warranty periods are reduced to a period of one (1) year from the date of purchase. ADDITIONALLY, with respect to commercial purchasers, all implied warranties, including the implied warranties of merchantability and fitness for a particular purpose are excluded and disclaimed. Products purchased for use on the exterior of a home shall be considered commercial products for the purpose of warranty coverage.