

# NEWPORT BRASS®

*Flawless Beauty. From Faucet to Finish.™*

## Installation Instructions

Rough-In Kit for Exposed Tub Sets

Valve Body No. 1-469

Trim Kit for Model No's when use Floor Mount Kit 1-469 with: 1400-4262, 1400-4263,  
1500-4262, 1500-4263

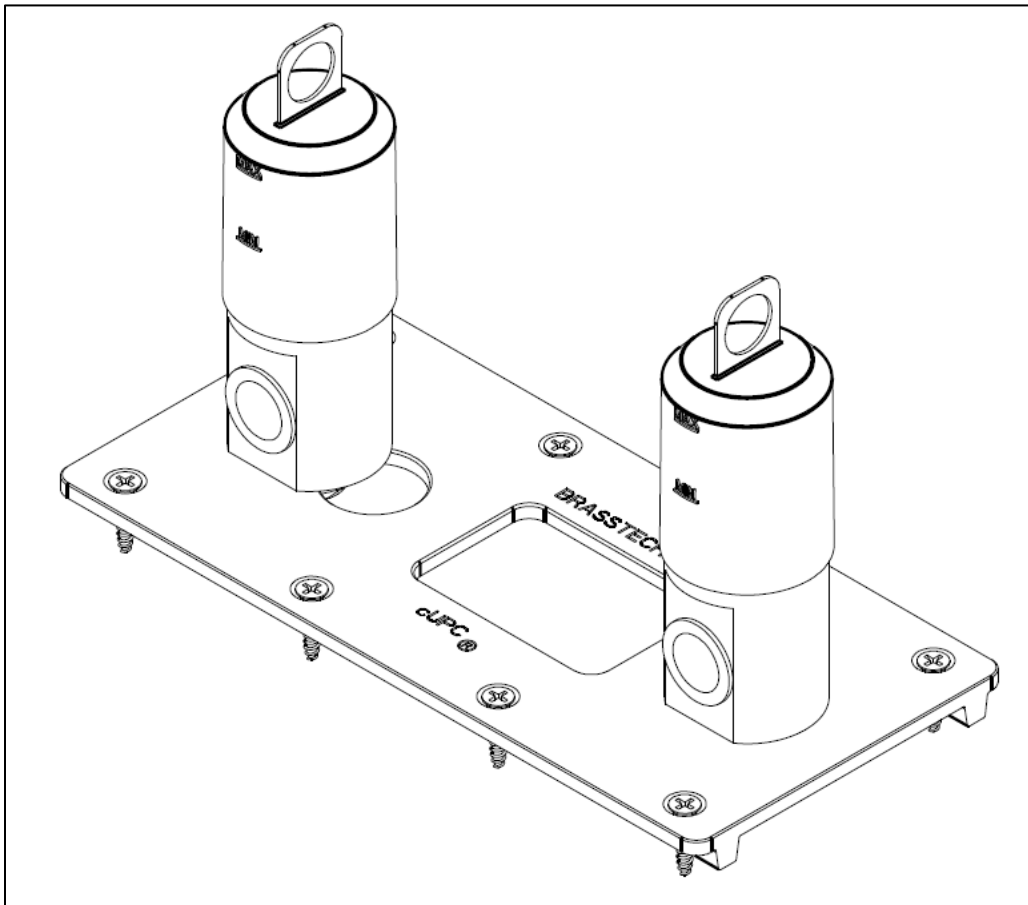

**Congratulations on the purchase of this Newport Brass product, an excellent choice, that will give you years of quality service and enhance the look and style of your home.**

# Recommended Installation by a Professional Plumbing Contractor

## Important Notes (please read before installing)

- Recommended water pressure: 45 to 80 psi
- Product is designed to allow for installation in accordance with all national and local plumbing and building codes.
- During floor mounting of this product, extra care should be taken while drilling into the floor to avoid damaging any water supply lines that may exist beneath the floor.
- **NOTE:** Use plumbers tape or equivalent to seal all threaded joints.
- **WARNING:** To prevent severe damage to valve body, any solder/braze process must be performed a min. of 4" from ports.

## Rough for Floor Mount Kit Exposed Tub Sets

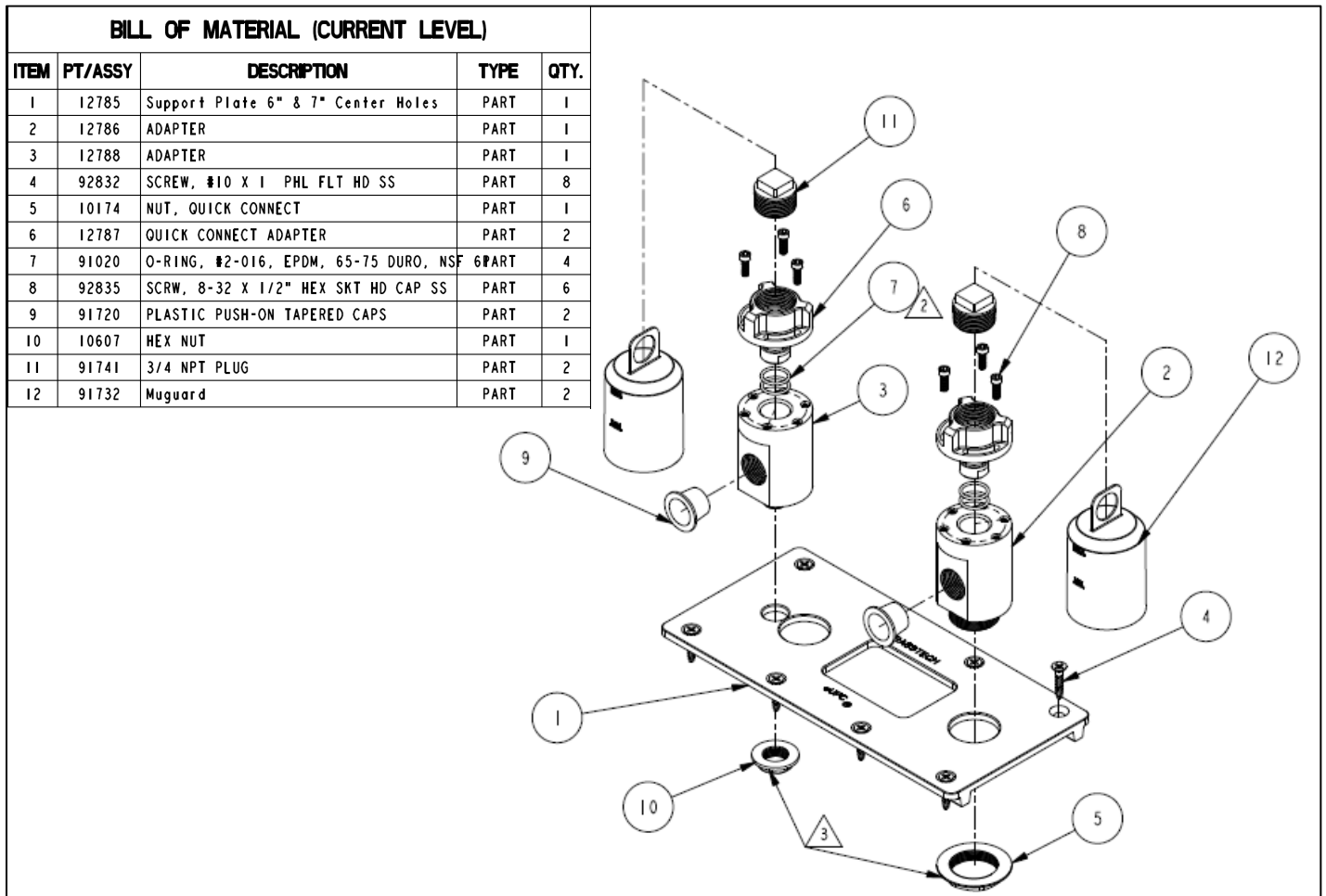

**Figure 1: Product Exploded View**

## Installation Instruction for Wood Joist Support Floor

1. Use a 2" X 8" wood beam to construct a CROSS SUPPORT BRACE as shown in **Figure 2**. Position the CROSS SUPPORT BRACE so its top surface is approximately 4-1/4" from the FINISHED FLOOR. Check the horizontal level by placing a level across the top surface of the CROSS SUPPORT BRACE.
2. Orient the Inlet Fittings of the Rough-In to the water supply source. Use the provided WOOD SCREWS (8X) to attach the Rough-In to the CROSS SUPPORT BRASS.
3. Remove PLUGS from inlets of the Rough-In. Utilize appropriate supply line and 1/2" male thread adapter to connect supply line to the 1/2" NPT inlets of the Rough.
4. Turn on water supply and check for leaks.
5. Installation for the Rough-In Kit is now completed.

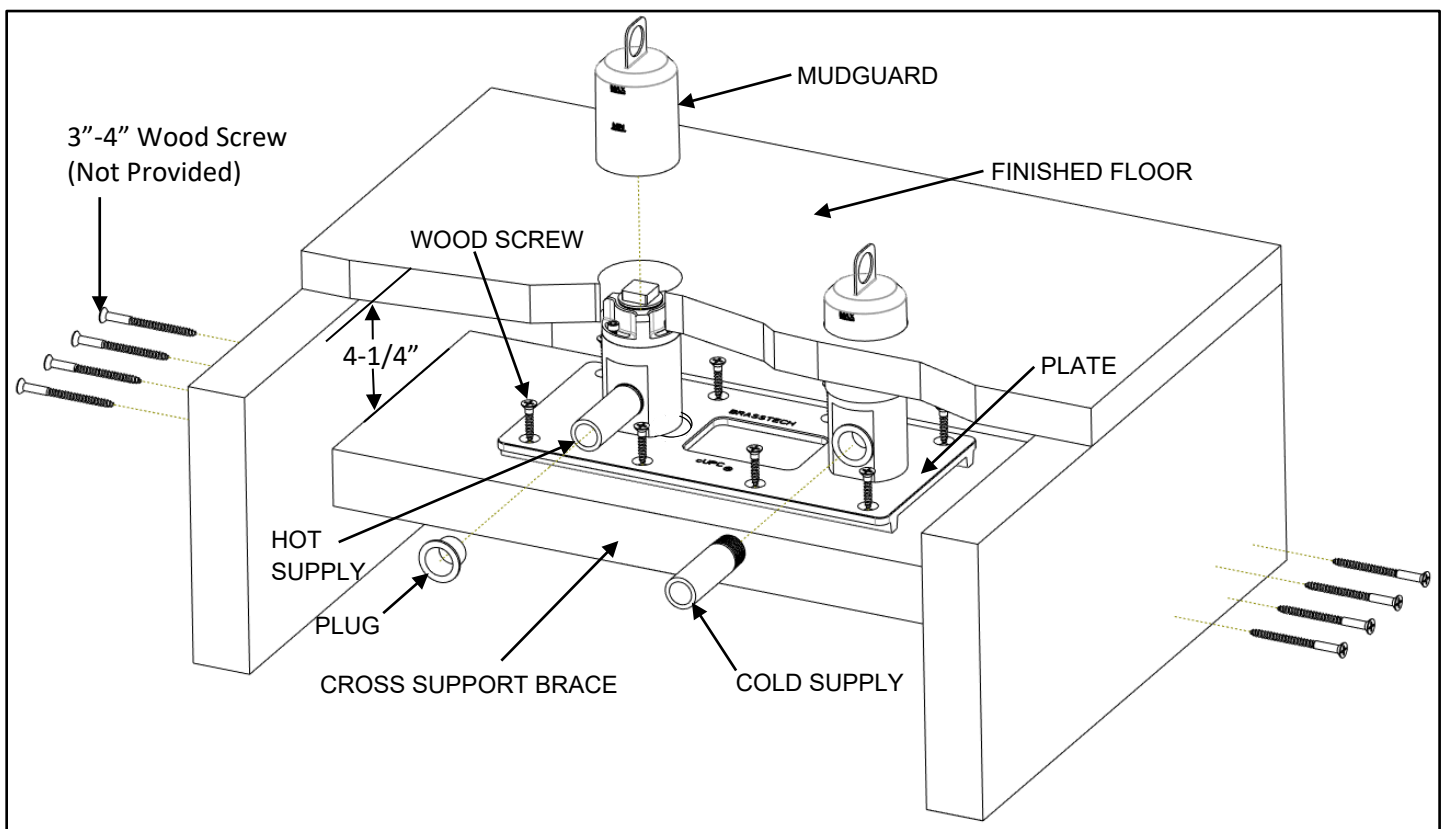

**Figure 2: Wood Joist Support Floor Installation**

## Installation Instruction for Concrete Floor

1. As shown in **Figure 3**, position the rough so that the top surface of PLATE is approximately 3-3/4" from the FINISHED FLOOR
2. Check the horizontal level of the rough by placing a level across the PLATE. Orient the Inlet Fittings of the Rough to the water supply source.
3. Remove PLUGS from Inlets of the Rough. Utilize appropriate supply line and 1/2" male thread adapters to connect supply line to the 1/2" NPT inlets of the Rough.
4. Turn on water supply and check for leaks.
5. Pour concrete and complete the FINISHED FLOOR. Note: Use MUDGUARD to prevent floor material from covering the OUTLET of Rough.
6. Installation for the Rough-In Kit is now completed.

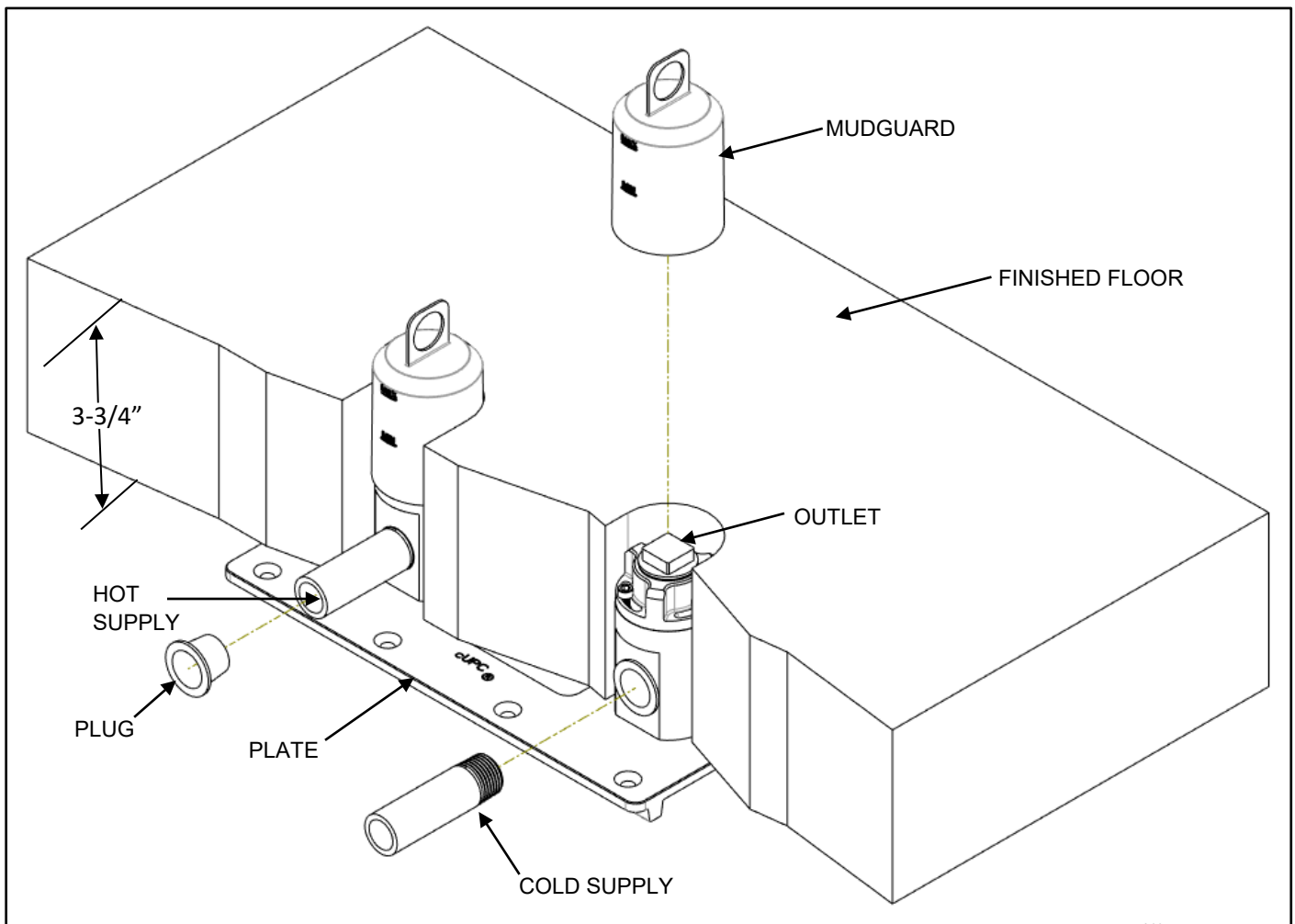

**Figure 3: Concrete Floor Installation**