

INSTALLATION INSTRUCTIONS
ECCENTRIC NIPPLE FOR WALL MOUNT TUB FILLER
MODEL NO. I-483

NEWPORT BRASS®

Flawless Beauty. From Faucet to Finish.™

We Recommend Installation by a Professional Plumbing Contractor

Note: Use plumbers tape or equivalent to seal all threaded port joints. Recommended hole 2@ Ø1-3/8" and 7" apart - center to center.

1. Place two 1/2" NPT ELBOW (1), not included, 7" apart (center to center). Use the two lines on the TEST PLUGS (2) to determine the depth of the ELBOWS (1). The finished wall must fall between the two lines on the TEST PLUGS (2). See **Figure 1**.
2. Remove the TEST PLUGS (2) and adjust the eccentric NIPPLES (3) so they are leveled, mirrored to one another, by using the provided template (4). See **Figure 2**.
3. Place the TEST PLUGS (2) back on and check for leaks. See **Figure 3**.

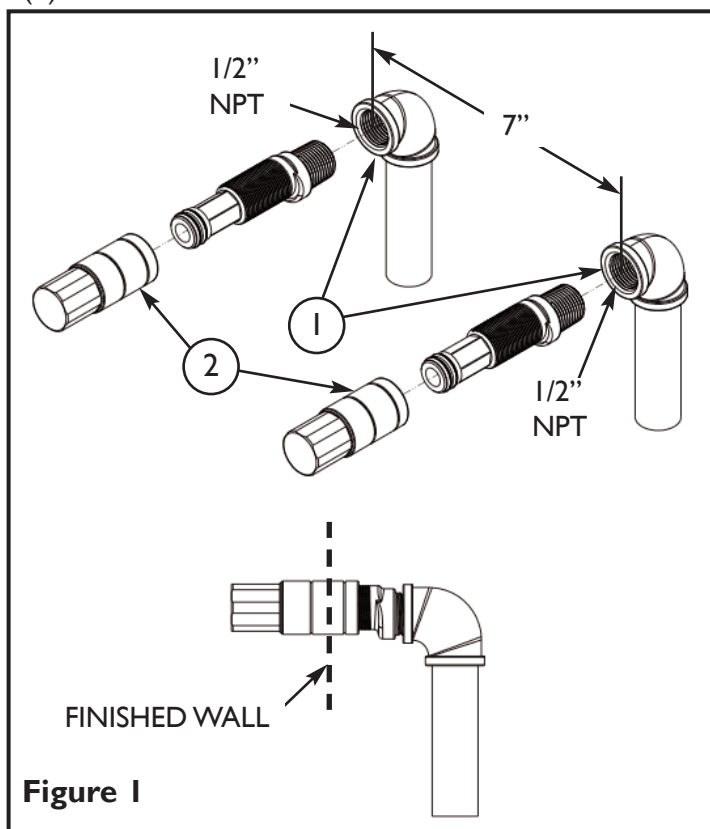

Figure 1

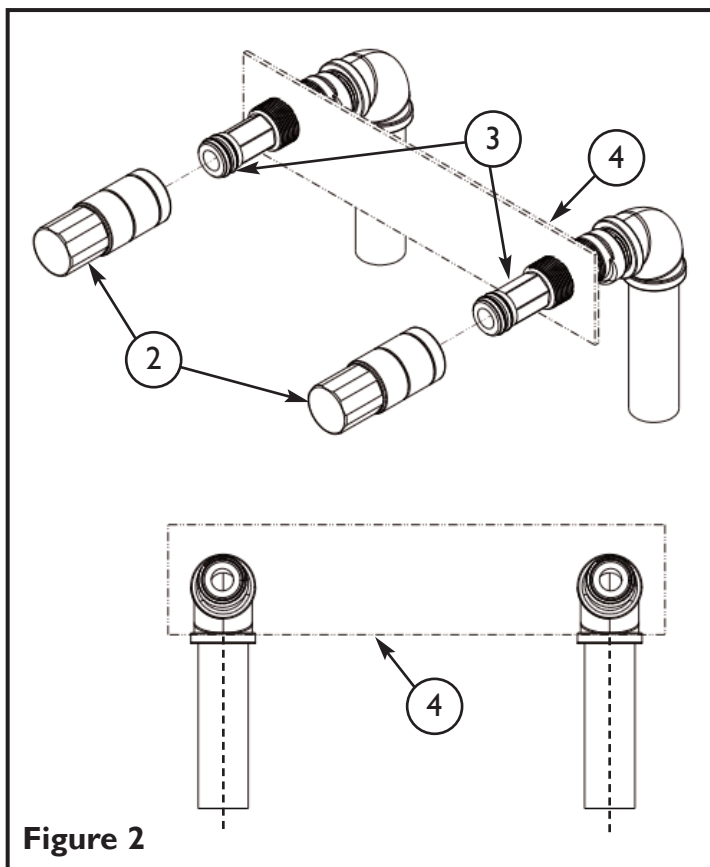

Figure 2

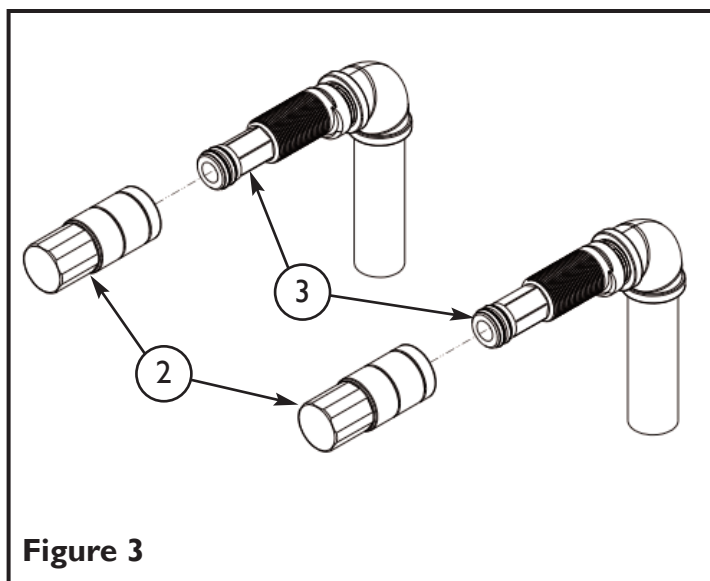

Figure 3