

Installation Instructions

Open Towel Ring, Single Garment Hook, Double Garment Hook, Single Post & Reserve Tissue Holder

Model No. 30-10, 30-12, 30-13, 30-27, 30-30

NEWPORT BRASS

Flawless Beauty. From Faucet to Finish.™

Recommended Installation by a Professional Contractor

1. Hold the BASE (1) up to desired location and mark the hole locations on flange. (See Fig. 1)

2. Drill holes in wall at points marked using the appropriate drill size:

- Wood Screw (#6 x 2") - use: 3/32" Drill
- Toggle Screw (6-32 x 3") - use: 3/8" Drill

3. Fasten BASE (1) to wall using either WOOD/TOGGLE SCREWS (2). (See Fig. 1)

4. Thread ADAPTER (3) onto BASE (1). Insert POST (4) into ADAPTER (3). Position POST (4) Height to 2 5/16" from mounting surface and secure in place by tightening the SETSCREW (5). (See Fig. 2)

5. Place NUT (6), BONNET (7), and ESCUTCHEON (8) over wall mounted POST (4). (See Fig. 3).

5a. Open Towel Ring: Slide END POST (9) onto POST (4) and secure into place with SETSCREW (5). (See Fig. 4)

5b. Single/Double Garment Hook: Slide END POST (9) onto POST (4) and secure into place with SETSCREW (5). (See Fig. 5)

5c. Single Post Tissue Holder: Slide END POST (9) onto POST (4) and secure into place with SETSCREW (5). (See Fig. 6)

5d. Reserve Tissue Holder: Slide END POST (9) onto POST (4) and secure into place with SETSCREW (5). (See Fig. 7)

6. If needed, adjust BASE position to achieve correct alignment of accessory.

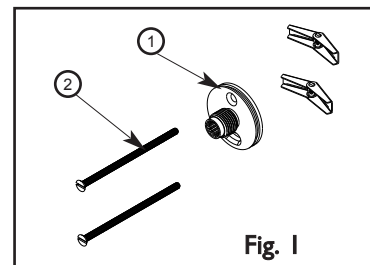

Fig. 1

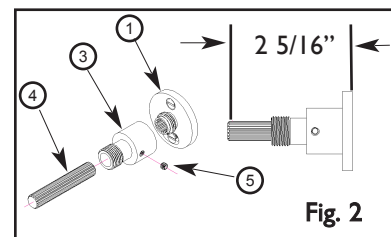

Fig. 2

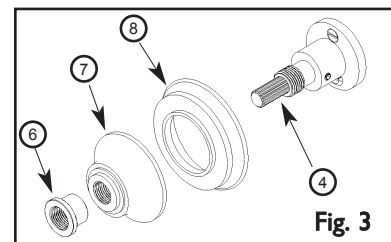

Fig. 3

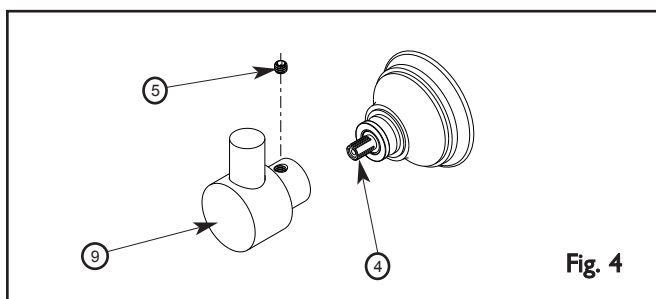

Fig. 4

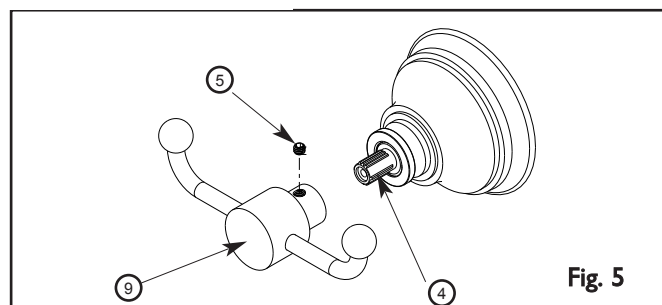

Fig. 5

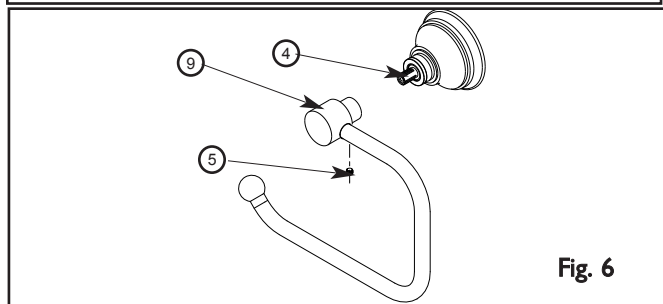

Fig. 6

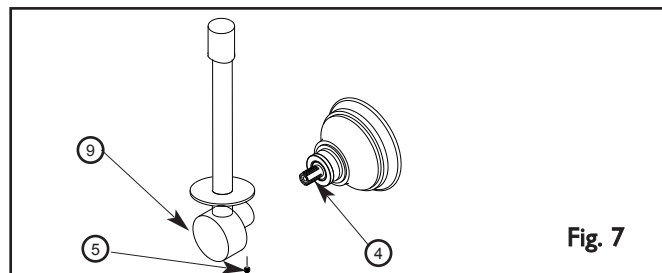

Fig. 7