

ASTOR
INSTALLATION
INSTRUCTION
FOR
503L
BASKET

*Complement
your purchase
with these
fine accessories
also from*
NEWPORT BRASS®

*Towel Bars
Towel Rings
Toilet Tissue Holders
Hooks
Soap Dishes
Tumbler Holders
Toiletry Shelves Grab
Bars
Mirrors
Lights
Bud Vases
Hotel Shelves
Shower Curtain Rods
Soap & Bottle Baskets
Cabinet Hardware*

2001 CARNEGIE AVE, SANTA ANA CA
92705 (949) 417-5207
WWW.NEWPORTBRASS.COM

INSTALLATION INSTRUCTIONS

NEWPORT BRASS

®

ASTOR

FOR
NEWPORT BRASS
503L
BASKET

To Prevent loss of small
Parts, cover drain before
Beginning.

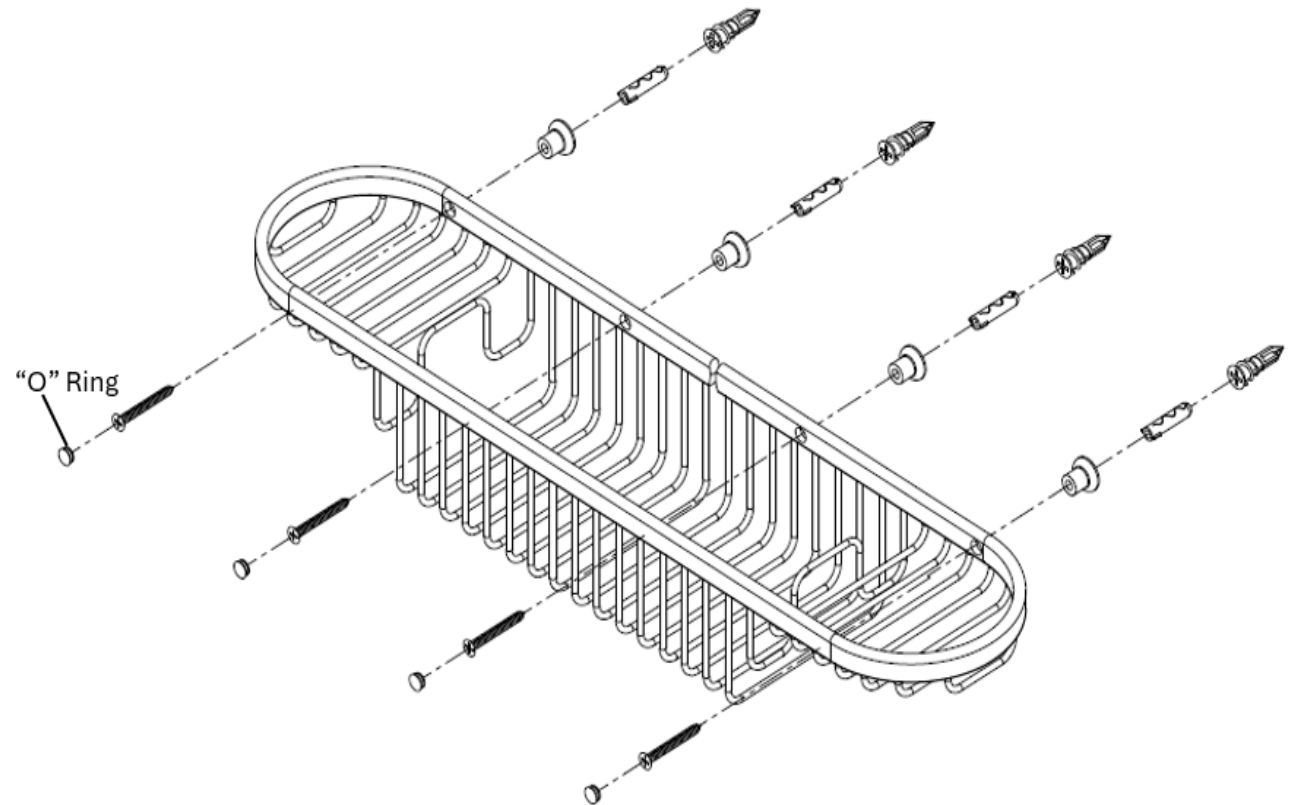

- 1. Position the basket on the wall and mark the location of the mounting screws.
- 2. To mount on Tile, Drill 1/4" (6mm) holes on the marks.
To mount on Drywall, Drill 3/16" (5mm) holes on the marks.
- 3. Push the plastic wall anchors into the holes until the flanges contact the wall.
- 4. Insert the mounting screws through the basket frame and posts and tighten into wall anchors.
- 5. Place "O" Ring on screw cover then Insert screw covers. Wetting the black rubber "O" Ring Will make insertion easier.