

INSTALLATION INSTRUCTIONS
PULL DOWN KITCHEN FAUCET
MODEL No: 8200-5103, 8200-5113

NEWPORT
365

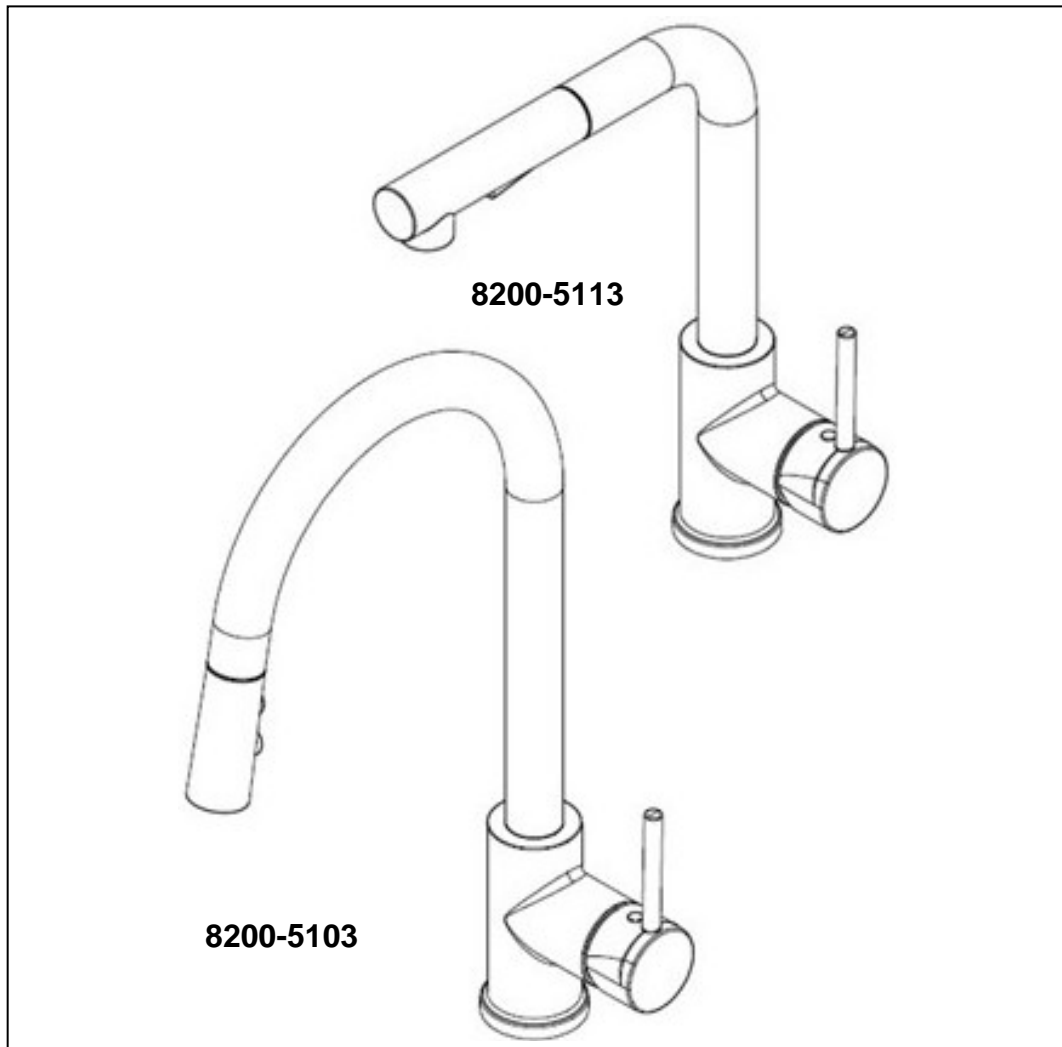

Congratulations on the purchase of your Newport product, an excellent choice, that will give you years of quality service and enhance the look and style of your home.

Recommended Installation by a Professional Plumbing Contractor

Note: The use of petroleum base plumbers putty on our products will nullify the warranty. We recommend the use of clear silicone sealing materials.

1. Drill hole in mounting surface. Recommended deck hole $\text{\O}1.350''$ not to exceed $\text{\O}1.562''$.
2. Insert Hoses through base O-RING (1) and hole in mounting surface. Secure into place with MOUNTING KIT (3). **See Figure 1.**
3. Attach hot/cold water supply directly to valves in the wall. **See Fig. 2**
4. **DO NOT** remove the HOSE (6) from SPOUT (4). **See Figure 3.**
5. Attach WEIGHT (8) to HOSE (6) in the appropriate area shown, on the upward swing toward the SPRAYHEAD (5), in order to provide proper pull to hose. **See Figure 4.**
6. Connect HOSE (6) to valve OUTLET (7). Note: The two tabs of HOSE (6) fitting must properly line up with the opening of OUTLET (7). **See Figures 4A and 4B.**

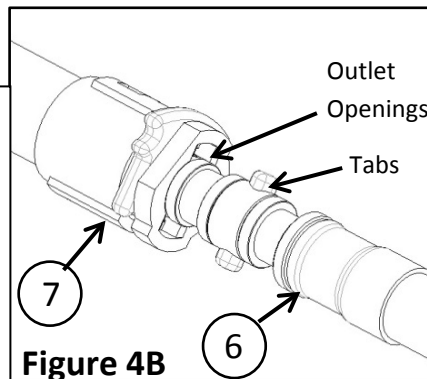
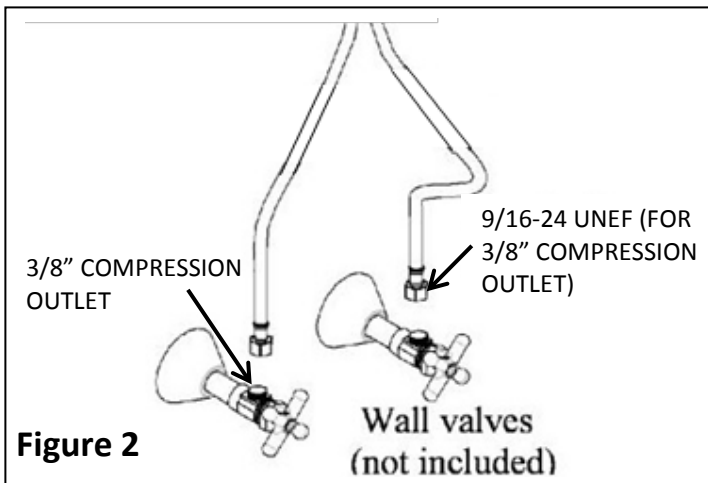
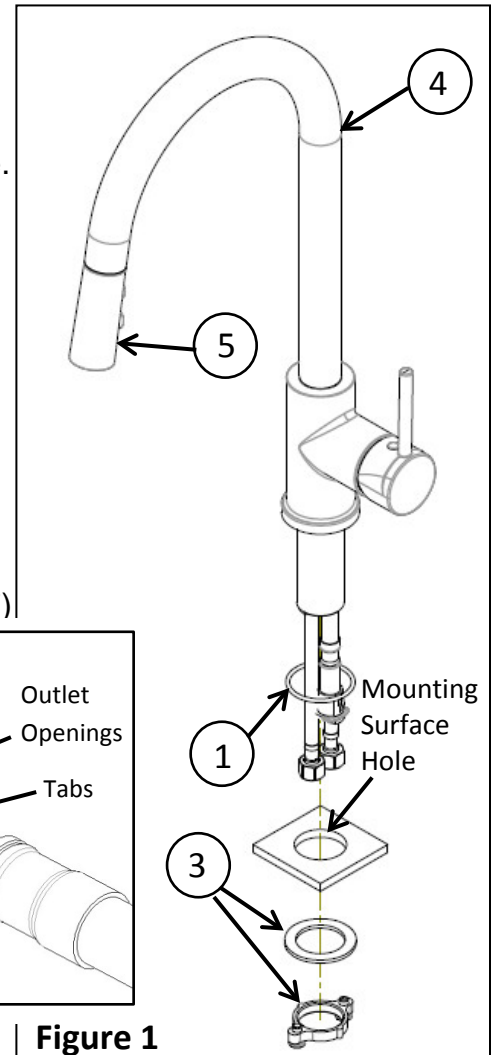

Figure 4B

Figure 1

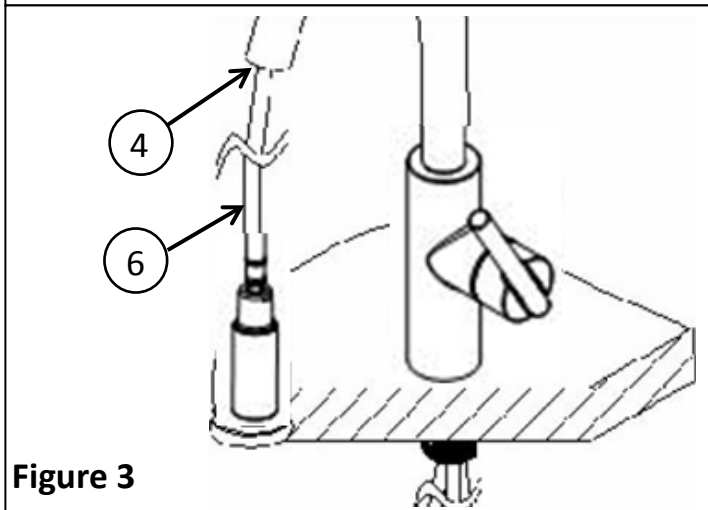

Figure 3

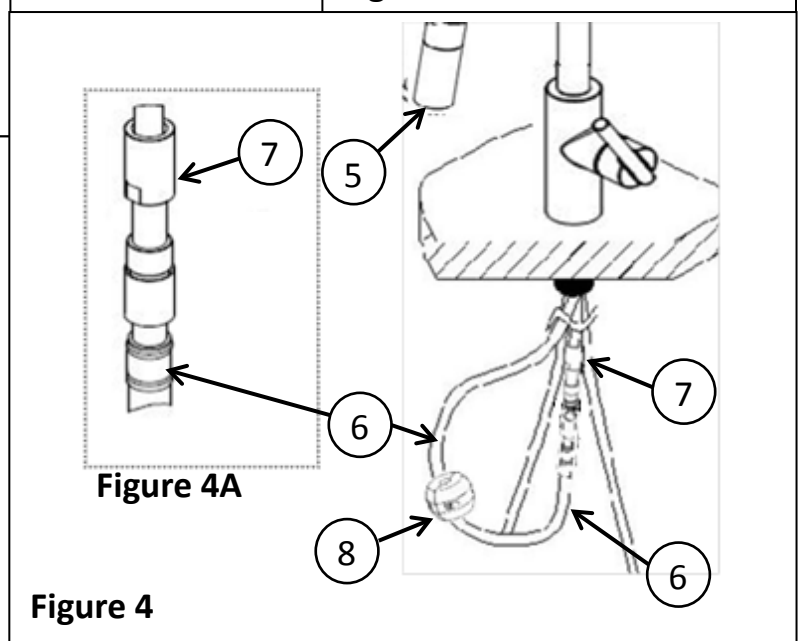

Figure 4A

Figure 4

7. With faucet in the OFF position, open water supply valves. Inspect connections under sink for leaks.

DO NOT turn faucet on yet.

8. Pull SPRAYHEAD (5) out from SPOUT (4). While holding HOSE (6), detach SPRAYHEAD (5). Aiming HOSE (6) into sink, turn on faucet to center position (mixed) and flush for one minute to remove debris from lines.

9. Turn OFF faucet and reattach SPRAYHEAD (5) to HOSE (6).
See Figure 5.

10. Turn on faucet and check the SPRAYHEAD (5) by operating the trigger from aerator to spray.

