

**INSTALLATION INSTRUCTIONS
KITCHEN BRIDGE FAUCET
WITH SIDE SPRAY
Model No's: 9452-1**

NEWPORT BRASS
Flawless Beauty. From Faucet to Finish.™

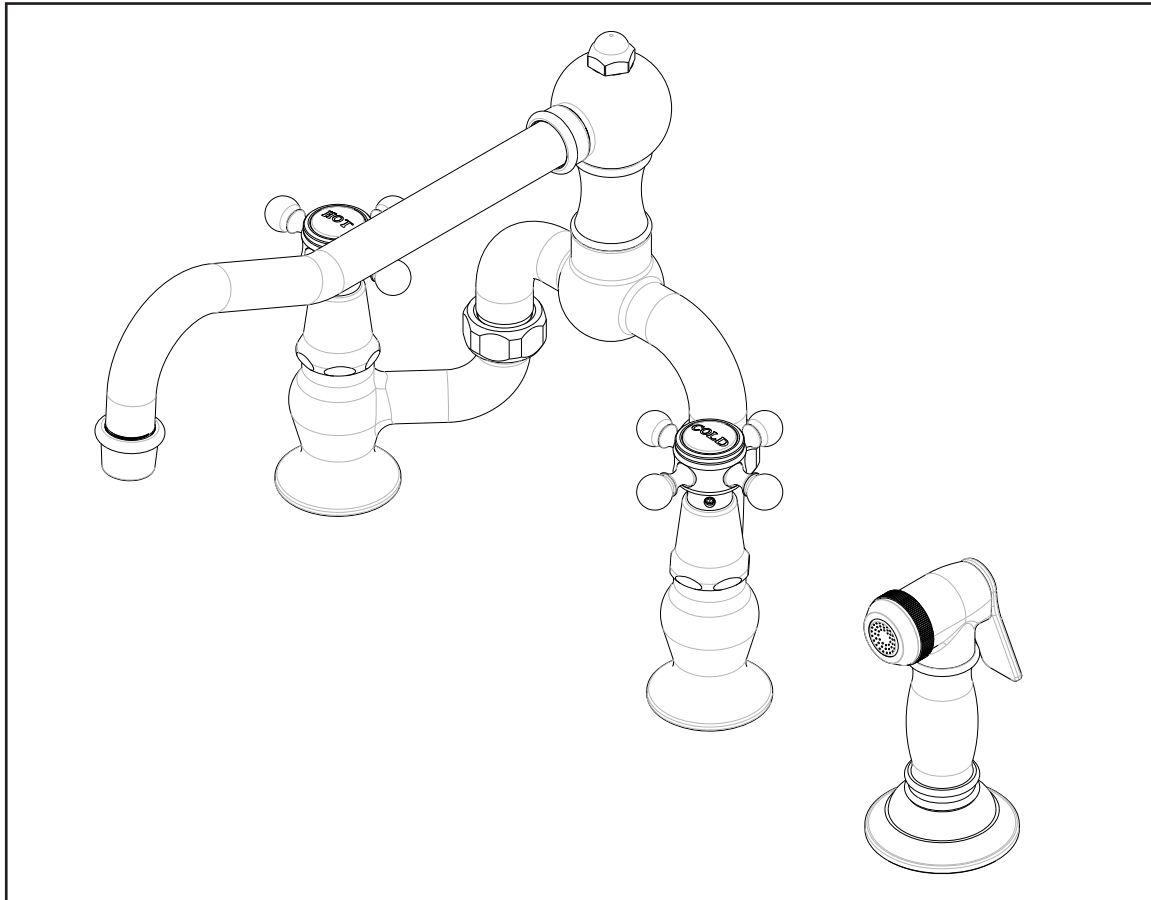

**Congratulations on the purchase
of this Newport Brass product,
an excellent choice, that will give you
years of quality service and enhance
the look and style of your home.**

Adjust Handle Alignment:

1. In **Figure 5**, ensure cartridges in full closed position and check **HANDLE** alignment. If the **HANDLE** is not correctly aligned, temporary remove the **HANDLE**, loosen up (but do not completely remove) the **ADAPTER SCREW** and rotate **CARTRIDGE ADAPTER** one tooth clockwise (18 degrees), reassemble the **HANDLE** and recheck alignment. Repeat until the **HANDLE** is aligned.
2. Remove the **HANDLE** and tighten the **ADAPTER SCREW** to firmly secure the **CARTRIDGE ADAPTER** to cartridge. Reattach the **HANDLE** to the **CARTRIDGE ADAPTER** and secure the **HANDLE** in place with set screw(s).

Note: When reattaching the **HANDLE**, assure a small gap between **HANDLE** and **BONNET** to prevent from metal-to-metal contact.

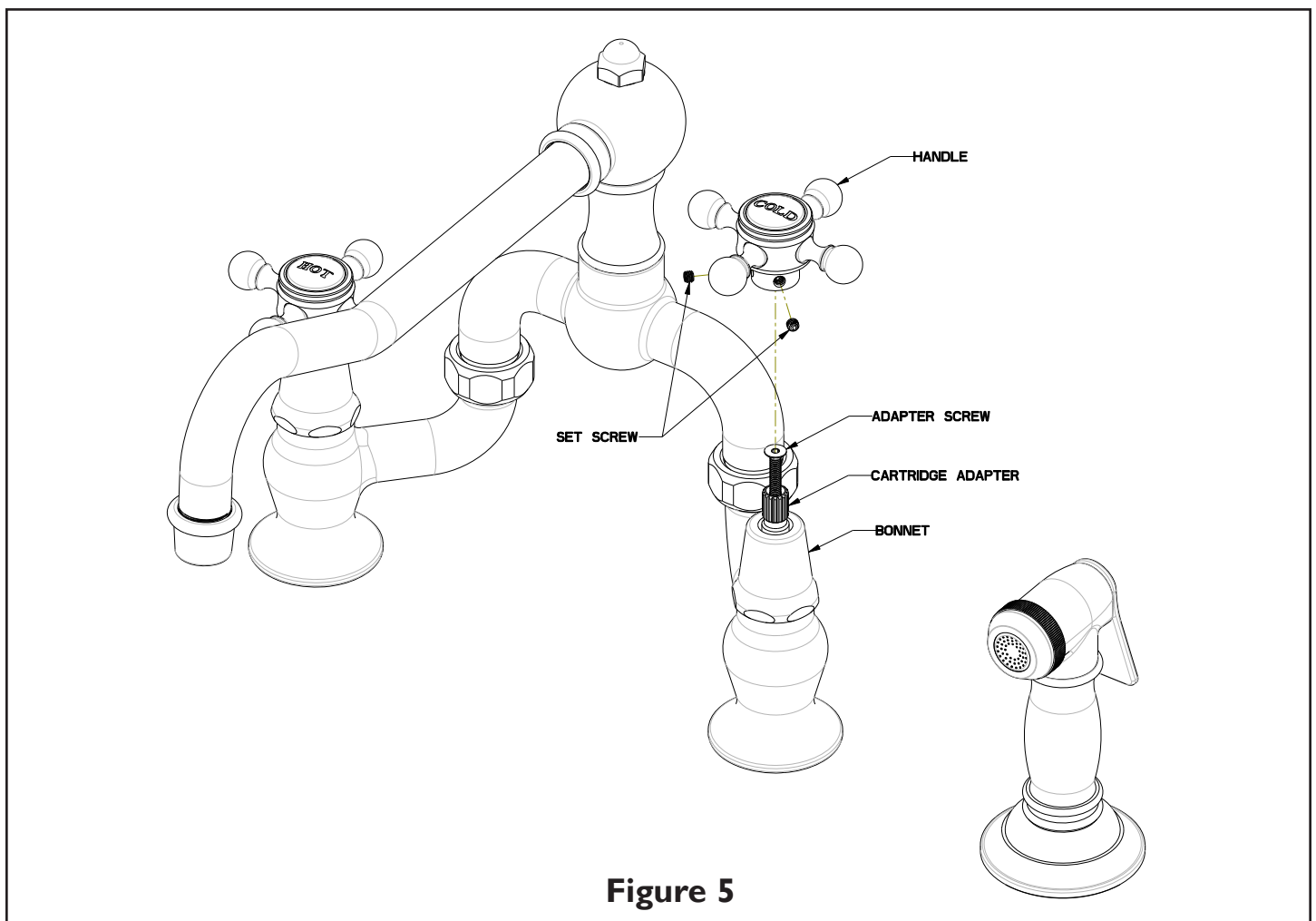

Figure 5