

EAST SQUARE

Features

Brass Construction  
Euro-motion ceramic disc 40 mm valve cartridge  
9.25 gallons (35 liters) per minute spout maximum flow rate  
3/4" braided hot and cold supply lines (with 1/2" adapters)  
36.53" (92.7 cm) tub spout height at outlet  
10.05" (25.5 cm) tub spout reach (center-center)  
Contemporary handshower design of resin construction  
Floor mounting bracket with integral base and escutcheon  
ADA Compliant (Handles Only)  
1.8 GPM (6.8 LPM) Max, Handshower Only

Codes / Standards Compliance

Meets or exceeds the following at date of manufacture:

ASME A112.18.1/CSA B125.1  
IAPMO/cUPC  
IPC  
ADA & ICC/ANSI A117.1 (Handle Only)  
Energy Policy Act of 1992  
EPA WaterSense  
California Energy Commission  
ASME A112.18.3 (Back Flow)  
All applicable US Federal and State material regulations

Tub and Handshower Set

1400-4261

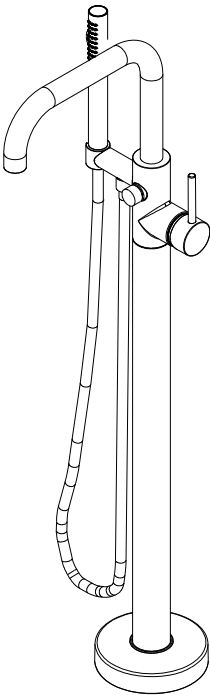

ACCESSORY OPTIONAL	
System Element	1-339
Description	Freestanding Tub Fill Rough Kit
Image	A line drawing of the Freestanding Tub Fill Rough Kit, which is a cylindrical metal component with a flange at the bottom and a small handle or lever on the side.

# 1400-4261

## PRODUCT DIMENSIONS *(Units are in inches)*

Product Dimensions are provided for reference only. For specific product installation guidelines, please reference the Installation Instructions of the product being installed.

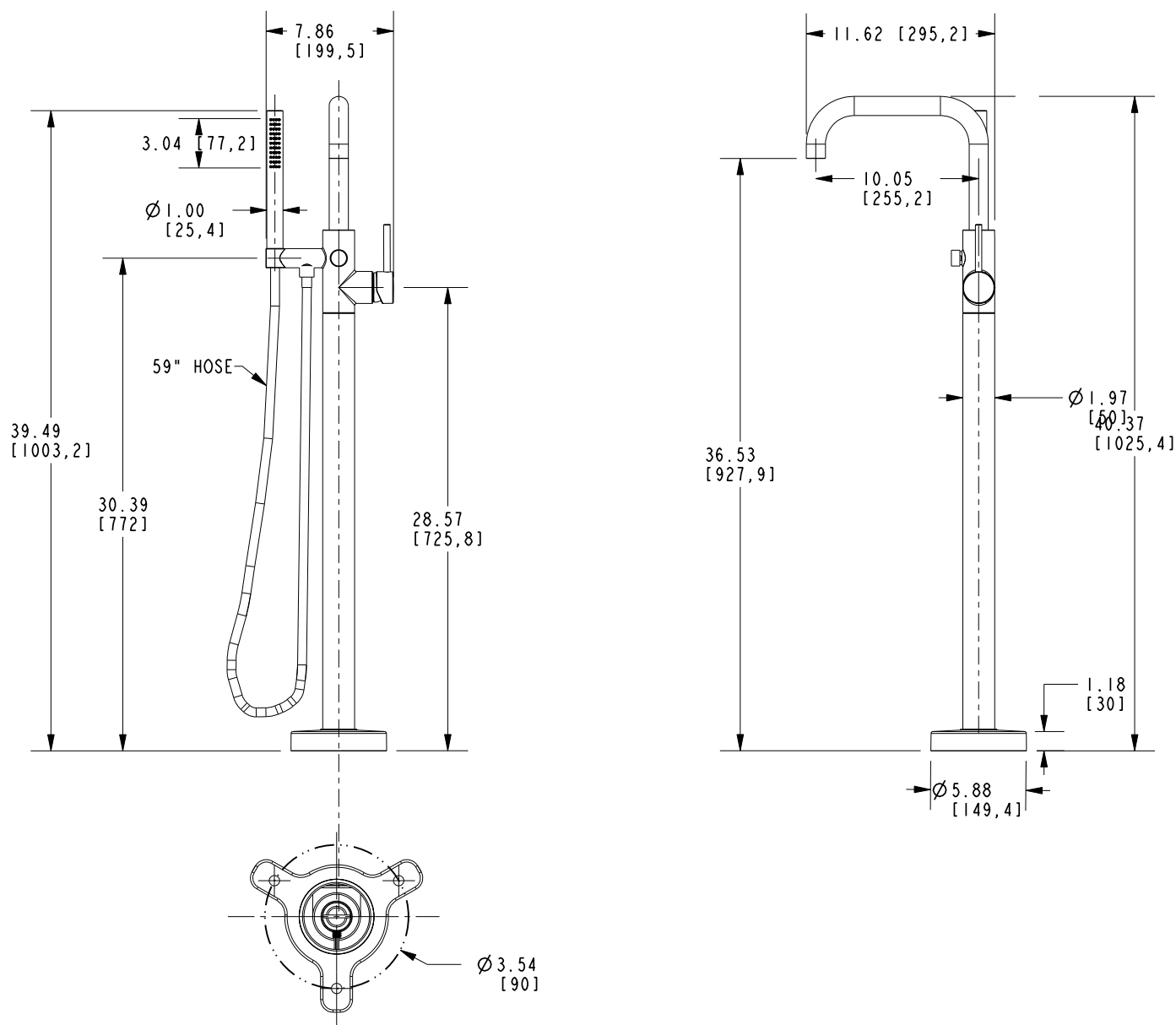

Tub and Handshower Set

1400-4261

Page 2 of 2

EN- 5008

REV E

**NEWPORT BRASS**  
Flawless Beauty. From Faucet to Finish.

t: 949.417.5207 | [www.newportbrass.com](http://www.newportbrass.com)  
©2025 NewportBrass