

Features

- Solid brass construction
- 2-hole face plate
- Lift & Turn Bath Plug
- Maximum make-up distance is 22"
- All Parts Polished For Use With Tubs On Legs

Tub & Shower Waste & Overflow

257



Codes / Standards Compliance

Meets or exceeds the following at date of manufacture:

- ASME A112.18.2/CSA B125.2
- 2IAMPO/cUPC
- IPC
- All applicable US Federal and State material regulations

Colors / Finishes

- 10B: Oil Rubbed Bronze
- 15: Polished Nickel
- 15S: Satin Nickel - PVD
- 26: Polished Chrome
- Other: Refer to the Newport Brass catalog for additional color/finish options.



Specified Model

Model	Description	Colors Finishes
257	Tub & Shower Waste & Overflow	<input type="checkbox"/> 10B <input type="checkbox"/> 15 <input type="checkbox"/> 15S <input type="checkbox"/> 26 <input type="checkbox"/> Other

Product Specification Add "Color / Finish" suffix to Model number, below.

Lift & turn waste with overflow shall be of solid brass construction. Shall include a 2-hole face plate. Shall include Lift & Turn Bath Plug. Maximum make-up distance shall be 22". All Parts shall be polished for use in an exposed install. Lift & turn waste with overflow shall be Newport Brass Model 257/____.

257

Product Dimensions are provided for reference only. For specific product installation guidelines, please reference the Installation Instructions of the product being installed.

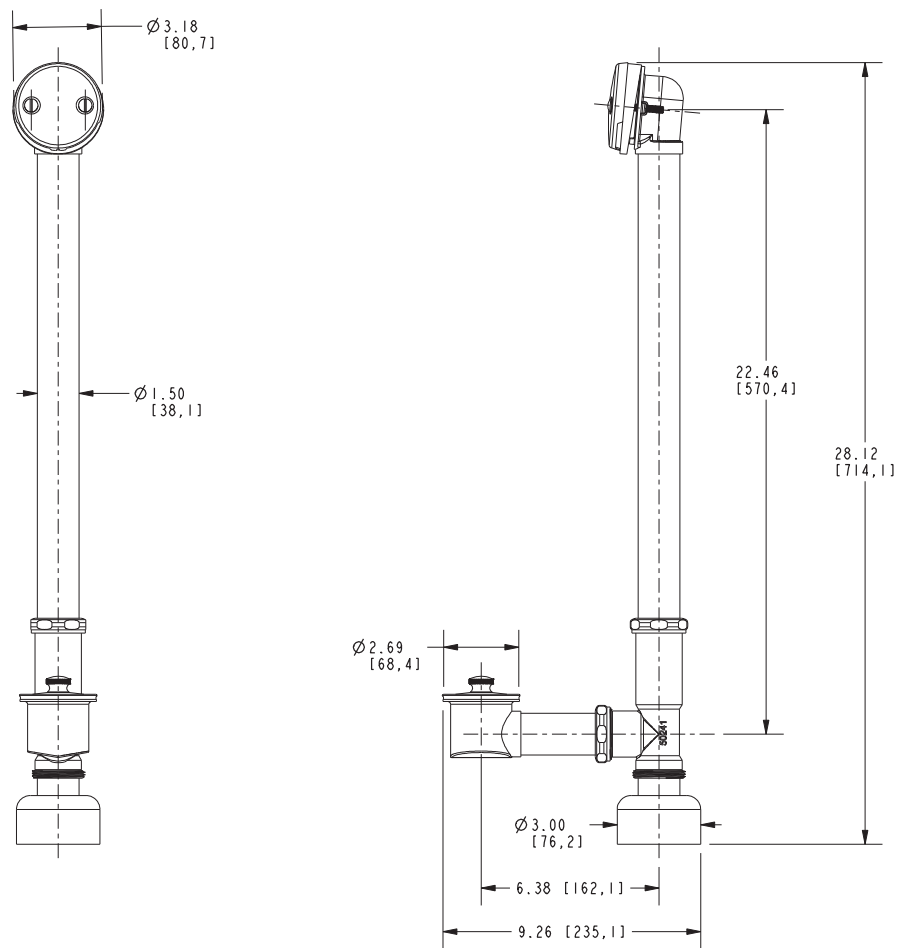

Brasstech Tub & Shower Waste & Overflow 257