

**Features**

- Solid brass construction
- Face plate with ADA compliant traditional cross handle and diverter pull-knob
- ADA compliant traditional cross handle assembly and insert options for control valve
- Intended for use with Newport Brass rough valve(s) as specified (Required Accessory)

**Codes / Standards Compliance**

Meets or exceeds the following at date of manufacture:

- ASME A112.18.1/CSA B125.1
- IAPMO/cUPC
- IPC
- ADA
- ICC/ANSI A117.1
- ASSE 1016
- All applicable US Federal and State material regulations

**Colors / Finishes**

- 10B: Oil Rubbed Bronze
- 15: Polished Nickel
- 15S: Satin Nickel - PVD
- 26: Polished Chrome
- Other: Refer to the Newport Brass catalog for additional color/finish options.

**Tub and Shower Trim  
(Less showerhead, arm & flange)**

**4-1642BP**

Also 3-280A , 3-280B

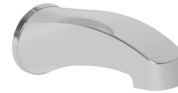

4-1642BP

3-280A

3-280B

**Specified Model**

| Model    | Description  | Colors   Finishes            |                             |                              |                             |                                |
|----------|--|------------------------------|-----------------------------|------------------------------|-----------------------------|--------------------------------|
| 4-1642BP | Tub and Shower Trim (less showerhead, arm & flange)                | <input type="checkbox"/> 10B | <input type="checkbox"/> 15 | <input type="checkbox"/> 15S | <input type="checkbox"/> 26 | <input type="checkbox"/> Other |
| 3-280A   | Shower System Control Valve Trim (Escutcheon/Handle, Arrow Insert) | <input type="checkbox"/> 10B | <input type="checkbox"/> 15 | <input type="checkbox"/> 15S | <input type="checkbox"/> 26 | <input type="checkbox"/> Other |
| 3-280B   | Shower System Control Valve Trim (Escutcheon/Handle, Plain Insert) | <input type="checkbox"/> 10B | <input type="checkbox"/> 15 | <input type="checkbox"/> 15S | <input type="checkbox"/> 26 | <input type="checkbox"/> Other |

**Required Accessory: Trim(s), above, and Rough Valve(s), below, must be specified.**

| Application       | Shower (or Tub) Valve (Choose One) |                                | Control Valve                  |
|-------------------|------------------------------------|--------------------------------|--------------------------------|
|                   | Balance Pressure (BP)              | Balance Pressure (BP)          | Diverter (3/4 Port)            |
| Inlet/Outlet Size | 1/2"                               | 1/2"                           | 1/2"                           |
| Part Number       | <input type="checkbox"/> 1-595     | <input type="checkbox"/> 1-685 | <input type="checkbox"/> 1-617 |
| Image             |                                    |                                |                                |

**Product Specification: Add size designator and "Color / Finish" suffix to Model number, below.**

The single-control Tub and Shower Trim (less showerhead, arm & flange) shall be made of solid brass construction. Tub and Shower Trim (less showerhead, arm & flange) shall include faceplate with ADA compliant handle and diverter pull-knob. Shower System Control Valve Trim(s) (Escutcheon/Handle) shall be ADA compliant when used with specified Shower System Control Valve. Tub and Shower Trim (less showerhead, arm & flange) shall be Newport Brass Model 4-1642BP/\_\_\_\_ and single-control Tub and Shower rough valve shall be Newport Brass Model 1-\_\_\_\_. [Optional Shower System Control Valve Trim (Escutcheon/Handle) shall be 3-280\_\_\_\_/\_\_\_\_ and Shower System Control Valve shall be 1-617].

# 4-1642BP

## PRODUCT DIMENSIONS *(Units are in inches)*

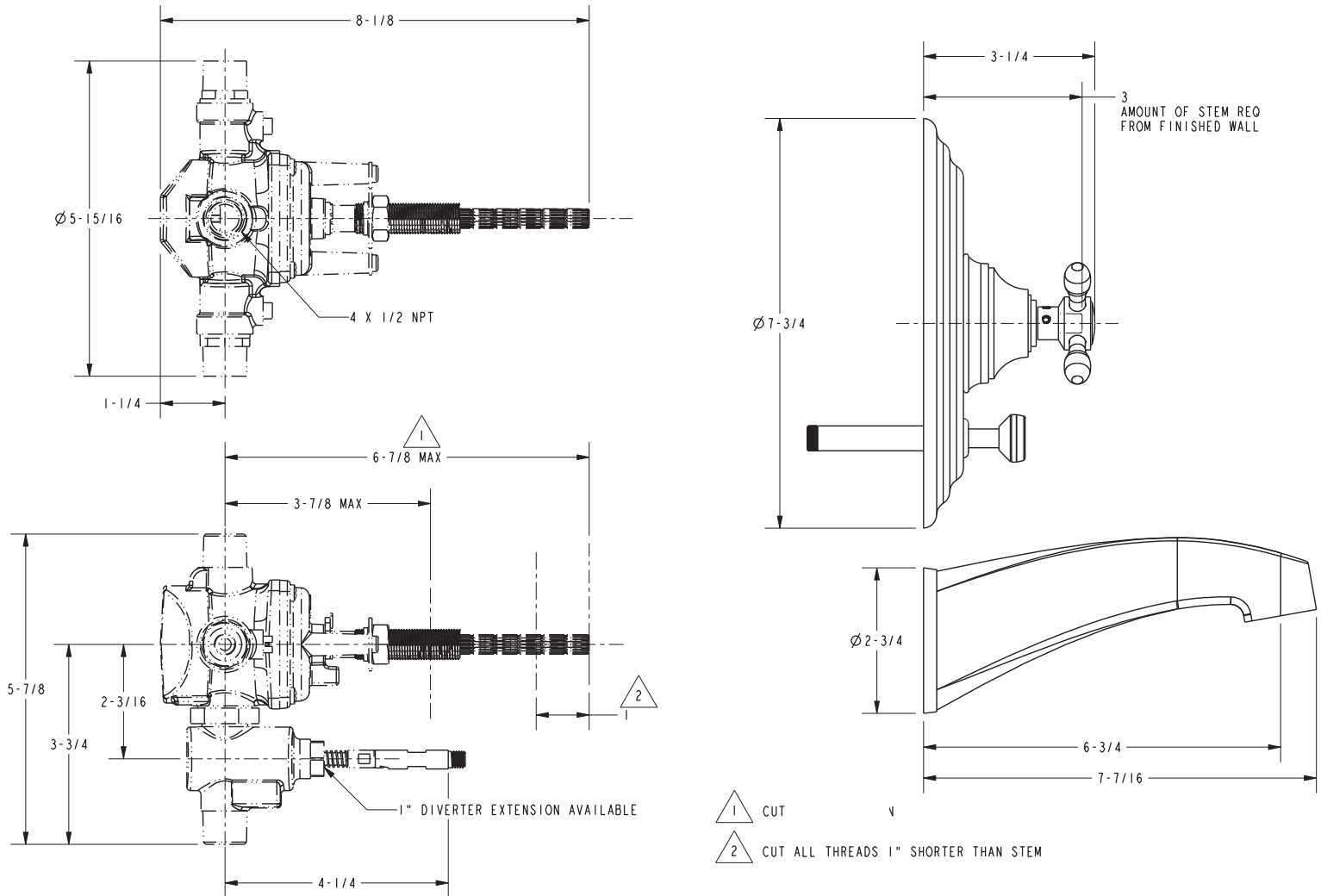

### Astaire Tub and Shower Trim 4-1642BP