

**Features**

- Solid brass construction
- Flange (Brass), with Sure Grip Interface to 3/8" NPT Nipple
- Complements various product series

**Tank & Lavatory Supply Nipple Flange**

**441**

**Codes / Standards Compliance**

Meets or exceeds the following at date of manufacture:

- All applicable US Federal and State material regulations



**Colors / Finishes**

- 10B: Oil Rubbed Bronze
- 15: Polished Nickel
- 15S: Satin Nickel - PVD
- 26: Polished Chrome
- Other: Refer to the Newport Brass catalog for additional color/finish options.

**Specified Model**

Model	Description	Colors   Finishes
441	Tank & Lavatory Supply Nipple Flange	<input type="checkbox"/> 10B <input type="checkbox"/> 15 <input type="checkbox"/> 15S <input type="checkbox"/> 26 <input type="checkbox"/> Other

**Product Specification** Add "Color / Finish" suffix to Model number, below.

The Pipe Flange shall be made of solid brass construction. Flange with Sure Grip Interface shall fit 3/8" NPT Nipple. Flange shall be Newport Brass Model 441/\_\_\_\_\_.

# 441

Product Dimensions are provided for reference only. For specific product installation guidelines, please reference the Installation Instructions of the product being installed.

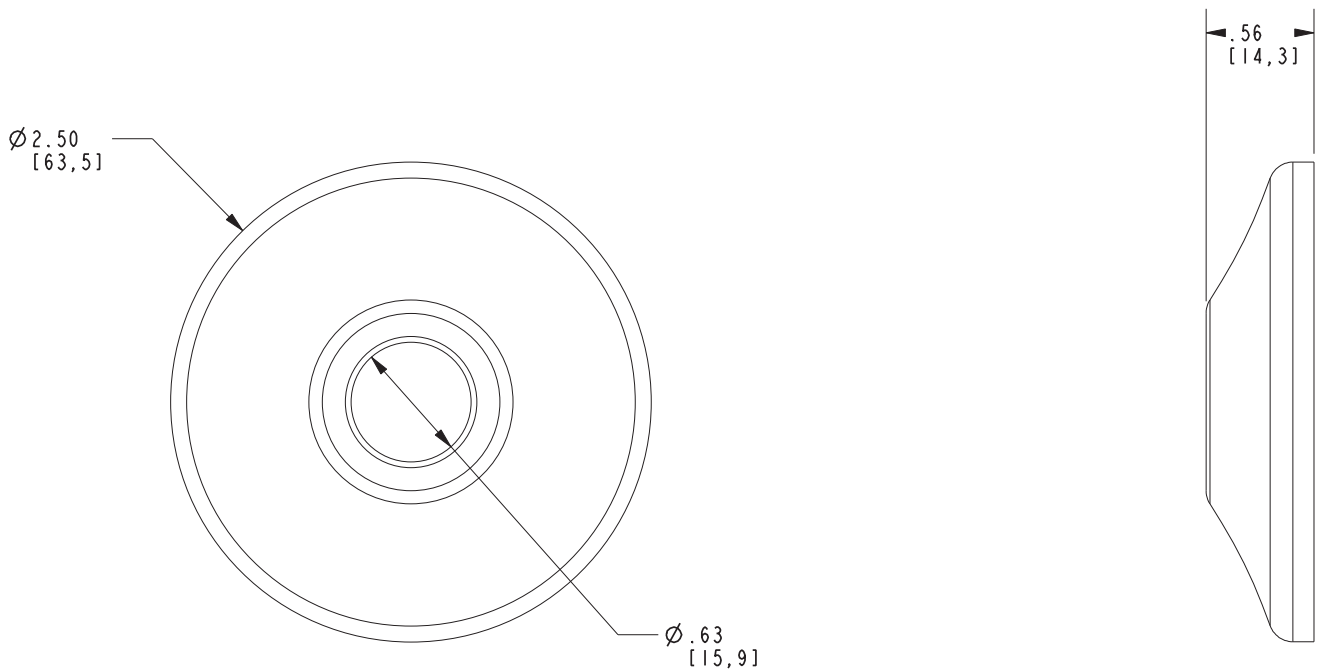

---

**Brasstech Tank & Lavatory Supply Nipple Flange**  
**441**