

FAIRLYNN

Toilet Tissue Holder 80-27

Features

- Solid metal construction
- Single-post, open roller design
- Complements Newport 365 Fairlynn product series



Codes / Standards Compliance

Meets or exceeds the following at date of manufacture:

- All applicable US Federal and State material regulations

Colors / Finishes

- 09: Old World Bronze
- 15: Polished Nickel
- 15S: Satin Nickel - PVD
- 26: Polished Chrome



Specified Model

Model	Description	Colors Finishes
80-27	Toilet Tissue Holder	<input type="checkbox"/> 09 <input type="checkbox"/> 15 <input type="checkbox"/> 15S <input type="checkbox"/> 26

Product Specification Add "Length Indicator and Color / Finish" suffix to Model number, below.

The Toilet Tissue Holder shall be made of solid metal construction and incorporate a single-post, open roller design. Toilet Tissue Holder shall complement Newport 365 Fairlynn product series. Toilet Tissue Holder shall be Newport 365 Model 80-27/_____.

80-27

PRODUCT DIMENSIONS *(Units are in inches)*

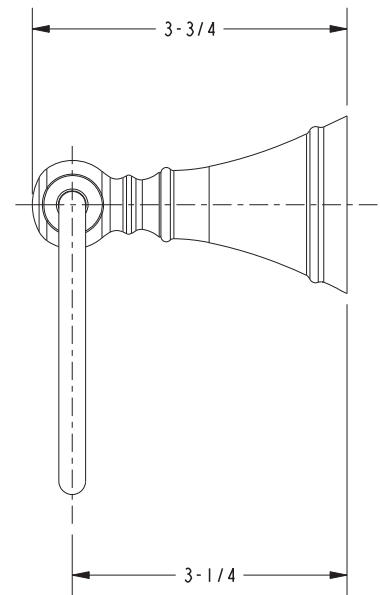
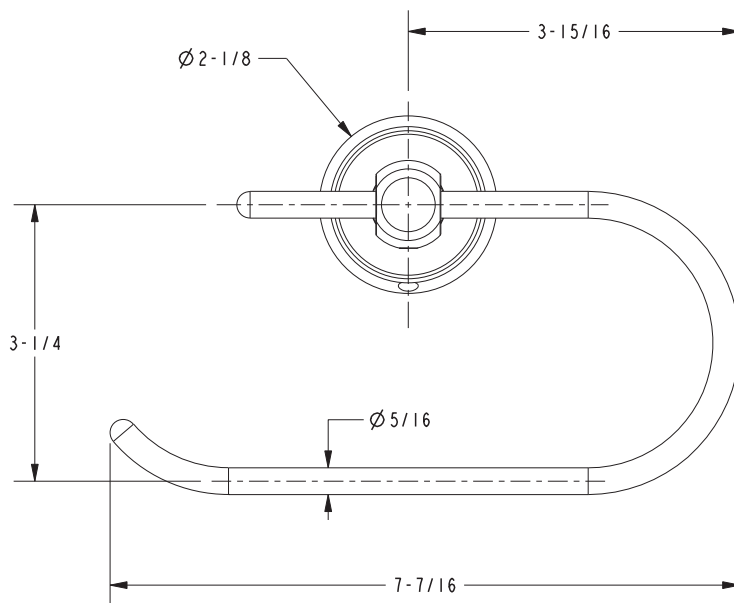

Newport 365 Toilet Tissue Holder 80-27